

## DOCUMENT RESUME

ED 440 597

HE 032 827

TITLE Data Book. Maryland Higher Education Commission.  
 INSTITUTION Maryland State Higher Education Commission, Annapolis.  
 PUB DATE 2000-00-00  
 NOTE 42p.; For 1999 edition, see ED 426 672.  
 AVAILABLE FROM Maryland Higher Education Commission, 16 Francis Street,  
 Annapolis, MD 21401. Tel: 410-974-2971; Web site:  
<http://www.mhec.state.md.us>.  
 PUB TYPE Numerical/Quantitative Data (110)  
 EDRS PRICE MF01/PC02 Plus Postage.  
 DESCRIPTORS Academic Persistence; Career Education; \*College Faculty;  
 \*College Students; Community Colleges; Full Time Faculty;  
 Graduate Study; Graduation; Higher Education; Income; Part  
 Time Faculty; Private Schools; Public Colleges; Racial  
 Factors; Sex Differences; State Universities; Statistical  
 Data; Tables (Data); Tuition; Undergraduate Study  
 IDENTIFIERS \*Maryland

## ABSTRACT

This document summarizes higher education data for the state of Maryland. The first table compares Maryland to national averages for educational achievement, enrollments, campus mix, degrees conferred, average undergraduate tuition, state funding, and average faculty salary. Other tables are grouped by category: (1) Students--students needing remediation and student performance, 1997-98; average freshman Scholastic Assessment Test scores, 1998-99; enrollment, fall 1998: undergraduate, graduate, professional, total, at state-aided independent institutions, and by race and gender; (2) retention and graduation--by race, at four-year institutions; community college graduation and transfer rates, 1994-95; (3) degrees--by institution, by major program, and by race and gender, 1997-98; (4) faculty--full- and part-time, 1998; full-time by race and gender, 1998; and average full-time salary, 1998; (5) revenues and expenditures--community colleges, fiscal year (FY) 1999; public four-year colleges/universities, FY 1999; aid to independent institutions, FY 1999; and total budget authorizations by campus, FY 1999-2000; (6) tuition and fees--community college resident credit hour tuition, 1995-99; public four-year undergraduate and graduate tuition, 1995-1999; (7) financial aid--undergraduate and graduate--total dollars, number of recipients and average award per recipient, 1997-98; state program expenditures, FY 1999; and (8) private career schools--enrollments by school, 1998; number, enrollment, and completion rate by school type, 1998. (CH)

ED 440 597

# DATA BOOK

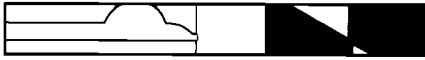

MARYLAND HIGHER  
EDUCATION COMMISSION

U.S. DEPARTMENT OF EDUCATION  
Office of Educational Research and Improvement  
EDUCATIONAL RESOURCES INFORMATION  
CENTER (ERIC)

This document has been reproduced as received from the person or organization originating it.

Minor changes have been made to improve reproduction quality.

---

• Points of view or opinions stated in this document do not necessarily represent official OERI position or policy.

PERMISSION TO REPRODUCE AND  
DISSEMINATE THIS MATERIAL HAS  
BEEN GRANTED BY

M. ROSENTHAL

---

TO THE EDUCATIONAL RESOURCES  
INFORMATION CENTER (ERIC)

2000

1

HE 032 827

ERIC  
Full Text Provided by ERIC

2

PARRIS N. GLENDENING  
GOVERNOR

o o o

MARYLAND HIGHER EDUCATION COMMISSION

Edward D. Clarke, Jr., Chairman

Stephen A. Birch

Dorothy Dixon Chaney

Paul D. Ellis, III

Anne Osborn Emery

John L. Green

Terry L. Lierman

John J. Oliver, Jr.

R. Kathleen Perini

Charles B. Saunders, Jr.

Richard P. Streett, Jr.

o o o

PATRICIA S. FLORESTANO, PH.D.

SECRETARY OF HIGHER EDUCATION

# TABLE OF CONTENTS

Comparative Higher Education Statistics - Maryland and National	1
<b>STUDENTS</b>	
<hr/>	
Core and Non-Core Curriculum Students Needing Remediation in College	2
Performance of Core and Non-Core Curriculum Students	3
Average Combined SAT Scores of Entering Freshmen / 1998-1999	4
Undergraduate Enrollment / Fall 1998	5
Graduate and Professional Enrollment / Fall 1998	7
Total Enrollment / 1998	8
Enrollment at Maryland State-Aided Independent Institutions / Fall 1998	9
Enrollment by Race and Gender / Fall 1998	10
<b>RETENTION AND GRADUATION</b>	
<hr/>	
By Race at Maryland Public Four-Year Institutions	12
Community College Students Graduating Four Years After Transferring / Class of 1994-1995	12
Community College Graduation and Transfer Rates / Class of 1994	13
Number of Community College Students Transferring in 1998	13
<b>DEGREES</b>	
<hr/>	
By Institution / 1997-1998	14
By Major Program / 1997-1998	16
By Race and Gender / 1997-1998	17
<b>FACULTY</b>	
<hr/>	
Full and Part-Time / Fall 1998	18

Full-Time Faculty by Race and Gender / Fall 1998	19
Full-Time, Average Salary / Fall 1998	20

## REVENUES AND EXPENDITURES

Community Colleges, Unrestricted Revenues / FY 1999	22
Community Colleges, Unrestricted Expenditures / FY 1999	22
Public Four-Year Colleges/Universities, Unrestricted Revenues / FY 1999	24
Public Four-Year Colleges/Universities, Unrestricted Expenditures / FY 1999	24
Aid to Independent Institutions / FY 1999	26
Total Capital Budget Authorizations by Campus / FY 1996-2000	27

## TUITION AND FEES

Community College Resident Credit Hour Tuition and Fees / 1995-1999	28
Public Four-Year Undergraduate Tuition and Fees / 1995-1999	29
Public Four-Year Graduate Credit-Hour Tuition / 1995-1999	30

## FINANCIAL AID

Undergraduate Financial Aid / 1997-1998	31
Graduate Financial Aid / 1997-1998	32
Maryland Financial Aid Program Expenditures / FY 1999	33

## PRIVATE CAREER SCHOOLS

Enrollments by School / 1998 Annual Report	34
Number, Enrollment, and Completion Rate by School Type / 1998 Annual Report	36

COMPARATIVE HIGHER EDUCATION STATISTICS  
MARYLAND AND NATIONAL

	MARYLAND	NATIONAL
<b>EDUCATIONAL ACHIEVEMENT (1990)</b>		
% With at Least an Associate Degree or Some College	23.8%	24.9%
% With at Least a Bachelor's Degree	15.6%	13.1%
% With a Graduate or Professional Degree	10.9%	7.2%
% of High School Graduates Who Enrolled in College in Own State (1996)	72.0%	80.0%
<b>Composite SAT Scores for High School Seniors (1998)</b>		
	1,014	1,017
Projected Increase in High School Graduates (1999-2000 to 2009-2010)	15.5%	10.2%
<b>ENROLLMENTS (FALL 1996)</b>		
% Undergraduate	81.9%	85.8%
% Women	58.4%	55.8%
% African-American	22.4%	10.5%
% All Minorities	32.2%	26.2%
% Foreign	3.7%	3.2%
Projected Increase at Public Campuses (1998-2008)	14.8%	10.3%
<b>CAMPUS MIX IN ENROLLMENTS (FALL 1996)</b>		
% Community Colleges	39.9%	37.0%
% Public Four-Year Campus	43.4%	40.4%
% Independent Campus	16.7%	22.6%
<b>DEGREES CONFERRED (1996)</b>		
Associate Degree	21.4%	24.7%
Bachelor's Degree	49.6%	51.8%
Master's Degree	24.4%	18.1%
Doctorate/First Professional Degree	4.5%	5.4%
<b>AVERAGE RESIDENT UNDERGRADUATE TUITION AND FEES (1997-1998)</b>		
Community Colleges	\$2,171	\$1,318
Public Four-Year Campuses	\$4,135	\$3,111
Independent Campuses (Maryland-State Aided)	\$16,209	\$13,392
<b>STATE FUNDING FOR HIGHER EDUCATION</b>		
State Appropriations (Pct change 1997-98 to 1998-99)	7.4%	7.0%
State Spending on Student Financial Aid (Pct change 1997-98 to 1998-99)	3.0%	9.6%
<b>AVERAGE SALARIES OF FULL-TIME FACULTY - IN THOUSANDS (1997-1998)</b>		
Public Four-Year Universities	\$61.2	\$58.7
Other Public Four-Year Institutions	\$50.0	\$51.0
Community Colleges	\$46.9	\$45.9
Independent Universities*	\$72.6	\$70.0
Other Independent Four-Year Institutions	\$46.7	\$47.5

Note:

\*The Maryland data is for 9-10 month faculty at Johns Hopkins University.

Source(s): The Chronicle of Higher Education, *Almanac Issue*, 1998 and 1999

U.S. Department of Education, National Center for Education Statistics. *Projections of Education Statistics*

9  
Higher Education Commission, *Enrollment Projections 1998-2008*, May 1999

CORE AND NON CORE CURRICULUM STUDENTS NEEDING REMEDIATION IN COLLEGE  
(BY JURISDICTION): 1997-1998

	MATH		ENGLISH		READING	
	CORE	NON-CORE	CORE	NON-CORE	CORE	NON-CORE
Anne Arundel	22%	33%	10%	16%	15%	21%
Baltimore City	27%	54%	18%	41%	20%	44%
Baltimore	21%	26%	12%	22%	14%	23%
Frederick	30%	42%	17%	21%	10%	9%
Lower Shore	22%	30%	16%	25%	9%	20%
Somerset	41%	43%	25%	36%	13%	38%
Wicomico	17%	33%	14%	22%	9%	20%
Worcester	28%	22%	15%	27%	9%	15%
Mid Maryland	20%	31%	9%	21%	10%	16%
Carroll	9%	15%	9%	25%	6%	11%
Howard	26%	42%	10%	18%	13%	20%
Montgomery	16%	31%	5%	12%	12%	20%
Prince George's	30%	40%	19%	28%	18%	29%
Southern Maryland	11%	16%	9%	17%	25%	39%
Calvert	11%	20%	8%	13%	16%	30%
Charles	13%	17%	9%	21%	31%	46%
St. Mary's	7%	12%	7%	16%	25%	37%
Susquehanna	28%	39%	9%	17%	6%	7%
Cecil	24%	33%	15%	11%	16%	5%
Harford	29%	40%	8%	18%	4%	8%
Upper Shore	24%	37%	7%	15%	7%	13%
Caroline	18%	33%	4%	8%	8%	0%
Dorchester	30%	31%	9%	15%	13%	8%
Kent	24%	29%	0%	14%	0%	7%
Queen Anne's	19%	44%	5%	18%	2%	18%
Talbot	30%	36%	13%	14%	7%	18%
Western Maryland	30%	48%	16%	28%	11%	18%
Allegany	31%	43%	13%	21%	14%	23%
Garrett	16%	50%	10%	28%	6%	0%
Washington	34%	53%	20%	33%	9%	17%
<b>ALL MARYLAND</b>	<b>23%</b>	<b>36%</b>	<b>12%</b>	<b>22%</b>	<b>14%</b>	<b>24%</b>

Note:

The designation of students as "core" or "non-core" depends on whether the student completed a course of study in high school that corresponds to the freshmen admissions requirements of the University System of Maryland. To be considered "core", a student must have completed all of the following:

- (1) 4 or more years of English;
- (2) 3 or more years of mathematics;
- (3) 3 or more years of social science or history;
- (4) 2 or more years of natural science and;
- (5) 2 or more years of a foreign language.

Source: Maryland Higher Education Commission High School Graduate System (Student Outcome and Achievement Report)

# PERFORMANCE OF CORE AND NON-CORE CURRICULUM STUDENTS

(BY JURISDICTION): 1997-1998

	MATH AVG. GRADE		ENGLISH AVG. GRADE		CUMULATIVE GPA	
	CORE	NON-CORE	CORE	NON-CORE	CORE	NON-CORE
Anne Arundel	2.6	2.3	2.7	2.5	2.6	2.3
Baltimore City	2.5	2.2	2.6	2.3	2.4	2.1
Baltimore	2.5	2.3	2.6	2.5	2.5	2.4
Frederick	2.7	2.6	2.7	2.6	2.7	2.7
Lower Shore	2.6	2.9	2.6	2.4	2.6	2.3
Somerset	2.6	2.6	2.6	2.3	2.8	2.2
Wicomico	2.7	3.0	2.5	2.4	2.6	2.1
Worcester	2.4	2.9	2.6	2.8	2.5	2.7
Mid Maryland	2.6	2.3	2.7	2.5	2.6	2.4
Carroll	2.6	2.2	2.7	2.4	2.7	2.4
Howard	2.7	2.4	2.7	2.5	2.6	2.3
Montgomery	2.4	2.2	2.5	2.2	2.6	2.2
Prince George's	2.2	2.1	2.5	2.3	2.3	2.2
Southern Maryland	2.4	2.3	2.8	2.5	2.6	2.3
Calvert	2.4	2.6	2.9	2.4	2.7	2.2
Charles	2.3	2.0	2.6	2.5	2.6	2.2
St. Mary's	2.4	2.5	2.8	2.7	2.7	2.5
Susquehanna	2.6	2.6	2.6	2.5	2.5	2.4
Cecil	2.6	2.8	2.5	2.5	2.5	2.6
Harford	2.6	2.6	2.6	2.5	2.5	2.3
Upper Shore	2.6	2.4	2.6	2.3	2.6	2.3
Caroline	2.3	3.4	2.7	2.2	2.6	2.3
Dorchester	2.8	3.3	2.5	2.5	2.5	2.1
Kent	2.4	2.6	2.6	2.7	2.4	2.8
Queen Anne's	2.5	2.0	2.7	2.1	2.6	2.0
Talbot	2.7	2.3	2.6	2.4	2.7	2.7
Western Maryland	2.5	2.5	2.8	2.6	2.6	2.4
Allegany	2.3	2.4	2.7	2.6	2.6	2.5
Garrett	2.8	2.9	2.6	2.0	2.8	2.3
Washington	2.4	2.7	2.9	2.7	2.6	2.2
<b>ALL MARYLAND</b>	2.5	2.3	2.6	2.4	2.5	2.3

**Note:**

The designation of students as "core" or "non-core" depends on whether the student completed a course of study in high school that corresponds to the freshmen admissions requirements of the University System of Maryland. To be considered "core", a student must have completed all of the following:

- (1) 4 or more years of English;
- (2) 3 or more years of mathematics;
- (3) 3 or more years of social science or history;
- (4) 2 or more years of natural science and;
- (5) 2 or more years of a foreign language.

Source: Maryland Higher Education Commission High School Graduate System (Student Outcome and Achievement Report)



# AVERAGE COMBINED SAT SCORES OF ENTERING FRESHMEN: 1998-1999

INSTITUTION	1998	Interquartile Range
Bowie	908	813-1,000
Coppin	889	820-940
Frostburg	985	890-1,060
Salisbury	1,120	1,050-1,180
Towson	1,089	1,000-1,170
UMBC	1,167	1,050-1,270
UMCP	1,209	1,120-1,300
UMES	858	770-930
Morgan	937	850-1,010
St. Mary's	1,237	1,160-1,330
<b>All Campuses</b>	1,040	
Maryland High School Seniors	1,014	
High School Seniors Nationally	1,017	

Source: Maryland Higher Education Commission S-11 form; The College Board



# UNDERGRADUATE ENROLLMENT: FALL 1998

INSTITUTION	TOTAL	FULL-TIME		PART-TIME		% MD
		#	%	#	%	RESIDENT
<b>COMMUNITY COLLEGES</b>						
Allegany	2,687	1,521	56.6%	1,166	43.4%	58.8%
Anne Arundel	12,113	3,586	29.6%	8,527	70.4%	98.9%
Baltimore City	5,974	2,123	35.5%	3,851	64.5%	98.6%
Carroll	2,435	813	33.4%	1,622	66.6%	98.7%
Cecil	1,339	418	31.2%	921	68.8%	92.9%
Charles	6,003	1,687	28.1%	4,316	71.9%	99.6%
Chesapeake	2,178	547	25.1%	1,631	74.9%	99.4%
CCBC						
Catonsville	8,857	2,699	30.5%	6,158	69.5%	98.4%
Dundalk	2,630	544	20.7%	2,086	79.3%	99.1%
Essex	7,842	2,700	34.4%	5,142	65.6%	97.4%
Frederick	4,294	1,366	31.8%	2,928	68.2%	98.8%
Garrett	663	388	58.5%	275	41.5%	69.5%
Hagerstown	2,802	1,046	37.3%	1,756	62.7%	75.6%
Harford	4,690	1,435	30.6%	3,255	69.4%	99.0%
Howard	5,100	1,536	30.1%	3,564	69.9%	97.7%
Montgomery	20,360	6,831	33.6%	13,529	66.4%	85.7%
Prince George's	12,435	3,048	24.5%	9,387	75.5%	94.1%
Wor-Wic	2,057	461	22.4%	1,596	77.6%	98.0%
<b>Total</b>	<b>104,459</b>	<b>32,749</b>	<b>31.4%</b>	<b>71,710</b>	<b>68.6%</b>	<b>93.6%</b>
<b>FOUR-YEAR PUBLICS</b>						
Bowie	3,154	2,191	69.5%	963	30.5%	92.3%
Coppin	3,209	2,250	70.1%	959	29.9%	92.6%
Frostburg	4,351	3,996	91.8%	355	8.2%	88.1%
Salisbury	5,534	4,607	83.2%	927	16.8%	76.9%
Towson	13,559	11,032	81.4%	2,527	18.6%	80.9%
UB	1,904	782	41.1%	1,122	58.9%	95.5%
UMB	826	505	61.1%	321	38.9%	87.8%
UMBC	8,638	6,602	76.4%	2,036	23.6%	89.5%
UMCP	24,776	21,630	87.3%	3,146	12.7%	66.5%
UMES	2,893	2,567	88.7%	326	11.3%	67.9%
UMUC	10,436	1,297	12.4%	9,139	87.6%	77.8%
Morgan	5,645	4,911	87.0%	734	13.0%	62.4%
St. Mary's	1,682	1,505	89.5%	177	10.5%	80.5%
<b>Total</b>	<b>86,607</b>	<b>63,875</b>	<b>73.8%</b>	<b>22,732</b>	<b>26.2%</b>	<b>77.0%</b>

Source: Maryland Higher Education Commission Enrollment Information System

UNDERGRADUATE ENROLLMENT: FALL 1998 (continued)

INSTITUTION	TOTAL	FULL-TIME		PART-TIME		% MD RESIDENT
		#	%	#	%	
<b>INDEPENDENTS</b>						
Baltimore Hebrew	189	84	44.4%	105	55.6%	97.4%
Baltimore International	549	549	100.0%	0	0.0%	85.2%
Capitol	695	312	44.9%	383	55.1%	78.6%
Columbia Union	1,126	599	53.2%	527	46.8%	56.0%
Goucher	1,137	1,081	95.1%	56	4.9%	37.8%
Hagerstown Business	547	280	51.2%	267	48.8%	41.3%
Harry Lundeberg	148	148	100.0%	0	0.0%	7.4%
Hood	945	640	67.7%	305	32.3%	73.2%
Johns Hopkins	4,882	4,287	87.8%	595	12.2%	21.8%
Loyola	3,255	3,171	97.4%	84	2.6%	27.7%
MD College of Art	83	67	80.7%	16	19.3%	78.3%
MD Institute of Art	1,448	1,038	71.7%	410	28.3%	43.6%
Mount St. Mary's	1,334	1,250	93.7%	84	6.3%	51.3%
National Labor College	123	93	75.6%	30	24.4%	22.8%
Ner Israel	280	280	100.0%	0	0.0%	42.1%
College of Notre Dame	2,270	697	30.7%	1,573	69.3%	91.5%
St. John's	434	432	99.5%	2	0.5%	14.1%
St. Mary's Seminary	5	5	100.0%	0	0.0%	0.0%
Sojourner Douglass	574	416	72.5%	158	27.5%	99.3%
Villa Julie	2,006	1,427	71.1%	579	28.9%	97.8%
Washington Bible	352	155	44.0%	197	56.0%	70.5%
Washington College	1,080	1,030	95.4%	50	4.6%	49.4%
Western Maryland	1,595	1,519	95.2%	76	4.8%	66.8%
<b>Total</b>	<b>25,057</b>	<b>19,560</b>	<b>78.1%</b>	<b>5,497</b>	<b>21.9%</b>	<b>52.7%</b>
<b>Total All Campuses</b>	<b>216,123</b>	<b>116,184</b>	<b>53.8%</b>	<b>99,939</b>	<b>46.2%</b>	<b>82.2%</b>

Source: Maryland Higher Education Commission Enrollment Information System

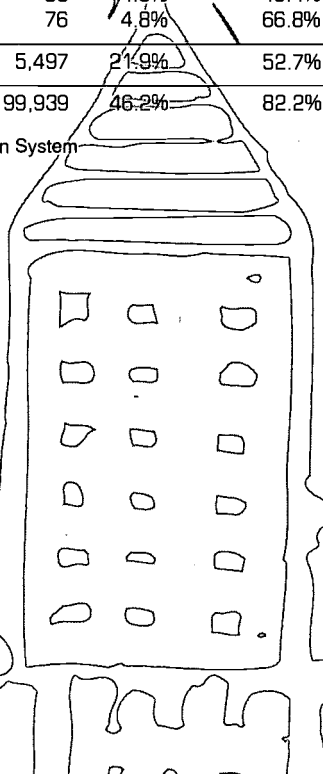
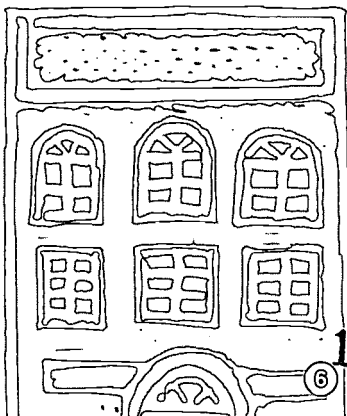

# GRADUATE AND PROFESSIONAL ENROLLMENT: FALL 1998

INSTITUTION	FULL-TIME		PART-TIME		TOTAL
	#	%	#	%	
<b>FOUR-YEAR PUBLICS</b>					
Bowie	319	17.1%	1,551	82.9%	1,870
Coppin	27	4.9%	528	95.1%	555
Frostburg	176	19.4%	733	80.6%	909
Salisbury	81	14.8%	465	85.2%	546
Towson	590	25.0%	1,774	75.0%	2,364
UB	1,412	51.9%	1,308	48.1%	2,720
UMB	3,483	71.4%	1,394	28.6%	4,877
UMBC	625	42.1%	859	57.9%	1,484
UMCP	4,179	51.3%	3,970	48.7%	8,149
UMES	149	47.6%	164	52.4%	313
UMUC	214	5.8%	3,492	94.2%	3,706
Morgan	222	44.8%	274	55.2%	496
<b>Total</b>	<b>11,477</b>	<b>41.0%</b>	<b>16,512</b>	<b>59.0%</b>	<b>27,989</b>
<b>INDEPENDENTS</b>					
Baltimore Hebrew	41	42.3%	56	57.7%	97
Capitol	8	6.8%	109	93.2%	117
Goucher	37	10.7%	310	89.3%	347
Hood	44	5.6%	739	94.4%	783
Johns Hopkins	4,055	33.2%	8,152	66.8%	12,207
Loyola	665	22.7%	2,261	77.3%	2,926
MD Institute of Art	132	85.7%	22	14.3%	154
Mount St. Mary's	180	46.8%	205	53.2%	385
Ner Israel	170	94.4%	10	5.6%	180
College of Notre Dame	43	4.8%	848	95.2%	891
St. John's	60	89.6%	7	10.4%	67
St. Mary's Seminary	72	26.4%	201	73.6%	273
Traditional Acupuncture	188	98.9%	2	1.1%	190
Villa Julie	0	0.0%	80	100.0%	80
Washington Bible	51	25.4%	150	74.6%	201
Washington College	3	4.5%	64	95.5%	67
Western Maryland	146	8.8%	1,520	91.2%	1,666
<b>Total</b>	<b>5,895</b>	<b>28.6%</b>	<b>14,736</b>	<b>71.4%</b>	<b>20,631</b>
<b>Total All Campuses</b>	<b>17,372</b>	<b>35.7%</b>	<b>31,248</b>	<b>64.3%</b>	<b>48,620</b>

Source: Maryland Higher Education Commission Enrollment Information System

TOTAL ENROLLMENT: 1998

INSTITUTION	TOTAL HEADCOUNT	FULL-TIME EQUIVALENT
<b>COMMUNITY COLLEGES</b>		
Allegheny	2,687	1,788
Anne Arundel	12,113	6,590
Baltimore City	5,974	3,678
CCBC*	19,329	10,313
Carroll	2,435	1,305
Cecil	1,339	742
Charles	6,003	3,043
Chesapeake	2,178	1,096
Frederick	4,294	2,453
Garrett	663	481
Hagerstown	2,802	1,598
Harford	4,690	2,367
Howard	5,100	2,771
Montgomery	20,360	12,217
Prince George's	12,435	6,572
Wor-Wic	2,057	1,090
<b>Total</b>	<b>104,459</b>	<b>58,104</b>
<b>FOUR-YEAR PUBLICS</b>		
Bowie	5,024	3,326
Coppin	3,764	2,753
Frostburg	5,260	4,181
Salisbury	6,080	5,049
Towson	15,923	12,309
UB	4,624	3,035
UMB	5,703	5,244
UMBC	10,122	7,795
UMCP	32,925	25,830
UMES	3,206	3,926
UMUC	14,142	7,763
Morgan	6,141	5,411
St. Mary's	1,682	1,690
<b>Total</b>	<b>114,596</b>	<b>88,312</b>

Note:

\* The Community College of Baltimore County includes Catonsville, Dundalk, and Essex.

(1) Community College FTE enrollment information includes full-time equivalent and non-credit enrollment for State aid.

(2) Headcount enrollment is for Fall 1998 and FTE enrollment is for FY 1999.

Source: Maryland Higher Education Commission Enrollment Information System, CC-4 form and institutional budgets

# ENROLLMENT AT MARYLAND STATE-AIDED INDEPENDENT INSTITUTIONS

INSTITUTION	TOTAL HEADCOUNT	FULL-TIME EQUIVALENT
Baltimore International	549	498
Capitol	812	488
Goucher	1,484	1,353
Hood	1,728	990
Johns Hopkins	17,089	13,207
Loyola	6,181	4,393
MD Institute, College of Art	1,602	1,285
Mount St. Mary's	1,719	1,345
College of Notre Dame	3,161	1,465
St. John's	501	572
Sojourner Douglass	574	529
Villa Julie	2,086	1,718
Washington College	1,147	1,194
Western Maryland	3,261	2,169
<b>Total</b>	<b>41,894</b>	<b>31,204</b>
<b>Total All Campuses</b>	<b>260,949</b>	<b>177,620</b>

Note:  
 Headcount enrollment is for Fall 1998 and FTE enrollment is for Fall 1998.  
 Source: Maryland Higher Education Commission Enrollment Information System and S-6 form



# ENROLLMENT BY RACE AND GENDER: FALL 1998

INSTITUTION	AFRICAN-AMERICAN	WHITE	OTHER*	MEN	WOMEN
<b>COMMUNITY COLLEGES</b>					
Allegany	85	2,559	43	920	1,767
Anne Arundel	1,336	9,710	1,067	4,857	7,256
Baltimore City	4,964	579	431	1,552	4,422
Carroll	52	2,261	122	926	1,509
Cecil	44	1,258	37	499	840
Charles	732	4,859	412	2,025	3,978
Chesapeake	341	1,788	49	694	1,484
CCBC					
Catonsville	2,641	4,922	1,294	3,806	5,051
Dundalk	403	2,120	107	1,187	1,443
Essex	1,114	5,841	887	2,978	4,864
Frederick	266	3,720	308	1,625	2,669
Garrett	19	632	12	285	378
Hagerstown	186	2,498	118	1,079	1,723
Harford	427	3,963	300	1,832	2,858
Howard	897	3,295	908	2,049	3,051
Montgomery	4,806	8,754	6,800	8,760	11,600
Prince George's	8,823	2,353	1,259	4,399	8,036
Wor-Wic	411	1,578	68	622	1,435
<b>Total</b>	<b>27,547</b>	<b>62,690</b>	<b>14,222</b>	<b>40,095</b>	<b>64,364</b>
<b>FOUR-YEAR PUBLICS</b>					
Bowie	3,915	846	263	1,711	3,313
Coppin	3,564	99	101	1,020	2,744
Frostburg	467	4,536	257	2,470	2,790
Salisbury	497	5,185	398	2,541	3,539
Towson	1,604	12,772	1,547	6,041	9,882
UB	949	2,895	780	2,090	2,534
UMB	899	3,889	915	1,803	3,900
UMBC	1,504	6,242	2,376	4,917	5,205
UMCP	4,143	19,467	9,315	17,032	15,893
UMES	2,355	541	310	1,356	1,850
UMUC	4,025	7,703	2,414	6,521	7,621
Morgan	5,778	103	260	2,508	3,633
St. Mary's	148	1,394	140	711	971
<b>Total</b>	<b>29,848</b>	<b>65,672</b>	<b>19,076</b>	<b>50,721</b>	<b>63,875</b>

**Note:**

Other includes Native American, Asian, Hispanic, Foreign and Other.

Source: Maryland Higher Education Commission Enrollment Information System

INSTITUTION	AFRICAN-AMERICAN	WHITE	OTHER*	MEN	WOMEN
<b>INDEPENDENTS</b>					
Baltimore Hebrew	2	284	0	94	192
Baltimore International	207	301	41	326	223
Capitol	263	410	139	637	175
Columbia Union	469	387	270	458	668
Goucher	122	1,002	360	393	1,091
Hagerstown Business	24	521	2	49	498
Harry Lundeberg	58	84	6	140	8
Hood	125	1,077	526	362	1,366
Johns Hopkins	1,337	11,986	3,766	8,660	8,429
Loyola	379	5,200	602	2,598	3,583
MD College of Art	23	37	23	48	35
MD Institute of Art	72	1,191	339	688	914
Mount St. Mary's	79	1,489	151	872	847
National Labor College	19	94	10	81	42
Ner Israel	0	418	42	460	0
College of Notre Dame	627	2,374	160	323	2,838
St. John's	3	446	52	276	225
St. Mary's Seminary	57	215	6	150	128
Sojourner Douglass	540	15	19	84	490
Traditional Acupuncture	6	168	16	32	158
Villa Julie	202	1,758	126	585	1,501
Washington Bible	223	224	106	366	187
Washington College	48	911	188	484	663
Western Maryland	168	2,447	646	1,080	2,181
<b>Total</b>	<b>5,053</b>	<b>33,039</b>	<b>7,596</b>	<b>19,246</b>	<b>26,442</b>
<b>Total All Campuses</b>	<b>62,448</b>	<b>161,401</b>	<b>40,894</b>	<b>110,062</b>	<b>154,681</b>

Note:

Other includes Native American, Asian, Hispanic, Foreign and Other.

Source: Maryland Higher Education Commission Enrollment Information System



# RETENTION AND GRADUATION

## BY RACE AT MARYLAND PUBLIC FOUR-YEAR INSTITUTIONS

INSTITUTION	AFRICAN-AMERICAN		ALL STUDENTS	
	RETENTION	GRADUATION	RETENTION	GRADUATION
Bowie	71.6%	38.1%	70.8%	38.1%
Coppin	73.9%	22.1%	72.1%	21.2%
Frostburg	71.7%	44.6%	72.5%	63.1%
Salisbury	60.9%	60.8%	82.0%	68.6%
Towson	80.1%	50.4%	81.7%	63.2%
UMBC	90.7%	53.0%	84.2%	57.4%
UMCP	85.7%	47.7%	87.9%	63.6%
UMES	79.1%	35.2%	76.8%	34.5%
Morgan	75.5%	39.8%	75.0%	39.2%
St. Mary's	86.1%	71.4%	85.8%	77.3%
<b>Average</b>	<b>78.0%</b>	<b>39.7%</b>	<b>81.8%</b>	<b>56.2%</b>

Note:

- (1) Second year retention rates are for the 1997 cohort of all full-time, first-time undergraduates and the graduation rates are for 1992 new full-time freshmen at any Maryland public four-year institution.
- (2) University of Baltimore and University of Maryland, Baltimore are excluded because they do not enroll first-time freshmen.
- (3) University of Maryland University College is excluded due to its mission to serve the adult part-time population.

Source: Maryland Higher Education Commission Enrollment and Degree Information Systems

## COMMUNITY COLLEGE STUDENTS GRADUATING FOUR YEARS AFTER TRANSFERRING: CLASS OF 1994 - 1995

INSTITUTION	ALL STUDENTS	AFRICAN-AMERICAN	ALL MINORITIES
Bowie	44.2%	42.9%	44.6%
Coppin	28.2%	27.0%	27.5%
Frostburg	58.2%	33.3%	33.3%
Salisbury	54.0%	35.3%	43.6%
Towson	51.4%	38.0%	38.4%
UB	48.9%	45.7%	45.9%
UMB	95.0%	100.0%	96.9%
UMBC	37.0%	24.1%	34.9%
UMCP	53.0%	44.4%	52.6%
UMES	45.5%	37.0%	41.9%
UMUC	48.9%	7.3%	11.6%
Morgan	24.8%	24.6%	24.6%
St. Mary's	70.3%	-	75.0%
<b>Total</b>	<b>45.7%</b>	<b>32.8%</b>	<b>39.3%</b>

Source: Maryland Higher Education Commission Transfer Student System

FOUR-YEAR COMMUNITY COLLEGE GRADUATION AND TRANSFER RATES:  
CLASS OF 1994

INSTITUTION	ALL STUDENTS			AFRICAN-AMERICAN		
	TRANSFERRED	GRADUATED	COMB.	TRANSFERRED	GRADUATED	COMB.
Allegany	10.9%	26.6%	37.5%	11.1%	11.1%	22.2%
Anne Arundel	30.4%	8.8%	39.2%	18.8%	3.8%	22.6%
Baltimore City	13.7%	3.6%	17.3%	12.9%	2.9%	15.8%
Carroll	28.2%	12.6%	40.8%	—	—	0.0%
Cecil	12.5%	10.9%	23.4%	—	—	0.0%
Charles	31.2%	6.0%	37.2%	26.1%	2.2%	28.3%
Chesapeake	21.9%	22.4%	44.3%	8.7%	17.4%	26.1%
CCBC						
Catonsville	24.2%	4.7%	28.9%	15.6%	2.0%	17.6%
Dundalk	14.9%	9.3%	24.2%	3.3%	10.0%	13.3%
Essex	25.7%	6.1%	31.8%	18.2%	4.0%	22.2%
Frederick	23.9%	18.3%	42.2%	9.6%	14.3%	23.9%
Garrett	13.1%	15.4%	28.5%	—	—	0.0%
Hagerstown	15.0%	22.8%	37.8%	5.5%	12.3%	17.8%
Harford	24.4%	9.0%	33.4%	6.6%	6.7%	13.3%
Howard	32.1%	4.3%	36.4%	12.4%	1.2%	13.6%
Montgomery	25.9%	3.8%	29.7%	18.4%	4.0%	22.4%
Prince George's	24.2%	3.1%	27.3%	16.9%	1.0%	17.9%
Wor-Wic	19.4%	17.5%	36.9%	—	—	0.0%
<b>STATEWIDE AVERAGE</b>	23.6%	8.6%	32.2%	15.4%	3.3%	18.7%

Note: (1) "—" denotes an N of less than 15. (2) Combined includes transfer and graduation rates.

Source: Maryland Higher Education Commission Enrollment and Degree Information Systems

NUMBER OF COMMUNITY COLLEGE STUDENTS TRANSFERRING IN 1998

INSTITUTION	BSU	CSC	FSU	SSU	TU	UB	UMB	UMBC	UMCP	UMES	UMUC	MSU	SMC	TOTAL
Allegany	1	—	115	2	4	—	1	6	6	—	—	—	—	135
Anne Arundel	20	2	16	75	152	61	26	215	194	9	107	3	4	884
Baltimore City	6	78	3	2	31	49	19	16	6	5	—	51	—	266
Carroll	—	1	7	19	70	11	1	28	18	1	2	1	1	160
Cecil	—	—	4	20	18	5	1	—	5	—	2	1	—	56
Charles	9	—	31	42	67	2	8	35	85	4	119	6	39	447
Chesapeake	3	—	5	47	17	—	3	8	21	3	4	—	—	111
CCBC														
Catonsville	3	23	7	14	131	89	24	168	41	5	8	12	1	526
Dundalk	2	3	1	2	27	24	7	13	2	1	1	4	1	88
Essex	1	3	6	21	257	85	14	82	38	—	5	13	2	527
Frederick	—	—	27	15	53	1	11	26	52	—	16	1	5	207
Garrett	—	—	33	4	2	—	—	1	1	—	—	—	—	41
Hagerstown	—	—	55	11	30	1	2	9	12	2	9	1	1	133
Harford	—	3	6	36	115	35	8	22	31	1	12	2	1	272
Howard	—	2	9	21	82	24	14	92	115	2	26	3	3	393
Montgomery	25	1	33	34	93	10	32	166	743	5	309	7	8	1,466
Prince George's	144	3	9	21	28	3	16	51	264	10	206	27	2	784
Wor-Wic	—	—	1	130	9	1	—	4	2	17	2	1	—	167
<b>Total</b>	214	119	368	516	1,186	401	187	942	1,636	65	828	133	68	6,663

## BY INSTITUTION: 1997-1998

INSTITUTION	LOWER DIV. CERTIFICATE	ASSOCIATE	BACHELOR'S	MASTER'S	DOCTORATE	FIRST PROF.	TOTAL
<b>COMMUNITY COLLEGES</b>							
Allegany	77	501	-	-	-	-	578
Anne Arundel	288	909	-	-	-	-	1,197
Baltimore City	54	295	-	-	-	-	349
Carroll	28	233	-	-	-	-	261
Cecil	56	136	-	-	-	-	192
Charles	116	486	-	-	-	-	602
Chesapeake	61	140	-	-	-	-	201
CCBC							
Catonsville	249	658	-	-	-	-	907
Dundalk	62	196	-	-	-	-	258
Essex	47	644	-	-	-	-	691
Frederick	36	391	-	-	-	-	427
Garrett	37	74	-	-	-	-	111
Hagerstown	25	341	-	-	-	-	366
Harford	36	381	-	-	-	-	417
Howard	41	306	-	-	-	-	347
Montgomery	311	947	-	-	-	-	1,258
Prince George's	120	638	-	-	-	-	758
Wor-Wic	55	158	-	-	-	-	213
<b>Total</b>	<b>1,699</b>	<b>7,434</b>	<b>0</b>	<b>0</b>	<b>0</b>	<b>0</b>	<b>9,133</b>
<b>FOUR-YEAR PUBLICS</b>							
Bowie	-	-	508	501	-	-	1,009
Coppin	-	-	339	107	-	-	446
Frostburg	-	-	836	206	-	-	1,042
Salisbury	-	-	1,263	167	-	-	1,430
Towson	-	-	2,379	522	-	-	2,901
UB	-	-	476	395	-	303	1,174
UMB	-	-	416	707	71	628	1,822
UMBC	-	-	1,423	217	54	-	1,694
UMCP	20	-	4,977	1,526	474	-	6,997
UMES	-	-	415	73	3	-	491
UMUC	-	45	2,127	740	-	-	2,912
Morgan	-	-	694	64	4	-	762
St. Mary's	-	-	334	-	-	-	334
<b>Total</b>	<b>20</b>	<b>45</b>	<b>16,187</b>	<b>5,225</b>	<b>606</b>	<b>931</b>	<b>23,014</b>

Source: Maryland Higher Education Commission Degree Information System

INSTITUTION	LOWER DIV. CERTIFICATE	ASSOCIATE	BACHELOR'S	MASTER'S	DOCTORATE	FIRST PROF.	TOTAL
<b>INDEPENDENTS</b>							
Baltimore Hebrew	-	7	7	16	-	-	30
Baltimore International	54	131	-	-	-	-	185
Capitol	24	12	86	31	-	-	153
Columbia Union	-	30	271	-	-	-	301
Goucher	-	-	190	65	-	-	255
Hagerstown Business	44	124	-	-	-	-	168
Harry Lundeberg	255	-	-	-	-	-	255
Hood	-	-	235	198	-	-	433
Johns Hopkins	-	-	1,109	2,845	382	125	4,461
Loyola	-	-	758	903	3	-	1,664
MD College of Art	-	21	-	-	-	-	21
MD Institute of Art	-	-	195	75	-	-	270
Mount St. Mary's	-	-	350	89	-	26	465
Ner Israel	17	-	64	23	4	18	126
Notre Dame	-	-	357	158	-	-	515
St. John's	-	-	115	55	-	-	170
St. Mary's Seminary	-	-	2	18	-	9	29
Sojourner Douglass	-	-	95	-	-	-	95
Traditional Acupuncture	-	-	-	62	-	-	62
Villa Julie	-	57	287	-	-	-	344
Washington Bible	4	3	33	13	-	6	59
Washington College	-	-	197	27	-	-	224
Western Maryland	-	-	266	326	-	-	592
<b>Total</b>	<b>398</b>	<b>385</b>	<b>4,617</b>	<b>4,904</b>	<b>389</b>	<b>184</b>	<b>10,877</b>
<b>Total All Campuses</b>	<b>2,117</b>	<b>7,864</b>	<b>20,804</b>	<b>10,129</b>	<b>995</b>	<b>1,115</b>	<b>43,024</b>

Source: Maryland Higher Education Commission Degree Information System

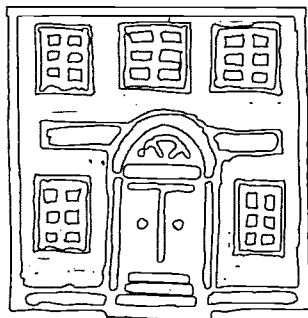
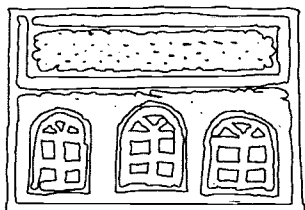

BY MAJOR PROGRAM: 1997-1998

MAJOR PROGRAM	LOWER DIV. CERTIFICATE	ASSOCIATE	BACHELOR'S	MASTER'S	DOCTORATE	FIRST PROF.	TOTAL
Agriculture	-	-	184	46	13	-	243
Architecture	-	-	51	39	-	-	90
Area Studies	-	-	54	9	5	-	68
Biological Science	-	-	1,379	191	156	-	1,726
Business	-	-	2,940	2,688	15	-	5,643
Communications	-	-	902	68	12	-	982
Computer Science	-	-	856	530	23	-	1,409
Education	-	-	1,668	2,271	105	-	4,044
Engineering	-	-	897	535	148	-	1,580
Arts	-	-	805	236	53	-	1,094
Languages	-	-	201	26	13	-	240
Health	-	-	1,460	1,013	130	490	3,093
Home Economics	-	-	168	15	3	-	186
Law	-	-	82	35	-	566	683
Letters	-	-	974	145	25	-	1,144
Library Science	-	-	-	103	1	-	104
Mathematics	-	-	236	66	38	-	340
Physical Science	-	-	225	204	99	-	528
Psychology	-	-	1,361	441	33	-	1,835
Public Affairs	-	-	668	483	11	-	1,162
Social Science	-	-	2,758	663	104	-	3,525
Theology	-	-	111	75	4	59	249
Interdisciplinary	1	91	2,824	247	4	-	3,167
Arts & Science Transfer	-	660	-	-	-	-	660
Engineering Transfer	-	66	-	-	-	-	66
General Studies Transfer	-	2,335	-	-	-	-	2,335
Education Transfer	-	212	-	-	-	-	212
Business Transfer	-	713	-	-	-	-	713
Computer Science Transfer	-	114	-	-	-	-	114
Business Technology	512	892	-	-	-	-	1,404
Data Processing	228	306	-	-	-	-	534
Health Technology	276	1,515	-	-	-	-	1,791
Engineering Technology	517	249	-	-	-	-	766
Natural Science Technology	114	165	-	-	-	-	279
Public Service Technology	405	546	-	-	-	-	951
Directed Technology	64	0	-	-	-	-	64
<b>Total</b>	<b>2,117</b>	<b>7,864</b>	<b>20,804</b>	<b>10,129</b>	<b>995</b>	<b>1,115</b>	<b>42,960</b>

Source: Maryland Higher Education Commission Degree Information System

BY RACE AND GENDER: 1997-1998

	<b>LOWER DIV. CERTIFICATE</b>		<b>ASSOCIATE</b>		<b>BACHELOR'S</b>		<b>MASTER'S</b>	
	#	%	#	%	#	%	#	%
African American	354	16.7%	1,253	15.9%	3,841	18.5%	1,217	12.0%
Native American	11	0.5%	26	0.3%	64	0.3%	17	0.2%
Asian	74	3.5%	278	3.5%	1,441	6.9%	483	4.8%
Hispanic	58	2.7%	169	2.1%	473	2.3%	177	1.7%
White	1,544	72.9%	5,900	75.0%	14,085	67.7%	7,025	69.4%
Foreign	45	2.1%	160	2.0%	674	3.2%	1,062	10.5%
Other	31	1.5%	78	1.0%	225	1.1%	148	1.5%
<b>Total</b>	<b>2,117</b>	<b>100.0%</b>	<b>7,864</b>	<b>100.0%</b>	<b>20,803</b>	<b>100.0%</b>	<b>10,129</b>	<b>100.0%</b>
All Men	1,024	48.4%	2,626	33.4%	8,746	42.0%	4,270	42.2%
All Women	1,093	51.6%	5,238	66.6%	12,058	58.0%	5,859	57.8%
<b>Total</b>	<b>2,117</b>	<b>100.0%</b>	<b>7,864</b>	<b>100.0%</b>	<b>20,804</b>	<b>100.0%</b>	<b>10,129</b>	<b>100.0%</b>

	<b>DOCTORATE</b>		<b>FIRST PROFESSIONAL</b>		<b>TOTAL</b>	
	#	%	#	%	#	%
African American	42	4.2%	154	13.8%	6,861	15.9%
Native American	1	0.1%	3	0.3%	122	0.3%
Asian	55	5.5%	122	10.9%	2,453	5.7%
Hispanic	10	1.0%	21	1.9%	908	2.1%
White	582	58.5%	786	70.5%	29,922	69.5%
Foreign	296	29.7%	14	1.3%	2,251	5.2%
Other	9	0.9%	15	1.3%	506	1.2%
<b>Total</b>	<b>995</b>	<b>100.0%</b>	<b>1,115</b>	<b>100.0%</b>	<b>43,023</b>	<b>100.0%</b>
All Men	563	56.6%	584	52.4%	17,813	41.4%
All Women	432	43.4%	531	47.6%	25,211	58.6%
<b>Total</b>	<b>995</b>	<b>100.0%</b>	<b>1,115</b>	<b>100.0%</b>	<b>43,024</b>	<b>100.0%</b>

Source: Maryland Higher Education Commission Degree Information System

**FULL- AND PART-TIME: FALL 1998**

INSTITUTION	FULL-TIME		PART-TIME		TOTAL
	#	%	#	%	
<b>COMMUNITY COLLEGES</b>					
Allegany	90	40.0%	135	60.0%	225
Anne Arundel	198	29.7%	469	70.3%	667
Baltimore City	118	27.5%	311	72.5%	429
Carroll	44	12.8%	299	87.2%	343
Cecil	37	36.3%	65	63.7%	102
Charles	86	24.1%	271	75.9%	357
Chesapeake	42	26.3%	118	73.8%	160
CCBC					
Catonsville	173	36.3%	304	63.7%	477
Dundalk	50	34.2%	96	65.8%	146
Essex	142	37.0%	242	63.0%	384
Frederick	72	25.5%	210	74.5%	282
Garrett	19	44.2%	24	55.8%	43
Hagerstown	57	34.5%	108	65.5%	165
Harford	77	22.6%	263	77.4%	340
Howard	87	27.4%	230	72.6%	317
Montgomery	388	37.3%	653	62.7%	1,041
Prince George's	215	34.7%	404	65.3%	619
Wor-Wic	39	36.4%	68	63.6%	107
<b>Total</b>	<b>1,934</b>	<b>31.2%</b>	<b>4,270</b>	<b>68.8%</b>	<b>6,204</b>
<b>FOUR-YEAR PUBLICS</b>					
Bowie	159	54.1%	135	45.9%	294
Coppin	114	81.4%	26	18.6%	140
Frostburg	238	73.0%	88	27.0%	326
Salisbury	263	70.9%	108	29.1%	371
Towson	482	45.2%	585	54.8%	1,067
UB	144	44.2%	182	55.8%	326
UMB	344	72.9%	128	27.1%	472
UMBC	483	60.6%	314	39.4%	797
UMCP	2,410	76.0%	760	24.0%	3,170
UMES	122	60.1%	81	39.9%	203
UMUC	10	1.5%	645	98.5%	655
Morgan	329	94.0%	21	6.0%	350
St. Mary's	111	61.0%	71	39.0%	182
<b>Total</b>	<b>5,209</b>	<b>62.4%</b>	<b>3,144</b>	<b>37.6%</b>	<b>8,353</b>
<b>Total All Campuses</b>	<b>7,143</b>	<b>49.1%</b>	<b>7,414</b>	<b>50.9%</b>	<b>14,557</b>

Note:  
 Figures exclude clinical medicine faculty at UMB and faculty at extension services of the University of Maryland.

Source: Maryland Higher Education Commission Employee Data System

# FULL-TIME FACULTY BY RACE AND GENDER: FALL 1998

INSTITUTION	AFRICAN-AMERICAN		WHITE		OTHER*		MEN		WOMEN	
	#	%	#	%	#	%	#	%	#	%
<b>COMMUNITY COLLEGES</b>										
Allegany	0	0.0%	90	100.0%	0	0.0%	46	51.1%	44	48.9%
Anne Arundel	13	6.6%	173	87.4%	12	6.1%	104	52.5%	94	47.5%
Baltimore City	54	45.8%	59	50.0%	5	4.2%	52	44.1%	66	55.9%
Carroll	0	0.0%	44	100.0%	0	0.0%	16	36.4%	28	63.6%
Cecil	1	2.7%	34	91.9%	2	5.4%	17	45.9%	20	54.1%
Charles	8	9.3%	73	84.9%	5	5.8%	41	47.7%	45	52.3%
Chesapeake	3	7.1%	39	92.9%	0	0.0%	21	50.0%	21	50.0%
<b>CCBC</b>										
Catonsville	15	8.7%	153	88.4%	5	2.9%	93	53.8%	80	46.2%
Dundalk	3	6.0%	46	92.0%	1	2.0%	30	60.0%	20	40.0%
Essex	8	5.6%	129	90.8%	5	3.5%	74	52.1%	68	47.9%
Frederick	2	2.8%	67	93.1%	3	4.2%	33	45.8%	39	54.2%
Garrett	0	0.0%	18	94.7%	1	5.3%	11	57.9%	8	42.1%
Hagerstown	0	0.0%	56	98.2%	1	1.8%	24	42.1%	33	57.9%
Harford	4	5.2%	71	92.2%	2	2.6%	39	50.6%	38	49.4%
Howard	16	18.4%	67	77.0%	4	4.6%	30	34.5%	57	65.5%
Montgomery	41	10.6%	315	81.2%	32	8.2%	205	52.8%	183	47.2%
Prince George's	36	16.7%	167	77.7%	12	5.6%	97	45.1%	118	54.9%
Wor-Wic	1	2.6%	38	97.4%	0	0.0%	17	43.6%	22	56.4%
<b>Total</b>	<b>205</b>	<b>10.6%</b>	<b>1,639</b>	<b>84.7%</b>	<b>90</b>	<b>4.7%</b>	<b>950</b>	<b>49.1%</b>	<b>984</b>	<b>50.9%</b>
<b>FOUR-YEAR PUBLICS</b>										
Bowie	98	61.6%	49	30.8%	12	7.5%	84	52.8%	75	47.2%
Coppin	83	72.8%	22	19.3%	9	7.9%	55	48.2%	59	51.8%
Frostburg	5	2.1%	214	89.9%	19	8.0%	156	65.5%	82	34.5%
Salisbury	10	3.8%	241	91.6%	12	4.6%	164	62.4%	99	37.6%
Towson	18	3.7%	421	87.3%	43	8.9%	296	61.4%	186	38.6%
UB	9	6.3%	121	84.0%	14	9.7%	94	65.3%	50	34.7%
UMB	32	9.3%	293	85.2%	19	5.5%	184	53.5%	160	46.5%
UMBC	28	5.8%	388	80.3%	67	13.9%	347	71.8%	136	28.2%
UMCP	132	5.5%	1,922	79.8%	356	14.8%	1,708	70.9%	702	29.1%
UMES	55	45.1%	47	38.5%	20	16.4%	72	59.0%	50	41.0%
UMUC	0	0.0%	10	100.0%	0	0.0%	8	80.0%	2	20.0%
Morgan	224	68.1%	69	21.0%	36	10.9%	196	59.6%	133	40.4%
St. Mary's	11	9.9%	90	81.1%	10	9.0%	67	60.4%	44	39.6%
<b>Total</b>	<b>705</b>	<b>13.5%</b>	<b>3,887</b>	<b>74.6%</b>	<b>617</b>	<b>11.8%</b>	<b>3,431</b>	<b>65.9%</b>	<b>1,778</b>	<b>34.1%</b>
<b>Total All Campuses</b>	<b>910</b>	<b>12.7%</b>	<b>5,526</b>	<b>77.4%</b>	<b>707</b>	<b>9.9%</b>	<b>4,381</b>	<b>61.3%</b>	<b>2,762</b>	<b>38.7%</b>

Note:

- (1) Other includes Native American, Asian, Hispanic, and Other
- (2) Figures exclude clinical medicine faculty at UMB and faculty at extension services at the University of Maryland.

Source: Maryland Higher Education Commission Employee Data System



# AVERAGE SALARY FULL-TIME: FALL 1998

INSTITUTION	PROFESSOR	ASSOCIATE PROFESSOR	ASSISTANT PROFESSOR	INSTRUCTOR	LECTURER	CAMPUS AVERAGE
<b>COMMUNITY COLLEGES</b>						
Allegany	\$52,877	\$43,570	\$35,875	\$31,898	-	\$42,102
Anne Arundel	62,021	49,058	39,584	35,841	-	50,395
Baltimore City	53,196	46,494	38,931	31,822	-	43,118
Carroll	61,156	42,435	34,088	33,206	-	39,490
Cecil	54,004	47,469	40,621	36,189	-	46,695
Charles	57,375	46,120	42,740	29,492	-	51,517
Chesapeake	52,271	46,156	41,001	37,319	42,770	44,351
<b>CCBC</b>						
Catonsville	57,556	47,380	37,951	31,914	-	44,877
Dundalk	57,046	46,330	37,436	24,333	-	45,212
Essex	57,027	47,164	36,595	29,986	-	47,109
Frederick	51,696	46,048	39,628	34,725	29,760	44,523
Garrett	45,104	38,067	34,615	30,633	-	40,457
Hagerstown	54,105	39,913	34,593	29,985	-	46,518
Harford	59,004	55,080	44,792	36,281	45,999	51,843
Howard	61,130	48,837	41,825	36,776	32,170	50,854
Montgomery	60,214	49,972	43,457	39,113	-	55,407
Prince George's	59,235	45,353	38,124	33,774	-	50,627
Wor-Wic	60,153	52,643	44,632	35,174	-	44,582
<b>Community College Average</b>	<b>\$58,439</b>	<b>\$47,481</b>	<b>\$39,236</b>	<b>\$34,158</b>	<b>\$30,720</b>	<b>\$48,864</b>



INSTITUTION	PROFESSOR	ASSOCIATE PROFESSOR	ASSISTANT PROFESSOR	INSTRUCTOR	LECTURER	CAMPUS AVERAGE
<b>FOUR-YEAR PUBLICS</b>						
Bowie	\$62,754	\$52,357	\$44,029	\$35,971	\$34,352	\$46,848
Coppin	63,073	50,037	43,366	39,742	19,870	46,339
Frostburg	60,768	49,603	42,518	35,771	29,835	49,010
Salisbury	62,678	49,185	42,760	39,277	34,013	47,090
Towson	62,955	51,322	42,763	36,714	29,639	51,082
UB	86,928	65,421	49,235	-	-	70,562
UMB	102,156	78,144	61,596	49,347	-	75,614
UMBC	80,332	55,690	48,735	36,332	37,060	58,524
UMCP	91,490	61,125	55,262	46,199	36,012	69,893
UMES	56,690	52,915	44,982	38,800	37,143	45,222
UMUC	-	-	-	-	30,800	30,800
Morgan	73,943	57,364	48,126	39,280	35,204	48,316
St. Mary's	71,821	54,680	39,422	35,800	-	52,634
<b>Four-Year Public Average</b>	<b>\$82,440</b>	<b>\$59,076</b>	<b>\$49,300</b>	<b>\$42,142</b>	<b>\$34,362</b>	<b>\$60,690</b>

Note:

(1) Figures exclude clinical medicine faculty at UMB and faculty at extension services at the University of Maryland.

Source: Maryland Higher Education Commission Employee Data System

# REVENUES AND EXPENDITURES

## COMMUNITY COLLEGES, UNRESTRICTED REVENUES: FY 1999

INSTITUTION	S T A T E		L O C A L	
	\$	%	\$	%
Allegany	\$3,617,216	23.1%	\$4,275,000	27.3%
Anne Arundel	12,264,000	27.8%	16,403,500	37.1%
Baltimore City	19,760,637	66.5%	115,659	0.4%
Carroll	3,286,066	31.0%	3,435,208	32.4%
Cecil	2,513,022	25.6%	4,481,069	45.7%
Charles	4,775,726	18.0%	7,811,935	29.4%
Chesapeake	2,894,631	29.9%	3,751,911	38.8%
CCBC	21,806,544	25.6%	31,671,693	37.2%
Frederick	3,446,830	19.1%	6,391,544	35.4%
Garrett	2,543,893	43.3%	1,636,000	27.8%
Hagerstown	3,722,650	27.2%	4,162,760	30.5%
Harford	4,834,367	23.5%	8,802,625	42.9%
Howard	5,023,690	17.5%	10,675,080	37.1%
Montgomery	16,634,635	16.7%	43,192,000	43.4%
Prince George's	12,011,043	25.9%	10,482,754	22.6%
Wor-Wic	3,102,933	35.5%	2,767,282	31.6%
<b>Total</b>	<b>\$122,237,883</b>	<b>25.9%</b>	<b>\$160,056,020</b>	<b>33.8%</b>

Note:

(1) The Community College of Baltimore County (CCBC) includes Catonsville, Dundalk and Essex.

Excludes auxiliary revenues.

(2) State support for community colleges does not include State paid benefits.

## COMMUNITY COLLEGES, UNRESTRICTED EXPENDITURES: FY 1999

INSTITUTION	INSTRUCTION	PUBLIC SERVICE	ACADEMIC SUPPORT
Allegany	\$6,938,296	\$11,161	\$2,489,595
Anne Arundel	23,978,000	0	6,005,000
Baltimore City	12,489,963	0	2,047,453
Carroll	4,492,068	0	1,711,360
Cecil	5,331,443	0	351,522
Charles	11,271,389	0	3,255,221
Chesapeake	4,276,320	42,735	1,178,105
CCBC	38,518,980	393,167	8,086,218
Frederick	9,699,926	0	940,605
Garrett	2,046,682	75,782	531,237
Hagerstown	5,909,186	137,399	1,426,839
Harford	8,898,253	0	3,112,160
Howard	14,727,510	104,700	2,514,200
Montgomery	48,637,357	0	9,583,451
Prince George's	18,727,679	0	8,888,277
Wor-Wic	3,632,125	0	1,230,410
<b>Total</b>	<b>\$219,575,177</b>	<b>\$764,944</b>	<b>\$53,351,653</b>

Note:

(1) Does not include expenditures for auxiliary enterprises.

Community College of Baltimore County (CCBC) includes Catonsville, Dundalk, and Essex.

TUITION & FEES		O T H E R		TOTAL
\$	%	\$	%	
\$7,557,601	48.3%	\$212,043	1.4%	\$15,661,860
14,286,500	32.3%	1,235,000	2.8%	44,189,000
8,577,904	28.9%	1,246,137	4.2%	29,700,337
3,755,196	35.5%	115,000	1.1%	10,591,470
2,618,226	26.7%	193,051	2.0%	9,805,368
12,884,854	48.4%	1,127,176	4.2%	26,599,691
2,659,227	27.5%	361,780	3.7%	9,667,549
29,178,687	34.3%	2,382,275	2.8%	85,039,199
7,574,447	42.0%	628,794	3.5%	18,041,615
1,599,259	27.2%	99,760	1.7%	5,878,912
5,419,928	39.7%	360,662	2.6%	13,666,000
6,368,000	31.0%	524,008	2.6%	20,529,000
11,491,886	40.0%	1,564,590	5.4%	28,755,246
37,151,000	37.3%	2,604,209	2.6%	99,581,844
20,810,000	44.9%	3,077,620	6.6%	46,381,417
2,780,128	31.8%	100,657	1.2%	8,751,000
<b>\$174,712,843</b>	<b>36.9%</b>	<b>\$15,832,762</b>	<b>3.3%</b>	<b>\$472,839,508</b>

(3) Other includes federal support and miscellaneous (investment income, income from day care, rental income).

Source: Community College Audited Budget Reports, FY 1999

STUDENT SERVICES	INSTITUTIONAL SUPPORT	OPERATION & MAINTENANCE	SCHOLARSHIPS & FELLOWSHIPS	TOTAL
\$1,446,747	\$3,026,828	\$1,524,282	\$224,951	\$15,661,860
3,464,000	6,196,000	4,546,000	0	44,189,000
3,077,394	8,673,694	4,191,267	132,285	30,612,056
935,809	2,573,313	813,920	0	10,526,470
894,759	1,801,765	1,370,489	55,390	9,805,368
1,711,323	6,116,947	2,951,402	1,293,409	26,599,691
771,757	2,130,247	1,261,856	72,556	9,733,576
7,028,725	18,247,665	9,171,627	0	81,446,382
1,825,377	2,921,633	2,236,905	209,169	17,833,615
779,530	1,811,178	614,103	20,400	5,878,912
1,366,983	3,336,233	1,489,360	0	13,666,000
1,661,199	4,175,174	2,318,214	271,000	20,436,000
2,736,201	5,242,705	2,654,700	775,230	28,755,246
11,633,885	12,468,906	18,949,379	825,000	102,097,978
5,175,686	8,354,731	5,087,044	148,000	46,381,417
533,468	2,341,979	1,013,018	0	8,751,000
<b>\$45,042,843</b>	<b>\$89,418,998</b>	<b>\$60,193,566</b>	<b>\$4,027,390</b>	<b>\$472,374,571</b>

Source: Community College Audited Budget Reports FY 1999

PUBLIC FOUR-YEAR COLLEGES/UNIVERSITIES,  
UNRESTRICTED REVENUES: FY 1999

INSTITUTION	STATE		FEDERAL	
	\$	%	\$	%
Bowie	\$16,329,669	49.2%	\$390,160	1.2%
Coppin	14,504,214	59.1%	64,985	0.3%
Frostburg	21,883,585	54.1%	0	0.0%
Salisbury	22,178,854	51.7%	0	0.0%
Towson	51,297,261	42.2%	247,035	0.2%
UB	20,509,698	49.9%	69,031	0.2%
UMB	116,411,917	48.2%	20,224,623	8.4%
UMBC	50,975,303	48.4%	3,620,921	3.4%
UMCP	273,232,092	54.6%	26,347,123	5.3%
UMES	18,537,149	62.5%	424,823	1.4%
UMUC	7,373,583	6.7%	303,882	0.3%
Morgan	38,358,243	55.9%	1,256,146	1.8%
St. Mary's	12,358,936	47.8%	37,150	0.1%
<b>Total</b>	<b>\$663,950,504</b>	<b>47.9%</b>	<b>\$52,985,879</b>	<b>3.8%</b>

PUBLIC FOUR-YEAR COLLEGES/UNIVERSITIES,  
UNRESTRICTED EXPENDITURES: FY 1999

INSTITUTION	INSTRUCTION	RESEARCH	PUBLIC SERVICE	ACADEMIC SUPPORT
Bowie	\$14,577,316	\$73,424	\$0	\$4,826,088
Coppin	9,692,898	0	0	2,138,656
Frostburg	19,720,648	0	36,896	4,122,778
Salisbury	20,336,180	174,639	0	5,004,167
Towson	49,797,395	248,752	2,547,306	15,360,690
UB	17,391,730	251,219	0	7,507,065
UMB	128,845,975	16,432,698	483,148	22,963,347
UMBC	49,091,914	4,203,723	73,382	10,790,549
UMCP	198,157,088	53,485,377	17,686,986	58,925,879
UMES	11,724,720	1,027,772	1,096	3,427,955
UMUC	45,985,876	225,075	7,821,555	13,918,628
Morgan	25,337,871	683,800	44,772	6,663,979
St. Mary's	11,046,675	19,903	527,119	1,901,990
<b>Total</b>	<b>\$601,706,286</b>	<b>\$76,826,382</b>	<b>\$29,222,260</b>	<b>\$157,551,771</b>

Note:

(1) Other includes the following: state and local grants and contracts, private gifts, sale of educational activities, endowment income, transfers, and other.

(2) Data excludes auxiliary and hospital expenditures.

Source: Governor's budget book and institutional budget request

TUITION & FEES		OTHER*		TOTAL
\$	%	\$	%	
\$15,493,200	46.6%	\$999,698	3.0%	\$33,212,727
10,000,795	40.7%	(26,184)	-0.1%	24,543,810
17,246,919	42.6%	1,327,560	3.3%	40,458,064
21,751,865	50.7%	(1,046,918)	-2.4%	42,883,801
66,550,466	54.8%	3,423,752	2.8%	121,518,514
20,824,444	50.6%	(278,985)	-0.7%	41,124,188
41,536,270	17.2%	63,115,280	26.2%	241,288,090
42,082,241	39.9%	8,696,552	8.3%	105,375,017
172,229,366	34.4%	28,927,880	5.3%	500,736,461
10,557,363	35.6%	128,536	0.4%	29,647,871
90,059,000	81.5%	12,777,059	11.6%	110,513,524
26,103,628	38.0%	2,947,360	4.3%	68,665,377
10,771,660	41.6%	2,694,962	10.4%	25,862,708
<b>\$545,207,217</b>	<b>39.3%</b>	<b>\$123,686,552</b>	<b>8.9%</b>	<b>\$1,385,830,152</b>

STUDENT SERVICES	INSTITUTIONAL SUPPORT	OPERATION & MAINTENANCE	SCHOLARSHIPS & FELLOWSHIPS	TOTAL
\$2,172,387	\$5,538,909	\$4,776,337	\$1,904,433	\$33,868,894
3,038,476	6,240,849	3,458,123	361,103	24,930,105
2,608,931	6,558,387	5,509,255	1,769,641	40,326,536
3,210,636	7,691,035	6,486,626	1,250,365	44,153,648
8,834,643	17,879,252	17,815,134	9,984,324	122,467,496
3,011,838	6,615,014	5,868,208	1,294,615	41,939,689
2,362,545	28,701,379	35,350,153	5,173,870	240,313,115
6,318,621	13,515,967	13,887,869	10,197,877	108,079,902
22,509,223	49,241,197	75,283,082	31,720,913	507,009,745
1,736,285	5,516,919	6,096,025	2,901,383	32,432,155
16,621,200	15,813,594	8,803,154	1,926,823	111,115,905
3,636,234	14,587,316	10,765,166	8,447,108	70,166,246
2,949,588	6,693,699	2,480,324	1,394,269	27,013,567
<b>\$79,010,607</b>	<b>\$184,593,517</b>	<b>\$196,579,456</b>	<b>\$78,326,724</b>	<b>\$1,403,817,003</b>

Aid to Independent Institutions: FY 1999

INSTITUTION	STATE AID AMOUNT
Baltimore International College	\$560,926
Capitol College	514,956
Goucher College	1,403,742
Hood College	1,132,383
Johns Hopkins University	13,969,880
Loyola College	4,782,126
MD Institute of Art	1,347,100
Mount St. Mary's College	1,517,465
College of Notre Dame	1,567,328
Sojourner Douglass College	510,363
St. John's College	660,171
Villa Julie College	1,736,239
Washington College	1,276,023
Western Maryland College	2,197,505
<b>Total</b>	<b>\$33,176,207</b>

Source: Maryland Higher Education Commission Joseph A. Sellinger Program

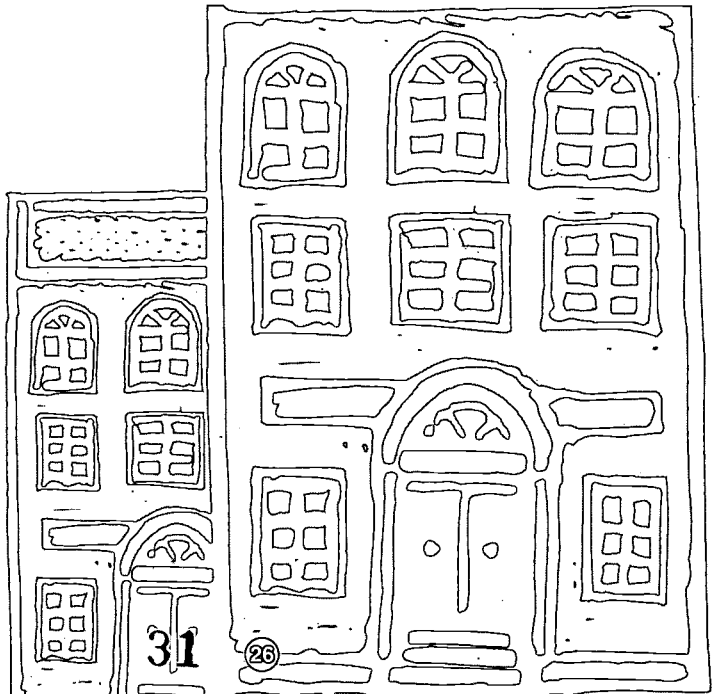

# TOTAL CAPITAL BUDGET AUTHORIZATIONS BY CAMPUS: FY 1996-2000

(IN THOUSANDS - ALL FUND SOURCES)

INSTITUTION	FY 1996	FY 1997	FY 1998	FY 1999	FY 2000	TOTAL
<b>PUBLIC FOUR-YEAR</b>						
Bowie	\$838	\$973	\$175	\$18,705	\$2,432	\$23,123
Coppin	-	-	-	-	-	0
Frostburg	-	-	-	-	388	388
Salisbury	1,519	700	1,395	-	33,243	36,857
Towson	-	522	11,077	10,860	10,221	32,680
UB	-	-	-	2,000	-	2,000
UMB	2,120	30,407	17,589	7,004	28,646	85,766
UMBC	818	778	24,721	16,873	160	43,350
UMCP	47,094	45,026	13,938	21,864	11,316	139,238
UMES	17,057	-	650	-	1,787	19,494
UMCES	875	-	14,790	2,000	-	17,665
UMBI	11,431	1,300	1,500	-	-	14,231
USM	2,300	16,500	11,904	13,735	13,945	58,384
Morgan	14,411	4,068	28,872	10,500	8,263	66,114
St. Mary's	381	4,045	1,360	-	11,000	16,786
<b>Sub-Total</b>	<b>\$98,844</b>	<b>\$104,319</b>	<b>\$127,971</b>	<b>\$103,541</b>	<b>\$121,401</b>	<b>\$556,076</b>
<b>COMMUNITY COLLEGES</b>						
Balto. City Comm. College	15,553	1,800	-	1,070	584	19,007
Community Colleges <sup>(1)</sup>	20,350	28,075	18,176	15,952	22,544	105,097
<b>Sub-Total</b>	<b>\$35,903</b>	<b>\$29,875</b>	<b>\$18,176</b>	<b>\$17,022</b>	<b>\$23,128</b>	<b>\$124,104</b>
<b>OTHER</b>						
Independent Institutions	7,700	10,100	6,000	6,000	6,000	35,800
Southern MD Higher Ed Facility	-	-	-	300	-	300
Tech for Learning	-	-	-	-	500	500
Tech. Advance. Program	5,602	325	-	-	-	5,927
Tech Enterprise Center	-	5,000	-	-	-	5,000
<b>Sub-Total</b>	<b>\$13,302</b>	<b>\$15,425</b>	<b>\$6,000</b>	<b>\$6,300</b>	<b>\$6,500</b>	<b>41,027</b>
<b>TOTAL</b>	<b>\$148,049</b>	<b>\$149,619</b>	<b>\$152,147</b>	<b>\$126,863</b>	<b>\$151,029</b>	<b>\$721,207</b>

(1) Includes \$4 million in PAYGO in FY 1996.

Source: Capital Improvements Authorized by the General Assembly, FY 1996 - FY 2000



# TUITION AND FEES

## COMMUNITY COLLEGE RESIDENT CREDIT HOUR TUITION AND FEES: SELECTED YEARS 1995-1999

INSTITUTION	FY 1995	FY 1998	FY 1999	PERCENT CHANGE	
				FIVE-YEAR	ONE-YEAR
Allegany	\$67	\$82	\$86	28%	5%
Anne Arundel	63	62	62	-1%	0%
Baltimore City	50	64	64	28%	0%
Carroll	50	71	76	52%	7%
Cecil	55	64	64	16%	0%
Charles	63	78	84	33%	8%
Chesapeake	56	68	68	21%	0%
CCBC*	n/a	66	66	n/a	0%
Frederick	66	79	79	21%	0%
Garrett	58	74	78	34%	5%
Hagerstown	65	76	76	18%	0%
Harford	62	66	66	7%	0%
Howard	78	87	89	14%	2%
Montgomery	64	80	84	30%	5%
Prince George's	81	87	92	13%	6%
Wor-Wic	54	53	55	2%	4%
<b>Average</b>	<b>\$62</b>	<b>\$72</b>	<b>\$74</b>	<b>20%</b>	<b>3%</b>

Note:

\* As of 1998, Catonsville, Dundalk, and Essex became the Community College of Baltimore County.

Source: Maryland Association of Community Colleges

PUBLIC FOUR-YEAR UNDERGRADUATE TUITION AND FEES: 1995-1999

INSTITUTION	FY 1995	FY 1996	FY 1997	FY 1998	FY 1999	PERCENT CHANGE	
						ONE-YEAR	FIVE-YEAR
<b>RESIDENTS</b>							
Bowie	\$2,814	\$3,019	\$3,103	\$3,357	\$3,467	3%	23%
Coppin	2,605	2,749	2,867	3,012	3,164	5%	21%
Frostburg	2,849	3,072	3,290	3,544	3,776	7%	33%
Salisbury	3,214	3,440	3,608	3,842	4,002	4%	25%
Towson	3,288	3,536	3,822	4,120	4,335	5%	32%
UB	3,024	3,260	3,480	3,804	3,966	4%	31%
UMB	3,423	3,571	3,800	4,013	4,174	4%	22%
UMBC	3,570	3,852	4,136	4,570	4,847	6%	36%
UMCP	3,480	3,794	4,169	4,460	4,699	5%	35%
UMES	2,741	2,855	3,036	3,240	3,585	11%	31%
UMUC	5,070	5,220	5,280	5,430	5,490	1%	8%
Morgan	2,633	2,831	3,125	3,411	3,655	7%	39%
St. Mary's	4,915	5,435	6,275	6,575	6,875	5%	40%
<b>Average</b>	<b>\$3,356</b>	<b>\$3,587</b>	<b>\$3,845</b>	<b>\$4,106</b>	<b>\$4,310</b>	<b>5%</b>	<b>28%</b>
<b>NONRESIDENTS</b>							
Bowie	\$5,542	\$6,161	\$7,026	\$7,792	\$8,290	6%	50%
Coppin	5,177	5,963	6,872	7,392	7,855	6%	52%
Frostburg	5,846	6,548	7,000	7,530	8,036	7%	37%
Salisbury	6,016	6,554	6,918	7,564	8,212	9%	37%
Towson	6,288	6,982	7,924	9,198	9,940	8%	58%
UB	5,824	6,660	8,046	9,300	10,764	16%	85%
UMB	8,708	9,094	9,483	9,939	10,361	4%	19%
UMBC	8,634	8,680	8,928	9,022	9,254	3%	7%
UMCP	9,284	9,738	10,228	10,589	11,221	6%	21%
UMES	7,401	7,536	7,646	7,777	8,227	6%	11%
UMUC	5,520	5,850	6,090	6,270	6,660	6%	21%
Morgan	5,402	6,461	7,287	7,991	8,809	10%	63%
St. Mary's	7,715	8,735	9,555	10,375	11,125	7%	44%
<b>Average</b>	<b>\$6,720</b>	<b>\$7,305</b>	<b>\$7,923</b>	<b>\$8,518</b>	<b>\$9,135</b>	<b>7%</b>	<b>36%</b>

Note:

(1) UMB reflects average of undergraduate programs.

(2) Annual tuition at UMUC assumes 30 credit hours.

Source: Governor's budget books and institutional budget requests

PUBLIC FOUR-YEAR GRADUATE CREDIT-HOUR TUITION: 1995-1999

INSTITUTION	ACTUAL					PERCENT CHANGE	
	FY 1995	FY 1996	FY 1997	FY 1998	FY 1999	ONE-YEAR	FIVE-YEAR
<b>MARYLAND RESIDENTS</b>							
Bowie	\$133	\$144	\$144	\$158	\$169	7%	27%
Coppin	112	123	129	136	140	3%	25%
Frostburg	146	156	159	168	170	1%	16%
Salisbury	123	129	140	152	158	4%	28%
Towson	148	149	159	174	187	7%	26%
UB							
Liberal Arts	163	177	198	217	233	7%	43%
Business	179	194	208	223	239	7%	34%
Law, J.D.	257	275	296	323	349	8%	36%
Law, LL.M.	315	337	364	397	397	0%	26%
UMB							
Law	277	289	303	316	337	7%	22%
Other	210	223	238	252	261	4%	25%
UMBC	218	239	231	285	299	5%	37%
UMCP	210	230	250	272	272	0%	30%
UMES	143	143	143	143	143	0%	0%
UMUC	252	260	265	273	277	1%	10%
Morgan	125	135	145	145	160	10%	28%
<b>Average</b>	<b>\$188</b>	<b>\$200</b>	<b>\$211</b>	<b>\$227</b>	<b>\$237</b>	<b>4%</b>	<b>26%</b>
<b>NONRESIDENTS</b>							
Bowie	\$218	\$244	\$244	\$268	\$304	13%	39%
Coppin	139	175	204	220	240	9%	73%
Frostburg	161	172	184	195	197	1%	22%
Salisbury	152	175	210	250	310	24%	104%
Towson	189	230	290	340	364	7%	93%
UB							
Liberal Arts	190	231	271	333	356	7%	87%
Business	210	254	283	333	356	7%	70%
Law, J.D.	425	455	500	545	589	8%	39%
Law, LL.M.	481	515	566	617	617	0%	28%
UMB							
Law	509	531	557	581	620	7%	22%
Other	378	402	429	451	468	4%	24%
UMBC	375	409	416	487	507	4%	35%
UMCP	365	375	375	400	400	0%	10%
UMES	253	253	253	253	253	0%	0%
UMUC	320	330	343	353	367	4%	15%
Morgan	190	215	240	260	286	10%	51%
<b>Average</b>	<b>\$285</b>	<b>\$310</b>	<b>\$335</b>	<b>\$368</b>	<b>\$390</b>	<b>6%</b>	<b>37%</b>

Source: Governor's budget books and institutional budget requests, FY 1995 - FY 1999

## UNDERGRADUATE: 1997-1998

## TOTAL DOLLARS

	GRANTS	LOANS	SCHOLARSHIPS	STUDENT EMPLOYMENT	TOTAL SUPPORT
Community Colleges	\$40,561,675	\$18,452,623	\$12,511,426	\$5,240,049	\$76,765,773
University System of Maryland	43,755,487	185,009,518	69,762,095	16,538,313	315,065,413
Morgan	8,014,289	21,269,249	8,898,184	1,916,198	40,097,920
St. Mary's	1,122,436	6,393,921	2,159,481	89,718	9,765,556
Independent Colleges	60,183,893	77,809,538	57,403,966	5,456,844	200,854,241
Private Career Schools	9,823,653	23,802,046	576,032	55,278	34,257,009
<b>Total</b>	<b>\$163,461,433</b>	<b>\$332,736,895</b>	<b>\$151,311,184</b>	<b>\$29,296,400</b>	<b>\$676,805,912</b>

## NUMBER OF RECIPIENTS\*

	GRANTS	LOANS	SCHOLARSHIPS	STUDENT EMPLOYMENT	TOTAL* NUMBER
Community Colleges	26,766	7,884	18,904	3,283	45,007
University System of Maryland	20,004	33,109	26,603	9,216	51,241
Morgan	3,095	3,551	2,118	727	4,915
St. Mary's	350	803	765	129	1,157
Independent Colleges	9,827	12,367	9,994	4,470	18,699
Private Career Schools	5,259	6,419	930	96	8,616
<b>Total</b>	<b>65,301</b>	<b>64,133</b>	<b>59,314</b>	<b>17,921</b>	<b>129,635</b>

\* Unduplicated

## AVERAGE AWARD PER RECIPIENT

	GRANTS	LOANS	SCHOLARSHIPS	STUDENT EMPLOYMENT	AVG. SUPPORT
Community Colleges	\$1,515	\$2,340	\$661	\$1,596	\$1,705
University System of Maryland	2,187	5,587	2,622	1,794	6,148
Morgan	2,589	5,989	4,201	2,635	8,158
St. Mary's	3,206	7,962	2,822	695	8,440
Independent Colleges	6,124	6,291	5,743	1,220	10,741
Private Career Schools	1,867	3,708	619	575	3,975
<b>State Average</b>	<b>\$2,503</b>	<b>\$5,188</b>	<b>\$2,551</b>	<b>\$1,634</b>	<b>\$5,220</b>

Source: Maryland Higher Education Commission Financial Aid Database

# GRADUATE FINANCIAL AID: 1997-1998

DOLLARS

SEGMENT	GRANTS SCHOLARSHIPS FELLOWSHIP	LOANS	STUDENT EMPLOYMENT	TOTAL SUPPORT
University System of Maryland	\$22,504,608	\$87,015,077	\$64,261,592	\$173,781,277
Morgan	683,824	918,843	310,422	1,913,089
Independent Colleges	69,407,379	44,292,669	17,468,940	131,168,988
<b>Total</b>	<b>\$92,595,811</b>	<b>\$132,226,589</b>	<b>\$82,040,954</b>	<b>\$306,863,354</b>

## NUMBER OF RECIPIENTS\*

SEGMENT	GRANTS SCHOLARSHIPS FELLOWSHIP	LOANS	STUDENT EMPLOYMENT	TOTAL NUMBER
University System of Maryland	6,683	7,303	6,677	16,095
Morgan	226	116	57	301
Independent Colleges	5,705	3,763	2,022	8,093
<b>Total</b>	<b>12,614</b>	<b>11,182</b>	<b>8,756</b>	<b>24,489</b>

\*Unduplicated

## AVERAGE AWARD PER RECIPIENT

SEGMENT	GRANTS SCHOLARSHIPS FELLOWSHIP	LOANS	STUDENT EMPLOYMENT	AVG. PER AWARD
University System of Maryland	\$3,367	\$11,914	\$9,624	\$10,797
Morgan	3,025	7,921	5,446	6,355
Independent Colleges	12,166	11,770	8,639	16,207
<b>Statewide Average</b>	<b>\$7,340</b>	<b>\$11,824</b>	<b>\$9,369</b>	<b>\$12,530</b>

Source: Maryland Higher Education Commission Financial Aid Database



# MARYLAND FINANCIAL AID PROGRAM EXPENDITURES: FY 1999

PROGRAM	DOLLARS	# AWARDS	AVG. AWARD
Educational Assistance Grant	\$27,886,060	20,179	1,382
Guaranteed Access Grant	3,899,850	718	5,431
Senatorial	5,915,000	6,320	936
Distinguished Scholar	4,216,500	1,445	2,918
Delegate	2,533,712	3,019	839
Part-Time Grant	750,000	2,285	328
Nursing Scholarship	598,799	273	2,193
Christa McAuliffe Teacher	199,119	39	5,106
Tolbert	195,880	847	231
Loan Assistance Repayment Program	188,976	51	3,705
Loan Assistance Repayment Program-PCS	991,024	8	41,292
Phy Asst./Nurse Pract	79,500	78	1,019
Distinguished Scholar - Teacher	234,000	78	3,000
Professional School	196,500	198	992
Reimbursement of Firemen	296,713	160	1,854
Conroy Memorial	150,398	53	2,838
Child Care Provider	93,250	86	1,084
Family Practice	7,500	1	7,500
Occupational & Physical Therapy	17,000	10	1,700
Health Manpower Shortage	367,010	686	537
<b>Total</b>	<b>\$48,816,791</b>	<b>36,534</b>	<b>\$1,336</b>

Source: Maryland Higher Education Commission Financial Aid Database

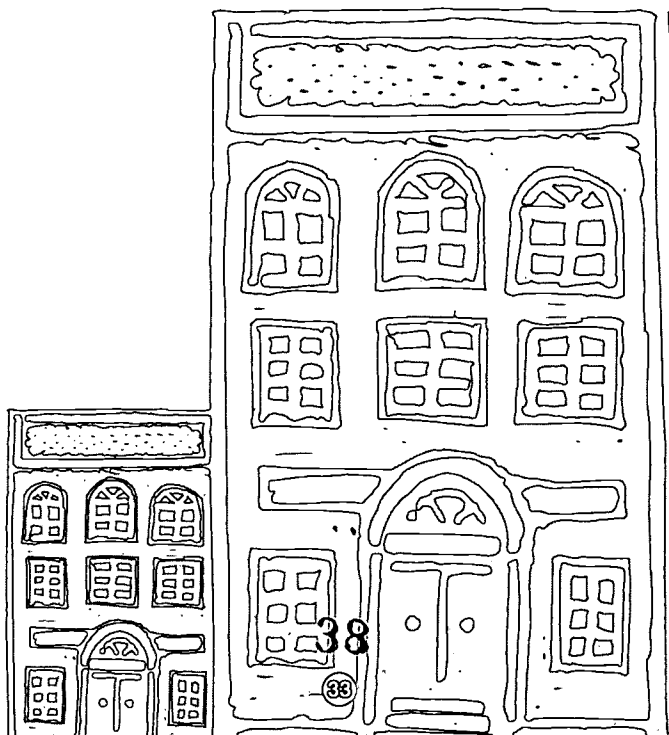

**ENROLLMENTS BY SCHOOL: 1998 ANNUAL REPORT**

NAME	SCHOOL* TYPE	NUMBER OF PROGRAMS	TOTAL ENROLLMENT**
Americare School of Allied Health-Baltimore	allied health	1	394
Americare School of Allied Health-Silver Spring	allied health	1	483
GBMC School of Radiological Technology	allied health	1	22
Adventist Health Careers Training Center	allied health	1	73
Health Training Institute	allied health	1	59
Holy Cross Hospital School of Radiological Technology	allied health	1	14
MD General Hospital School of Radiological Technology	allied health	1	15
MD Institute of Traditional Chinese Medicine	allied health	1	93
Medix School	allied health	5	800
Ultrasound Diagnostic School	allied health	2	106
Washington Adventist Hospital	allied health	1	30
American Eagle Aeronautical Academy	aviation	3	22
Academy of Professional Barber/Stylists	barbering	1	95
Avara's Academy of Hair Design	barbering	2	69
Bladensburg Barber School	barbering	2	154
International Academy of Hair Design & Tech	barbering	2	47
Maryland Barber School	barbering	1	68
Maryland Bartending Academy-Glen Burnie	bartending	1	330
Broadcasting Institute of Maryland	broadcasting	1	83
AccuTech Business Institute	business	7	487
Fleet Business School	business	7	489
Computer Institute	business/computer	1	4
Computer Learning Center	business/computer	5	1320
L'Academie de Cuisine-Gaithersburg	cooking	2	137
Aaron's Academy of Beauty	cosmetology	2	106
Adorned Nails Institute	cosmetology	1	34
Aesthetics Institute of Cosmetology	cosmetology	2	81
Aspen Beauty Academy - Silver Spring	cosmetology	2	166
Aspen Beauty Academy-Laurel	cosmetology	2	93
Award Beauty School	cosmetology	2	58
Baltimore Studio of Hair Design	cosmetology	3	169
Blades School of Hair Design	cosmetology	2	77
Chesapeake School of Makeup Artistry	cosmetology	1	8
Del-Mar-Va Beauty Academy	cosmetology	2	148
Dudley Beauty School	cosmetology	2	80
Fame School of Nail Design-Rockville	cosmetology	1	157
Gordon Phillips Beauty School-Reistertown	cosmetology	2	128
Hair Academy-New Carrollton	cosmetology	2	389
Harmon's Beauty School	cosmetology	2	20
International Beauty School- Bel Air	cosmetology	4	81
International Beauty School -Cumberland	cosmetology	4	129
International Beauty School-Glen Burnie	cosmetology	4	116
Laurel School of Hair	cosmetology	2	48
Maryland Beauty Academy - Essex	cosmetology	3	94
Maryland Beauty Academy-Owings Mills	cosmetology	3	101
Montgomery Beauty School	cosmetology	1	214
Montgomery Beauty School-II	cosmetology	2	78
New Creations Academy of Hair Design	cosmetology	2	29
Polished to Perfection	cosmetology	1	45
Reynolds Institute of Nail Design	cosmetology	1	60
Robert's Institute of Hair Design-Bel Air	cosmetology	2	113
Robert's Institute of Hair Design-Severna Park	cosmetology	2	121
Robert's Institute of Hair-Timonium	cosmetology	2	76
Von Lee International School of Aesthetics	cosmetology	2	146
Westminster Beauty School	cosmetology	2	72
Baltimore School of Dog Grooming	dog grooming	1	4
Maryland School of Dog Grooming	dog grooming	3	41
Baltimore International Institute of Electrology	electrology	1	13

NAME	SCHOOL TYPE	NUMBER OF PROGRAMS	TOTAL ENROLLMENT*
Maryland Drafting Institute	electronics/drafting	5	165
RETS Technical Training Center	electronics/drafting	9	1145
TESST Technology Institute - Baltimore	electronics/drafting	5	562
TESST Technology Institute - Beltsville	electronics/drafting	5	807
Le Millet Private Art School	fine arts	1	4
All American School of Occupational Safety and Health	HAZMAT	3	4
Baltimore School of Massage	massage	1	794
Lincoln Technical Institute	mechanics	3	1331
John Casablancas Modeling & Career Center	modeling	1	195
Institute of Advanced Montessori Studies	montessori	2	166
Maryland Center for Montessori Studies	montessori	1	18
Montgomery Montessori Institute	montessori	1	14
Washington School of Photography	photography	1	53
Maryland Institute of Criminal Justice	polygraph	1	31
Baldus Institute of Real Estate	real estate	1	15
Century 21 Real Estate School	real estate	1	122
Century 21/HT Brown Real Estate Institute	real estate	1	40
Champion Institute of Real Estate	real estate	1	358
Coldwell Banker Somers	real estate	1	27
Colquitt-Carruthers, Inc. Training Center	real estate	1	256
Diana School of Real Estate	real estate	1	26
Diplomat Real Estate Center	real estate	1	11
Ed Smith Real Estate School	real estate	1	54
First Realty Real Estate School	real estate	1	10
Frederick Academy of Real Estate	real estate	1	291
Grempler Real Estate Institute	real estate	1	642
Kelly Academy of Real Estate	real estate	1	0
Lawyers Advantage Career School	real estate	1	0
Long & Foster Institute of Real Estate	real estate	1	1,658
Mackintosh School of Real Estate	real estate	1	49
Maryland Center for Real Estate Advancement	real estate	1	31
Maryland School of Real Estate	real estate	1	5
Melbourne, Feagin & Hammersmith Real Estate Institute	real estate	1	36
Modern Real Estate School	real estate	1	28
O'Brien Institute of Real Estate	real estate	1	42
O'Connor, Piper & Flynn School of Real Estate	real estate	1	349
Professional Real Estate School	real estate	1	0
Realty Pros Institute	real estate	1	40
The Real Estate School	real estate	1	1
Top Gun Academy	real estate	1	0
Weichert Real Estate School	real estate	1	936
Widmyer Real Estate School	real estate	1	0
The Omega Studios School	recording	5	271
of Applied Recording Arts and Science			
The Sheffield Institute for the Recording Arts	recording	2	97
H&R Block Eastern Tax Services, Inc.	tax	1	1,415
Jackson Hewitt Tax School	tax	1	218
Delta School of Trades	trades	6	22
Bennett School of Travel	travel	1	36
Carlson Travel Academy	travel	1	115
Maryland School of Travel	travel	1	63
Richards Travel Career Institute	travel	1	10
Smith Travel Academy	travel	1	25
All-State Career School	truck driving	2	452
Diesel Institute of America-Grantsville	truck driving	2	370

Note:

Re enrollments for all programs June 30, 1997 - July 1, 1998  
So and Higher Education Commission Private Career School Annual Reports



NUMBER, ENROLLMENT, AND COMPLETION RATE BY SCHOOL TYPE:  
1998 ANNUAL REPORT

SCHOOL TYPE(1)	# OF SCHOOLS	ENROLLMENT(2)	COMPLETION RATE	EMPLOYMENT RATE
Allied Health	11	2,089	75%	62%
Barber	5	433	64%	*
Business/Computer	4	2,300	47%	75%
Cosmetology	31	3,237	60%	65%
Drafting/Electronics	4	2,679	52%	79%
Real Estate	29	5,027	73%	22%
Travel	5	249	93%	41%
Truck Driving	2	822	79%	80%
Other (3)	22	5,263	65%	57%
<b>Total</b>	<b>113</b>	<b>22,099</b>	<b>65%</b>	<b>64%</b>

Note:

(1) Some schools offer more than one type of program. Schools are categorized by the type of program with the majority enrollment.

(2) Represents students enrolled from June 30, 1997 - July 1, 1998.

(3) Includes aviation, bartending, broadcasting, cooking, dog grooming, electrology, fine arts and modeling, hazardous materials, massage, Montessori, mechanics, recording, polygraph, tax, and trade schools.

\*Employment figures were provided for less than half of the barber schools in 1998.

Source: Maryland Higher Education Commission Private Career Schools Annual Reports 1998

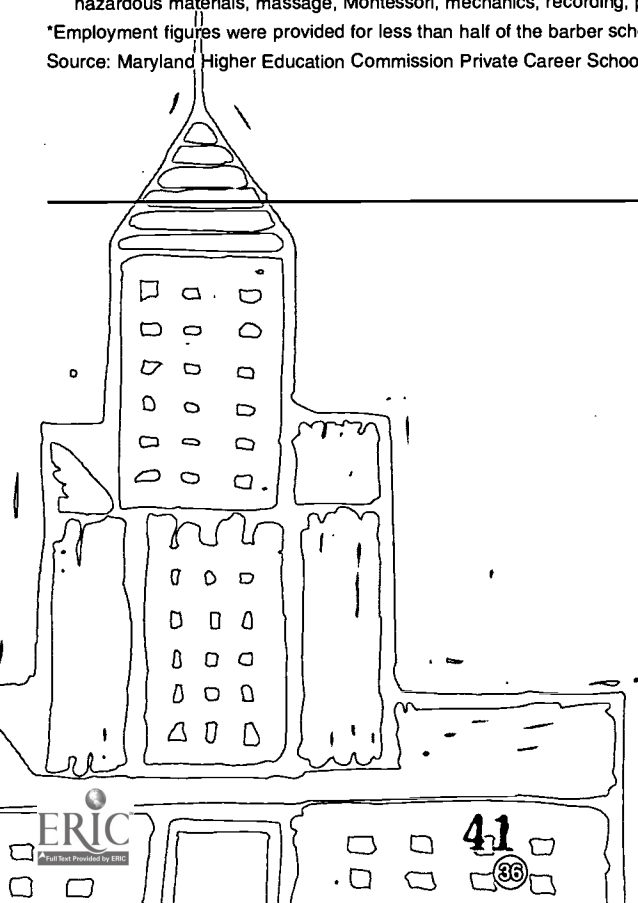



**U.S. Department of Education**  
Office of Educational Research and Improvement (OERI)  
National Library of Education (NLE)  
Educational Resources Information Center (ERIC)



## **NOTICE**

### **REPRODUCTION BASIS**



This document is covered by a signed “Reproduction Release (Blanket) form (on file within the ERIC system), encompassing all or classes of documents from its source organization and, therefore, does not require a “Specific Document” Release form.



This document is Federally-funded, or carries its own permission to reproduce, or is otherwise in the public domain and, therefore, may be reproduced by ERIC without a signed Reproduction Release form (either “Specific Document” or “Blanket”).