

DOCUMENT RESUME

ED 432 884

EF 005 513

TITLE Educational Facility Evaluations of Primary Schools in Rural Honduras: Departments of Cortes and Meambar.
INSTITUTION Council of Educational Facility Planners, International, Scottsdale, AZ.
PUB DATE 1997-00-00
NOTE 129p.
PUB TYPE Reports - Evaluative (142)
EDRS PRICE MF01/PC06 Plus Postage.
DESCRIPTORS *Educational Facilities Improvement; Elementary Education; *Elementary Schools; Foreign Countries; *Rural Schools
IDENTIFIERS Evaluation Reports; Evaluation Teams; *Honduras; *Site Visits

ABSTRACT

A team of 11 educational facility planners and architects from the United States and Canada conducted a facility evaluation of schools in the rural areas of Meambar and Cortes, Honduras. Team members were all part of the Council of Educational Facility Planners, International and traveled to Honduras under the auspices of a Christian mission group, Heart to Honduras. The purpose of the visit was threefold: to gain a greater understanding of the existing needs and conditions of primary schools; to develop an inventory of existing facilities; and to gather information that could be used to help develop a prototypical rural school facility. Presented are the observations from each school, including a rating scale evaluation of the site, exterior and interior areas, power and plumbing systems, and facility furniture. Recommendations for improving these schools are included.
(GR)

* Reproductions supplied by EDRS are the best that can be made *
* from the original document. *

Educational Facility Evaluations of Primary Schools in Rural Honduras Departments of Cortes and Meambar

U.S. DEPARTMENT OF EDUCATION
Office of Educational Research and Improvement
EDUCATIONAL RESOURCES INFORMATION
CENTER (ERIC)

This document has been reproduced as received from the person or organization originating it.

Minor changes have been made to improve reproduction quality.

Points of view or opinions stated in this document do not necessarily represent official OERI position or policy.

PERMISSION TO REPRODUCE AND DISSEMINATE THIS MATERIAL HAS BEEN GRANTED BY

T. Wall

TO THE EDUCATIONAL RESOURCES INFORMATION CENTER (ERIC)

1997

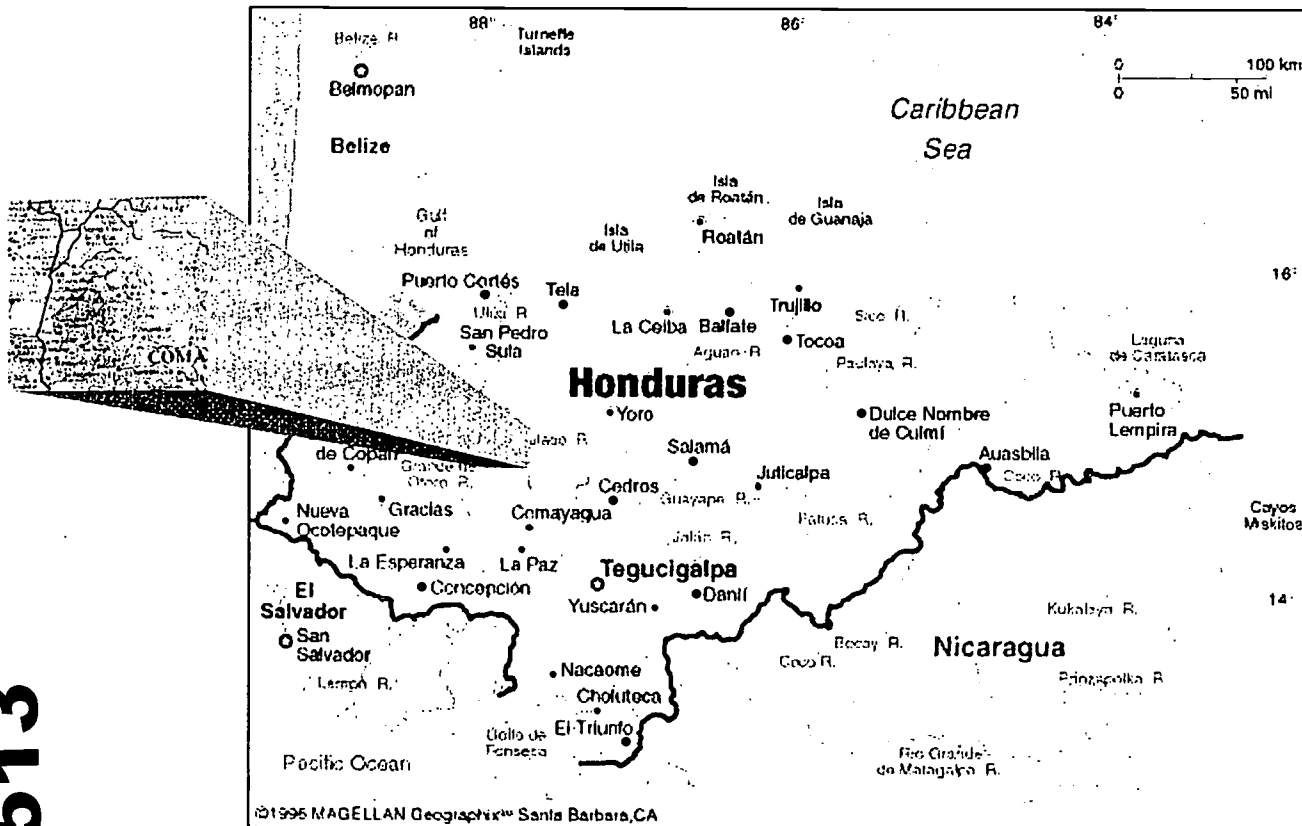

in cooperation with
Council of Educational Facility Planners, International
and
Heart to Honduras

Introduction

In April 1997, a team of eleven educational facility planners and architects from the United States and Canada conducted a facility evaluation of schools in rural Honduras, in the departments of Meambar and Cortes. Team members were all members of the Council of Educational Facility Planners, International and traveled to Honduras under the auspices of a Christian mission group, Heart to Honduras.

The purpose of the visit was threefold:

- to gain an greater understanding of existing needs and conditions;
- to begin to develop an inventory of existing facilities; and,
- to gather information that could be used to help develop a prototypical rural school facility

The evaluations and recommendations can be found on the pages that follow.

Educational Facility Planning Team

Lee Brockway,	architect	Fanning / Howey Associates, Inc., IN
Don Cross,	planner	Jefferson County Schools, CO
Bill DeJong,	planner	DeJong & Associates, Inc., OH
Ron Fanning,	architect	Fanning / Howey Associates, Inc., OH
Sam Hamilton,	architect	Hamilton and Associates, LA
Jim Jennings,	planner	Educational Planning, OR
Zack Johnson,	architect	ATS&R Architects, MN
Scott McComb,	planner	DeJong & Associates, Inc., OH
Ron McKnight,	planner	McKnight Associates, Inc., Ontario
Chuck Newman,	architect	Newman Architecture, IL
Jim Pfluger,	architect	Pfluger Associates, TX



pictured from left to right: Ron McKnight, Bill DeJong, Lee Brockway, Chuck Newman, Sam Hamilton, Jim Jennings, Ron Fanning, Don Cross, Miguel Pinell, Jim Pfluger, Zack Johnson, Scott McComb

Acknowledgements

On the behalf of the Educational Facility Planning Team , we would like to extend our appreciation to the following people and organizations:

- The Council of Educational Facility Planners, International for sponsoring and helping promote and organize the trip;
- Sra. Altagracia Sanchez, Director of Ministry of Education for the Department of Cortes, and her staff, for sharing their time, expertise and good will;
- the teachers at the schools we visited for their hospitality and insight;
- the parents and educators who attended the planning session on Thursday, April 16 in Canchias to discuss the prototype school;
- the staff of Heart to Honduras in Canchias for their hospitality and efforts to make our stay comfortable and productive;
- Sandra Pinell of Heart to Honduras, for her help translating;
- Charlie Smith and Jim Usher of Heart to Honduras for their fellowship and sharing their vision; and
- Miguel Pinell of Heart to Honduras, for his tireless and enthusiastic help making the trip so productive from start to finish

Heart to Honduras

P.O. Box 3836
Lake Wales, FL 33859-3836
(941) 638-2027

Council of Educational Facility Planners, International

8687 East Via de Ventura # 311
Scottsdale, AZ 85258
(602) 948-2337

Summary

Most of the communities served by the schools are extremely poor. In some instances, more than 50% of eligible children do not attend school for economic reasons. The children may be needed to help in the fields or take care of younger siblings at home, or cannot afford basic school supplies (pencils, pens, notebooks, etc.).

Typical rural school	1-3 classrooms restroom(s) in separate building outside water spigot limited site no playground equipment
Typical classroom	500-600 sq. ft. 30-50 multi-aged students per teacher two-student wooden benches and desks no electricity no artificial light no running water no screens very limited supplies few books no audio/visual materials

Schools were rated on a simple 100-point scale during the facility evaluation process. Since many of the schools did not have electricity and lighting and were constructed out of very simple materials, many schools were rated poorly. Some of the newer schools also received lower scores for this reason.

Recommendations

There are several recommendations that might be considered:

- 1. To improve the aesthetics of existing school facilities**
The general appearance of schools could be vastly improved by painting the buildings and making minor maintenance improvements
- 2. To expand schools where appropriate**
A number of schools operated on a split shift schedule since there were too many students for the number of classrooms and teachers available
- 3. To meet the nutritional and health needs of children and families**
The basic nutritional and health needs of children were repeatedly identified as major needs repeatedly by teachers, parents and the children themselves
- 4. To better utilize electricity, lighting and water where these services are available.**
Several of the schools had electricity but few if any outlets for audiovisual resources. Few schools had artificial lighting.
- 5. To provide adequate staff and educational materials**
The basic nutritional and health needs of children were repeatedly identified as major needs repeatedly by teachers, parents and the children themselves
- 6. To develop a model or prototype rural school facility**
A model school facility is needed that can be used by local communities, government and non-profit organizations interested in constructing new schools or improving existing new schools.
- 7. To provide teacher training**
As a result of the complexities associated with the needs of the poor, working with children in overcrowded, multi-aged environments, intensive teacher training is needed. The training is needed for seasoned teachers as well as those aspiring to teach.

Key Information about Schools Visited and Facility Rating

A simplified facility evaluation was used to rate each school. The schools visited earned from 40-59 points on a 100-point scale. Even though some schools may have been constructed within the last ten years, many lack basic amenities.

In general, all of the school facilities need improvements.

School / Community	Year Built	Building Size (sq. ft.)	Site Size (sq. ft.)	# of classrooms	# of students	# of teachers	Facility rating (out of 100 possible)
Agua Amarilla	?	626	?	1	31	1	57
El Aguaje	1983	815	11,644	1	46	1	48
Bartolo	1990	910	30,760	2	102	2	47
Canchias	?	650	31,943	1	41	1	40
Las Casitas	1993	1,533	13,962	3	105	2	48
Las Delicias	1981	2,481	75,855	3	111	3	53
Los Globos	1983	980	14,880	1	53	1	54
Montañuela	1983	485	24,025	1	33	1	48
San Isidro Christian	1991/ 1993	838	15,866	2	76	2	43/ 53
San Isidro	1957 +	3,069	56,070	6	196	4	55
La Victoria	1992	1,395	95,000	3	103	2	50

Canchias Primary School

Canchias Primary School

Community: Canchias

Date of Evaluation: April 14, 1997
Name of Evaluator: Ron McKnight

The teacher's name is Sra. Ariceli Avela. 41 students are enrolled in the school: 22 boys and 19 girls, from grades 1 to 6. Average daily attendance is about 39 students. The different ages of the students require that the students engage in peer teaching. While the teacher gave lessons to the first and second graders, the third, fourth, fifth and sixth graders worked in small groups led by a student with a teacher's manual. The school year runs from February to November and the school day runs from 8:00 a.m. to 11:00 a.m. and from 1:00 p.m. to 3:00 p.m.

The school building was built prior to Sra. Avela's arrival in Canchias 16 years ago. The wooden trusses are decorated and there are some posters on the walls. The space is very crowded and lacks storage. The classroom is poorly lit. The open windows and doors on north and south side of the building do not admit much light and the light that comes from the open truss at the east end of the building is blocked by dark wood trusses and the decorations on the trusses.

The building is near the road leading into Canchias and is surrounded by a small field enclosed by barb wire. The site is too small for an adequate play area.

According to Sra. Avela, the biggest challenges facing the school are the students' lack of food and medicine. She notes that many school-aged children live in the area, but do not attend school because their parents cannot afford to feed or clothe them, much less supply them with the basic materials for formal education. She laments that economics will determine how far students will be able to go.

When asked how the ideal school would differ from the current school, the students said there would be more students, books and space. The teacher said the classroom would be bigger and lighter, it would be better equipped and the students would wear uniforms.

School Profile

Grades Housed			1-6
Enrollment			
grade	boys	girls	total
1	10	7	17
2	5	2	7
3	2	4	6
4	2	3	5
5	1	1	2
6	2	2	4
total	22	19	41
Building Area			650 sq. ft.
Site Size			31,943 sq. ft.
Date of Construction/Renovation			Before 1980
Number of Classrooms			1
Capacity			40
Type of Building Material			
Floor			concrete
Roof			clay tile
Walls (exterior)			adobe (plaster)
Walls (interior)			adobe (plaster)
Ceiling			n/a (open)

Canchias Primary School

1 (low) to 5 (high)

CHARACTERISTIC	Condition Rate 1-5	REMARKS
FACILITY - SITE:		
Condition	3	natural, flat
Location	4	
Signage	1	no signage
FACILITY - EXTERIOR:		
Walls	2	front: smoothed; sides, back: cracking
Windows/Frames	3	one window
Roof	4	recently replaced, some structural issues
Doors	3	3 doors, frames adequate, 1 w/o sill
FACILITY - INTERIOR:		
Floors	3	good
Walls	3	good
Ceilings	1	open beam
Lighting	1	poor natural light (decorations block)
Doors	3	
Storage	1	books piled in back
Restrooms	1	door off hinges, outdoor
FACILITY - SYSTEMS:		
Electrical System	1	none
Lighting - Natural	1	
Lighting - Artificial	1	none
Plumbing System	1	water in yard, none inside
FACILITY - FURNITURE:		
Furniture	2	old, but not in disrepair; 2 student desk allows little flexibility
Equipment	1	Three 8' portable blackboards, 1 small bookcase
TOTAL	40	Possibility of 100

Recommendations	
<i>check one</i>	
	Building is adequate
	Building needs renovation
✓	Building needs to be expanded
✓	Building should be replaced
<p><i>Comments:</i></p> <p>Consider replacing school with larger structure on larger site.</p>	

Facility Comments:

Site:

- Site is limited.
- Site is adequate.

- No play area
- Limited outdoor play area.
- The outdoor play area is adequate.

- The landscaping, playground equipment, and fencing have been recently updated.
- The landscaping, playground equipment, and fencing are not satisfactory.

- Grounds need new landscaping, and fencing.
- Landscaping and fencing are adequate.

- There is no exterior signage for the school buildings and grounds.
- Exterior signage is adequate.

Facility - Exterior:

- Exterior walls need repair.
- Exterior walls are in good condition.

- No windows
- Windows have been recently replaced.
- Windows are in good condition, but inadequate number

- Roof has leaking problems that are beginning to cause interior and exterior damage.
- Roof has been recently replaced.
- Roof is in good condition.

- Exterior doors are in poor condition.
- Exterior doors have been recently replaced.
- Exterior doors are in good condition.

Facility - General:

Walls

- Walls need to be repaired and repainted.
- Walls are in good condition.

Lighting

- Lighting needs to be replaced.
- Lighting is adequate.
- Lighting is inadequate.

Signage

- There is no signage for the building.
- Signage is adequate.

Painting

- Entire building should be painted.
- The building has been recently painted.

Storage

- There are limited storage and work areas.
- There are no storage and work areas.
- There are adequate storage and work areas.

Restrooms

- Restrooms are indoors.
- Restrooms are outdoors.

Plumbing

- There is no running water.
- There is running water outdoors.
- There is indoor plumbing.

Facility - Educational Areas:

Furniture and Equipment

- Most furniture and equipment are outdated and need to be replaced.
- Most furniture and equipment have been recently replaced.
- Most furniture and equipment are adequate.

Electrical

- There is no electricity
- There is electricity. There are ____ outlets available for educational use.
- There is phone service. There are ____ telephones available for educational use.
- There is no phone service.

Kitchen

- There is a kitchen..... used infrequently (milk storage during most of the year; used as kitchen for most of the year.)
- There is no kitchen

Additional Comments:

The recently replaced roof is sagging.

Recommend additional teaching space; the current space does not allow space for additional supplies or program delivery options. Improve lighting. Lavatory needs to be replaced (at the very least the hinges should be put back on the door).

Canchias Primary School

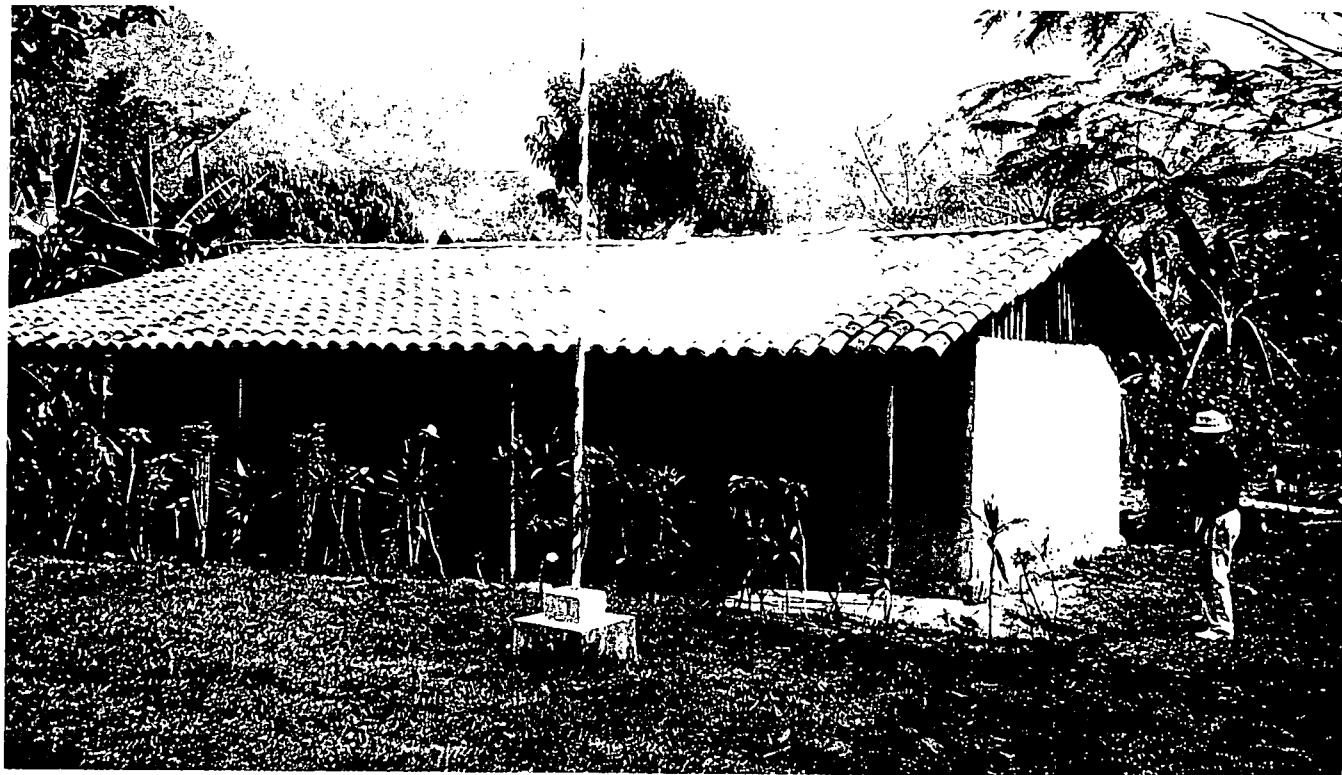

Lanchias School



Site area = 31,943 s.f.

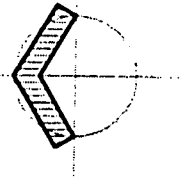

233 ft.

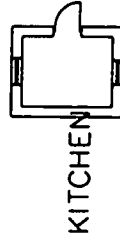
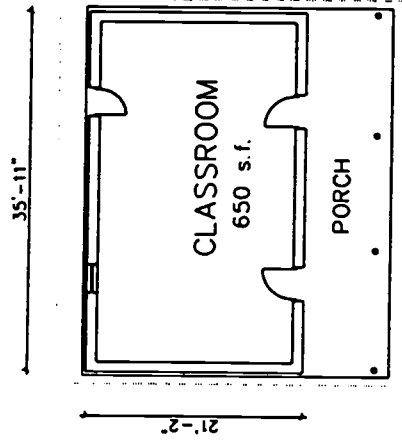

Flagpole



Boundary

230 ft.

BEST COPY AVAILABLE

91 ft.
Boundary

68 ft.

Boundary

18

17

Agua Amarilla Primary School

Agua Amarilla Primary School

Community: Agua Amarilla

Date of Evaluation: April 17, 1997
Name of Evaluator: Zack Johnson

One teacher is responsible for grades 1-6, so the school operates on a split shift. The morning shift runs from 8:00 - 11:00; the afternoon shift operates from 1:00 - 4:00. The school year begins in February and ends in November. 39 students are enrolled in the school; average daily attendance is about 90%. The day we visited, there were many younger children in the classroom who had not matriculated, but still attended class.

The site is ample. Though the school building is close to the road, the fields behind the school are level and large. There is space for an educational garden where students in all grades learn agricultural skills. The classroom space was ample and was in relatively good condition, though the dark green paint on the interior walls made the room seem darker.

According to the teacher, the biggest challenges facing the school are the students' tardiness, significant student migration and the poverty of the parents and the area. Further, there is not much collaboration with the parents. The parents are interested in educating their children, the parents lack money to consistently feed their children, much less provide them with educational materials.

School Profile

Grades Housed				1-6	
Enrollment					
Grade	girls	boys	total a.m. 8:00 -11:30	total p.m. 1:00 - 4:00	Total
1	7	5	12	0	12
2	7	5	0	12	12
3	2	2	4	0	4
4	0	1	0	1	1
5	1	0	0	1	1
6	0	1	0	1	1
TOTAL	17	14	16	15	31
Building Area					
Site Size					
Date of Construction/Renovation			?		
Number of Classrooms			2 (1 unused)		
Capacity			80 – 90 students		
Type of Building Material					
Floor			exposed concrete		
Roof			corrugated, cementitious panels		
Walls (exterior)			painted concrete block, stucco		
Walls (interior)			painted concrete block, stucco		
Ceiling			wood		

Agua Amarilla Primary School
1 (low) to 5 (high)

CHARACTERISTIC	Condition Rate 1-5	REMARKS
FACILITY - SITE:		
Condition	3	
Location	4	students live nearby; site has a large flat field in which children can play
Signage	3	
FACILITY - EXTERIOR:		
Walls	3	
Windows/Frames	4	
Roof	4	
Doors	3	
FACILITY - INTERIOR:		
Floors	3	exposed concrete
Walls	5	painted
Ceilings	5	wood
Lighting	1	none
Doors	3	
Storage	3	using old classroom
Restrooms	3	3 exterior w.c.: niñas, maestro, varones
FACILITY - SYSTEMS:		
Electrical System	1	none available
Lighting - Natural	3	back: 6 windows; front: 2 doors, 2 windows
Lighting - Artificial	1	no artificial lighting
Plumbing System	3	One yard hydrant
FACILITY - FURNITURE:		
Furniture	3	painted 2-seaters
Equipment	1	none
TOTAL	57	Possibility of 100

Recommendations

check one

<input type="checkbox"/>	Building is adequate
<input checked="" type="checkbox"/>	Building needs renovation
<input type="checkbox"/>	Building needs to be expanded
<input type="checkbox"/>	Building should be replaced

Comments:

General improvements needed.

Facility Comments:

Site:

- Site is limited.
- ✓ Site is adequate.

- Limited outdoor play area.
- ✓ The outdoor play area is adequate.

- Grounds need new landscaping, and fencing.
- ✓ Landscaping and fencing are adequate.

- There is no exterior signage for the school buildings and grounds.
- ✓ Exterior signage is adequate.

Facility - Exterior:

- Exterior walls need repair.
- ✓ Exterior walls are in good condition.

- No windows
- Windows have been recently replaced.
- ✓ Windows are in good condition.

- Roof has leaking problems that are beginning to cause interior and exterior damage.
- Roof has been recently repaired.
- ✓ Roof is in good condition.

- Exterior doors are in poor condition.
- Exterior doors have been recently replaced.
- ✓ Exterior doors are in good condition.

Facility - General:

Walls

- Walls need to be repaired and repainted.
- ✓ Walls are in good condition.

Lighting

- Lighting needs to be replaced.
- Lighting is adequate.
- Lighting is inadequate.
- Natural lighting is adequate.

Signage

- There is no signage for the building.
- Signage is adequate.

Painting

- Entire building should be painted.
- The building has been recently painted.

Storage

- There are limited storage and work areas.
- There are no storage and work areas.
- There are adequate storage and work areas in adjacent unused classroom.

Restrooms

- Restrooms are indoors.
- Restrooms are outdoors.

Plumbing

- There is no running water.
- There is running water outdoors.
- There is indoor plumbing.

Facility - Educational Areas:

Furniture and Equipment

- Most furniture and equipment are outdated and need to be replaced.
- Most furniture and equipment have been recently replaced.
- Most furniture and equipment are adequate.

Electrical

- There is no electricity
- There is electricity. There are ____ outlets available for educational use.

- There is phone service. There are ____ telephones available for educational use.
- There is no phone service.

Kitchen

- There is a kitchen
- There is no kitchen

Additional Comments:

There is a large, level playing field in the back of the building. Part of the field is used as an instructional garden area. A barb wire fence surrounds the site. There are two classrooms on the site, both very near the road. Only one of the classrooms is used; the older, smaller classroom is used for storage.

Agua Amarilla Primary School



Agua Amarilla School

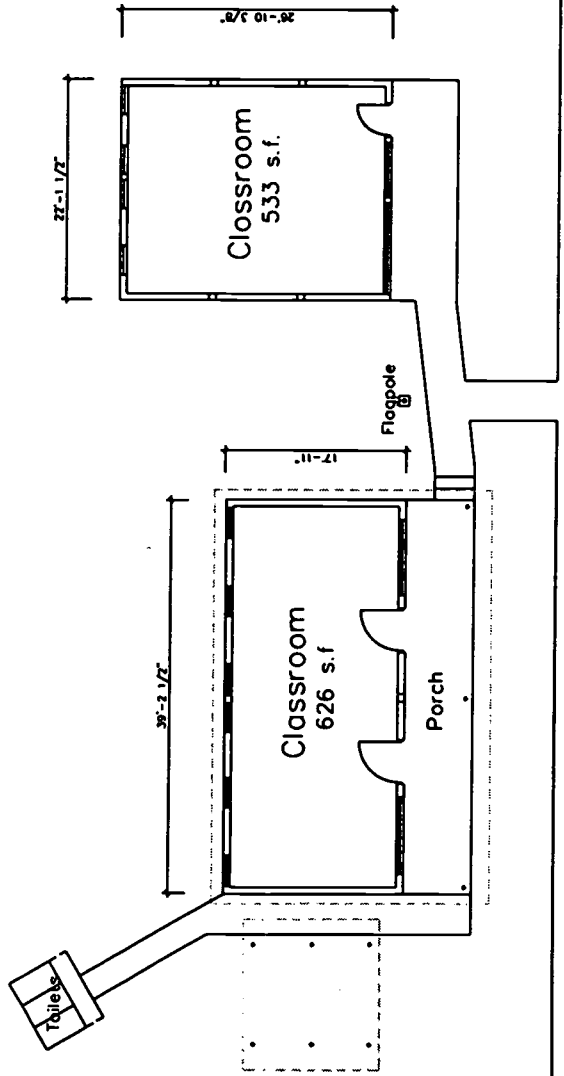

El Aguaje Primary School

El Aguaje Primary School

Community: El Aguaje

Date of Evaluation: April 15, 1997

Name of Evaluator: Jim Jennings

The day of the visitation, we learned the teacher abruptly quit the previous day. According to the people who live near the school, they had no idea the teacher was going to quit. Since there was no teacher, there was no school that day. As a result, most of these notes were from interviews with neighbors and some of the children. Supposedly, a new teacher was to start the next day.

- There are approximately 51 students enrolled. However, when asked how many students were in each grade, student enrollment only added up to 46. We are guessing the number is wrong for second grade.
- The community is very poor. There were a number of kids not wearing clothing, while others had clothing but no shoes. In general, good hygiene was lacking. Although there is water in the village, there is also a lot of poverty.
- This building is identical to Los Globos and Montañuela. It was constructed in 1983. Like Los Globos, the old school is still there and probably used as a home for the teacher and for storage.
- Limited space, insufficient supplies and lack of equipment are the biggest challenges facing the school

School Profile

Grades Housed		1-6
Enrollment.		
Grade	Number of Students	
1	17	
2	5	
3	8	
4	8	
5	4	
6	4	
TOTAL	46 (estimate)	
Building Area*		815 sq. ft.
Site Size		11,644 sq. ft.
Date of Construction/Renovation		1983 – newer portion ???? – older portion
Number of Classrooms		1
Capacity		40
Type of Building Material		
Floor	exposed concrete	
Roof	metal	
Walls (exterior)	brick	
Walls (interior)	plaster	
Ceiling	open - metal	

* The old classroom is no longer used for teaching. It is currently used for storage and as a residence for the teacher.

BEST COPY AVAILABLE

32

El Aguaje Primary School

1 (low) to 5 (high)

CHARACTERISTIC	Condition Rate 1-5	REMARKS
FACILITY - SITE:		
Condition	2	
Location	3	
Signage	1	none
FACILITY - EXTERIOR:		
Walls	3	brick
Windows/Frames	3	open
Roof	3	metal - no gutters
Doors	3	wood
FACILITY - INTERIOR:		
Floors	3	concrete
Walls	2	plaster
Ceilings	3	open
Lighting	3	natural lighting
Doors	3	no internal doors
Storage	3	built-in bookcase
Restrooms	2	exterior
FACILITY - SYSTEMS:		
Electrical System	1	none available
Lighting - Natural	4	good
Lighting - Artificial	1	none available
Plumbing System	1	
FACILITY - FURNITURE:		
Furniture	3	26 2-student tables, appears 5 are used for storage
Equipment	1	
TOTAL	48	Possibility of 100

Recommendations

check one

<input type="checkbox"/>	Building is adequate
<input checked="" type="checkbox"/>	Building needs renovation
<input type="checkbox"/>	Building needs to be expanded
<input type="checkbox"/>	Building should be replaced
<p><i>Comments:</i></p> <p>General improvements need to be made.</p>	

Facility Comments:

Site:

- Site is limited.
- Site is adequate.

- Limited outdoor play area.
- The outdoor play area is adequate.

- The landscaping, playground equipment, and fencing have been recently updated.
- The landscaping, playground equipment, and fencing are satisfactory.
- No play area or play equipment.

- Grounds need new landscaping, and fencing.
- Landscaping and fencing are adequate.

- There is no exterior signage for the school buildings and grounds.
- Exterior signage is adequate.

Facility - Exterior:

- Exterior walls need repair.
- Exterior walls are in good condition.

- No windows
- Windows have been recently replaced.
- Windows are in good condition.

- Roof has leaking problems that are beginning to cause interior and exterior damage.
- Roof has been recently repaired.
- Roof is in good condition.

- Exterior doors are in poor condition.
- Exterior doors have been recently replaced.
- Exterior doors are in good condition.

Facility - General:

Walls

- Walls need to be repainted.
- Walls are in good condition.

Lighting

- Lighting needs to be replaced.
- Lighting is adequate.
- Lighting is inadequate.
- Natural light is adequate.

Signage

- There is no signage for the building.
- Signage is adequate.

Painting

- Entire building should be painted.
- Parts of the building need painting.
- The building has been recently painted.

Storage

- There are limited storage and work areas.
- There are no storage and work areas.
- There are adequate storage and work areas.

Restrooms

- Restrooms are indoors.
- Restrooms are outdoors.

Plumbing

- There is no running water.
- There is running water outdoors.
- There is indoor plumbing.

Facility - Educational Areas:

Furniture and Equipment

- Most furniture and equipment are outdated.
- Most furniture and equipment have been recently replaced.
- Most furniture and equipment are adequate.

Electrical

- There is no electricity
- There is electricity. There are ____ outlets available for educational use.
- There is phone service. There are ____ telephones available for educational use.
- There is no phone service.

Kitchen

- There is no kitchen.
- There is a kitchen.

El Aguaje Primary School

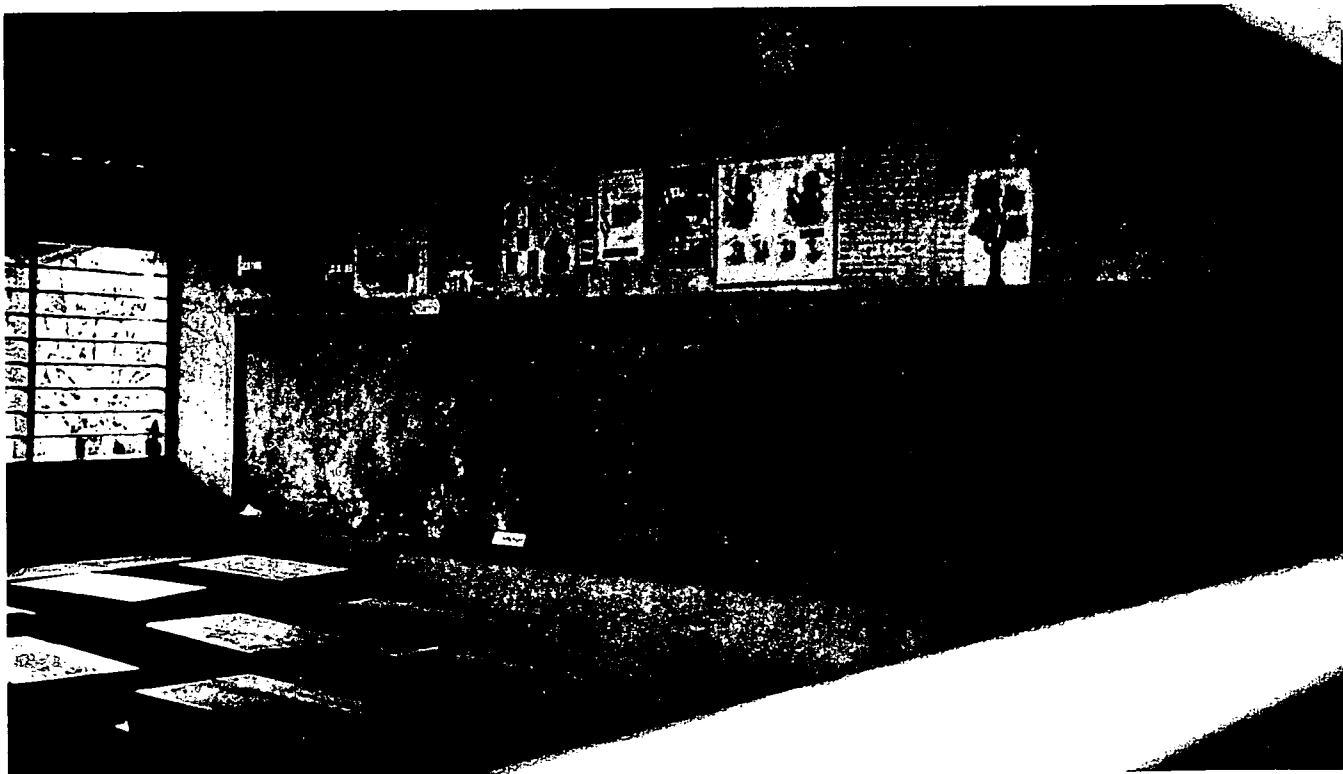

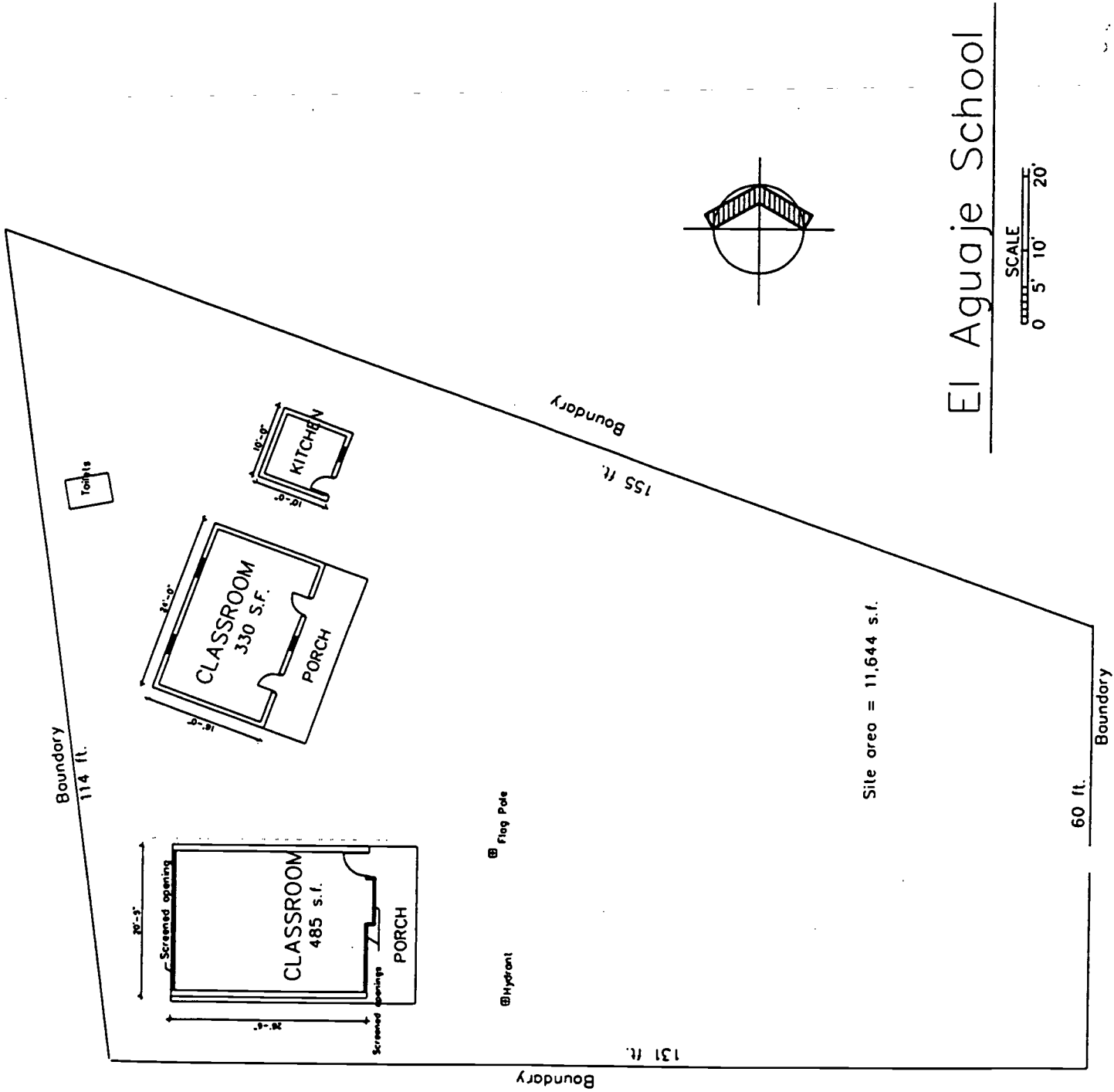

El Aguaje School

SCALE
0 5' 10' 20'

Street

Bartolo Primary School

Bartolo Primary School

Community: Bartolo

Date of Evaluation: April 16, 1997
Name of Evaluator: Ron McKnight

The following are some general notes regarding the school:

- ◆ This was a two-room school constructed in 1990.
- ◆ The school is run as a split session with grades 2,3, & 4 attending in the morning and grades 1,5, & 6 in the afternoon. The morning grades had one teacher and approximately 60 students. The teacher had a separate classroom for grade 2 [28 students] and grade 3 [27 students] and grade 4 [7 students] met outside under a tree. Grade 4 meets unless it rains. The teacher moved between all three groups, spending most of his time with grades 2 & 3. Grade 4 had a student who served as the lead and does a fair amount of peer tutoring.
- ◆ The school day ran from 7 - 11:30 a.m. in the morning shift and from 12-5 p.m. for the afternoon shift.
- ◆ The total school population was 102 students. With only two small classrooms, it was not possible to have all of the children at school at the same time.
- ◆ There is a teacher for the morning group and another teacher for the afternoon group.
- ◆ The classroom arrangement was a major problem. The teacher indicated he would be much better off with one large learning center of approximately. 1500 sq. ft.
- ◆ There was a general lack of audio-visual aids.
- ◆ There was electricity in this building but no equipment. The teacher indicated he would occasionally bring in his own TV.
- ◆ The biggest challenges facing the school are a Lack of teachers, lack of space and the quality of space

School Profile

Grades Housed				1-6	
Enrollment					
Grade	boys	girls	total a.m. 7:00 - 11:30	total p.m. 12:00 - 5:00	Total
1	11	9	0	20	20
2	11	17	28	0	28
3	15	12	27	0	27
4	3	4	7	0	7
5	8	6	0	14	14
6	4	2	0	6	6
TOTAL	52	50	62	40	102
Building Area				910 sq. ft.	
Site Size				30,760 sq. ft.	
Date of Construction/Renovation				1990	
Number of Classrooms				2	
Capacity				80	
Type of Building Material					
Floor				exposed concrete	
Roof				wood truss; corrugated transite	
Walls (exterior)				adobe(?), stucco finish	
Walls (interior)				adobe(?), stucco finish	
Ceiling				open truss	

Bartolo Primary School

1 (low) to 5 (high)

CHARACTERISTIC	Condition Rate 1-5	REMARKS
FACILITY - SITE:		
Condition	4	soccer field across road
Location	3	students walk from 10 min - 3 hrs
Signage	3	painted on building
FACILITY - EXTERIOR:		
Walls	3	some cracks in stucco, painted green
Windows/Frames	3	chain link on wood frame
Roof	2	cracks in transite
Doors	2	wood
FACILITY - INTERIOR:		
Floors	3	
Walls	3	painted green
Ceilings	1	open ceiling
Lighting	2	single incandescent exposed lamp
Doors	3	
Storage	1	small cabinet
Restrooms	2	outdoors
FACILITY - SYSTEMS:		
Electrical System	2	limited
Lighting - Natural	3	smaller openings at rear
Lighting - Artificial	2	only one light bulb
Plumbing System	2	outdoor only
FACILITY - FURNITURE:		
Furniture	2	wood, 2-student desks
Equipment	1	none available
TOTAL	47	Possibility of 100

Recommendations

check one

<input type="checkbox"/>	Building is adequate
<input checked="" type="checkbox"/>	Building needs renovation
<input checked="" type="checkbox"/>	Building needs to be expanded
<input type="checkbox"/>	Building should be replaced

Comments:

With the availability of running water and electricity might be renovated and expanded. The school needs additional classrooms and support areas.

Facility Comments:

Site:

- Site is limited.
- Site is adequate.

- Limited outdoor play area.
- The outdoor play area is adequate.

- The landscaping, playground equipment, and fencing have been recently updated.
- The landscaping and fencing are satisfactory. Additional primary and junior play equipment needed

- Grounds need new landscaping, and fencing.
- Landscaping and fencing are adequate.

- There is no exterior signage for the school buildings and grounds.
- Exterior signage is adequate.

Facility - Exterior:

- Exterior walls need repair.
- Exterior walls are in good condition.

- Roof has leaking problems that are beginning to cause interior and exterior damage.
- Roof has been recently repaired.
- Roof is in good condition.

- Exterior doors are in poor condition.
- Exterior doors have been recently replaced.
- Exterior doors are in good condition.

Facility - General:

Walls

- Walls need to be repaired and repainted.
- Walls are in good condition.

Lighting

- Lighting needs to be replaced.
- Lighting is adequate.
- Lighting is inadequate.

Signage

- There is no signage for the building.
- Signage is adequate.

Painting

- Entire building should be painted. Lighter colors should be used to better take advantage of natural light.
- The building has been recently painted.

Storage

- There are limited storage and work areas.
- There are no storage and work areas.
- There are adequate storage and work areas.

Restrooms

- Restrooms are indoors.
- Restrooms are outdoors.

Plumbing

- There is no running water.
- There is running water outdoors.
- There is indoor plumbing.

Facility - Educational Areas:

Furniture and Equipment

- Most furniture and equipment are outdated and need to be replaced.
- Most furniture and equipment have been recently replaced.
- Most furniture and equipment are adequate.

Electrical

- There is no electricity
There is electricity. There are 1-3 outlets available for educational use.
- There is phone service. There are ___ telephones available for educational use.
There is no phone service.

Kitchen

- There is a kitchen
There is no kitchen

Additional Comments:

Some children come from far away: one child walked for over 3 hours to get to school.

Bartolo Primary School

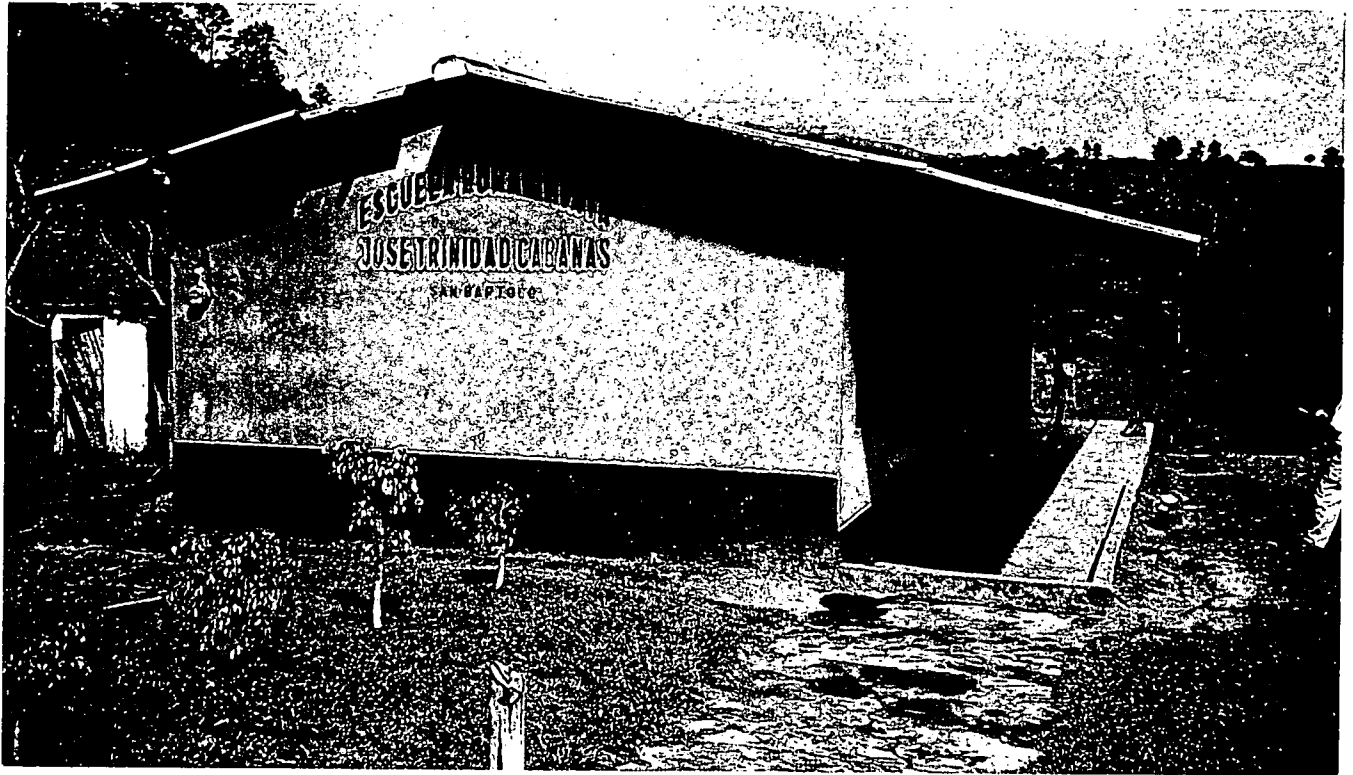

approx. 300 ft.

Boundary

51

BARTOLA SCHOOL

Site area = 30,760 s.f.

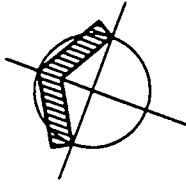
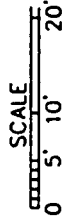

Flagpole

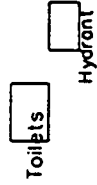
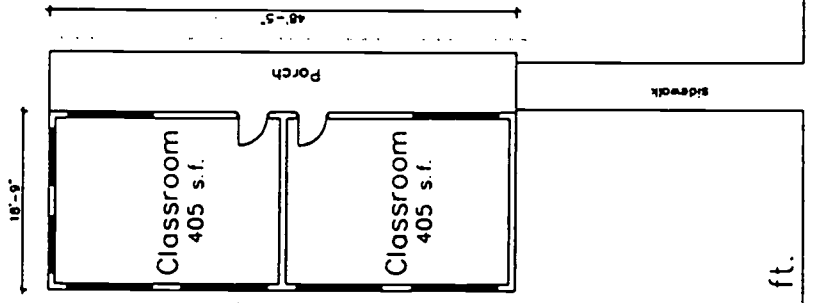

180 ft.

300 ft.

Boundary

Boundary

Street

50

Las Casitas Primary School

Las Casitas Primary School

Community: Casa Viejas (Las Casitas)

Date of Evaluation: April 15, 1997
Name of Evaluator: Ron McKnight

There are two teachers who work with 107 students in 2 classrooms; a third classroom sits vacant. The teacher with whom we spoke has 23 years of teaching experience and teaches the 1st and 6th grade. The school is at the north east edge of the attendance boundary and serves a largely agrarian population, though there are several students whose parents own plantations or are professionals.

The challenges facing this school are similar to those at other rural schools, i.e., the lack of supplies and adequate nutrition for the students. The teacher mentioned other challenges as well: lack of student motivation, little help from parents, etc.

The yard was well-maintained, landscaped and fenced. Every year, the 6th graders and their parents engage in a school improvement project, e.g., installing a new gate, landscaping, etc. The physical appearance of the school is further improved by periodic donations from local coffee plantation owners who give gifts to the school in return for the teachers' help recruiting seasonal workers from the ranks of their former students.

School Profile

Grades Housed		1-6	
Enrollment			
Grade	boys	girls	total
1	25	18	43
2	12	14	26
3	7	12	19
4	3	9	12
5	2	3	5
6	0	0	0
TOTAL	49	56	105
Building Area		1,533 sq. ft.	
Site Size		13,962 sq. ft.	
Date of Construction/Renovation		1993	
Number of Classrooms		3	
Capacity		120	
Type of Building Material			
Floor		exposed concrete	
Roof		truss	
Walls (exterior)		concrete frame, painted concrete block infill	
Walls (interior)		painted exposed concrete block	
Ceiling		cementitious board (20"x40")	

Las Casitas
1 (low) to 5 (high)

CHARACTERISTIC	Condition Rate 1-5	REMARKS
FACILITY - SITE:		
Condition	4	separated play area
Location	3	north edge of town (4 km ² area)
Signage	1	no signage
FACILITY - EXTERIOR:		
Walls	4	concrete frame, painted concrete block infill
Windows	3	no windows, horizontal bars and 1/4" mesh
Roof	4	cement board
Doors	2	
FACILITY - INTERIOR:		
Floors	3	exposed concrete
Walls	4	exposed painted concrete block
Ceilings	4	cement board
Artificial Lighting	1	natural lighting only
Doors	2	
Storage	1	small book shelf
Restrooms	1	restrooms outdoors
FACILITY - SYSTEMS:		
Electrical System	1	no electricity
Lighting - Natural	3	green paint makes room appear darker
Lighting - Artificial	1	
Plumbing System	2	water supply at restrooms
FACILITY - FURNITURE:		
Furniture	2	old wood, 2-student bench at each desk
Equipment	1	
TOTAL	48	Possibility of 100

Recommendations	
<i>check one</i>	
<input type="checkbox"/>	Building is adequate
<input checked="" type="checkbox"/>	Building needs improvement
<input type="checkbox"/>	Building needs to be expanded
<input type="checkbox"/>	Building should be replaced
<p><i>Comments:</i></p> <p>Even though this is a newer building, the school lacks many things such as furniture, equipment, electricity, storage, etc.</p>	

Facility Comments:

Site:

- Site is limited.
- Site is adequate.

- Limited outdoor play area.
- The outdoor play area is adequate.

- The landscaping, playground equipment, and fencing have been recently updated.
- The landscaping, playground equipment, and fencing are satisfactory.
- There is no landscaping or playground equipment

- Grounds need new landscaping, and fencing.
- Fencing are adequate.

- There is minimal exterior signage for the school buildings and grounds.
- Exterior signage is adequate.

Facility - Exterior:

- Exterior walls need repair.
- Exterior walls are in good condition, but need painting

- No windows
- Windows have been recently replaced.
- Windows are in good condition.

- Roof has leaking problems that are beginning to cause interior and exterior damage.
- Roof has been recently repaired.
- Roof is in good condition.

- Exterior doors are in poor condition.
- Exterior doors have been recently replaced.
- Exterior doors are in good condition.

Facility - General:

Walls

- Walls need to be repaired and repainted.
- Walls are in good condition.

Artificial Lighting

- Lighting needs to be replaced.
- Lighting is adequate.
- Lighting is inadequate.
- There is no artificial lighting

Signage

- There is minimal signage for the building.
- Signage is adequate.

Painting

- Entire building (interior and exterior) should be painted.
- The building has been recently painted.

Storage

- There are limited storage and work areas.
- There are no storage and work areas.
- There are adequate storage and work areas.

Restrooms

- Restrooms are indoors.
- Restrooms are outdoors.

Plumbing

- There is no running water.
- There is running water outdoors.
- There is indoor plumbing.

Facility - Educational Areas:

Furniture and Equipment

- Most furniture and equipment are outdated and need to be replaced.
- Most furniture and equipment have been recently replaced.
- Most furniture and equipment are adequate.

Electrical

- There is no electricity
- There is electricity. There are ____ outlets available for educational use.
- There is phone service. There are ____ telephones available for educational use.
- There is no phone service.

Kitchen

- There is a kitchen
- There is no kitchen, though one has been proposed. The Catholic Church provides soy milk for students on Monday, Wednesday and Fridays.

Additional Comments:

Nearby coffee plantation owner exchanges school improvement projects (e.g., columns for canopy) in exchange for the teachers' help locating workers (former students) during the coffee harvest.

The patranota's office is directly behind the school.

Las Casitas Primary School

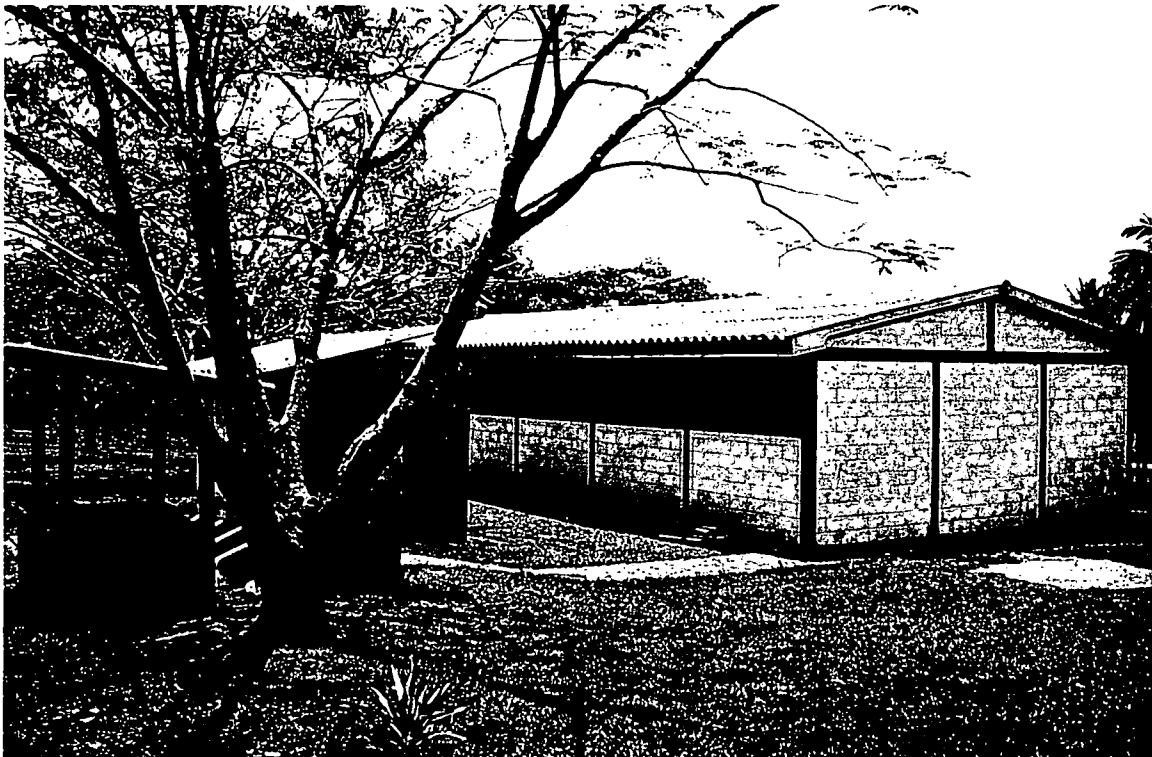
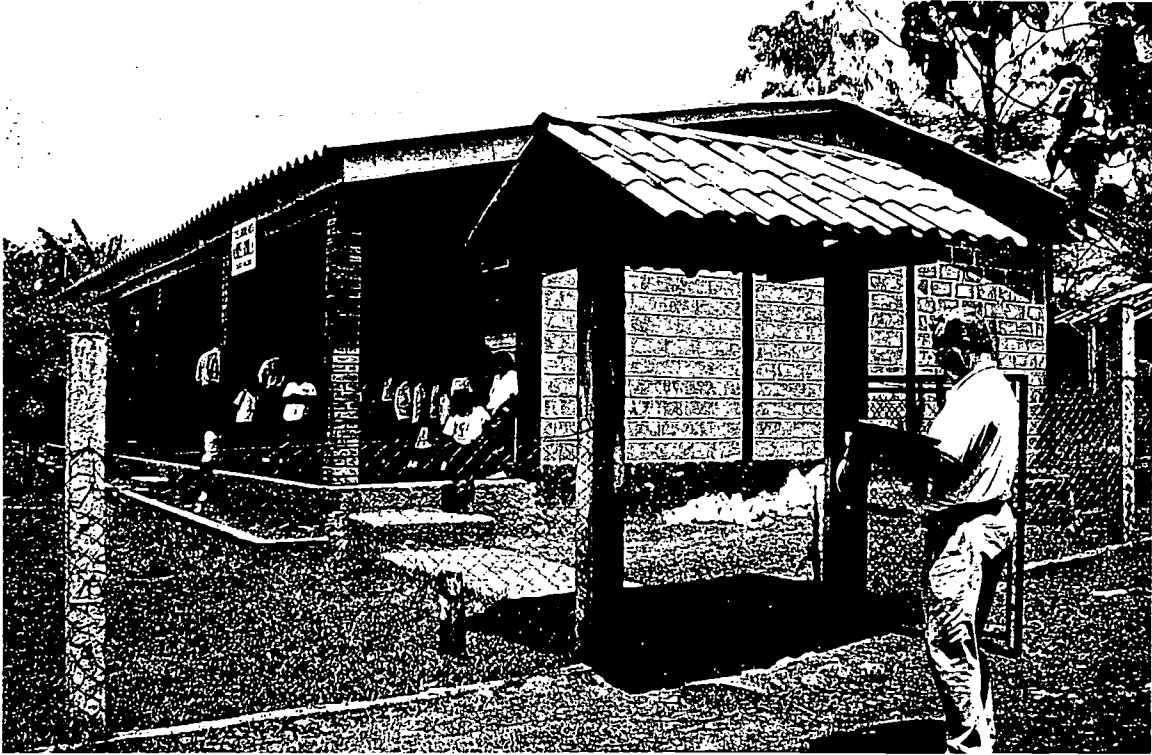

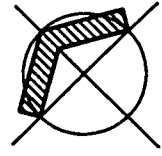
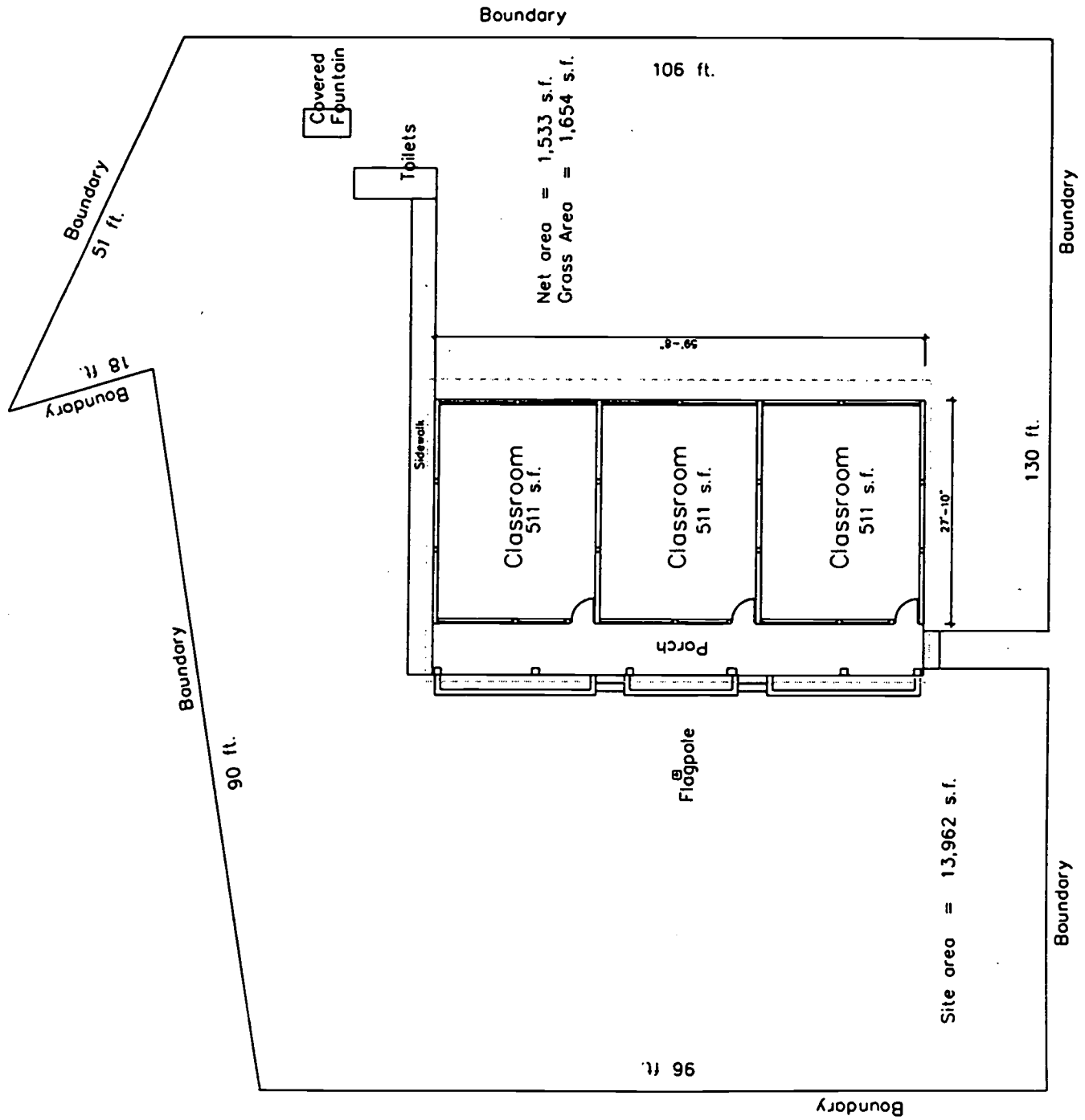

Casitas School

SCALE
0' 5' 10' 20'

BEST COPY AVAILABLE

Las Delicias Primary School

Community: Las Delicias

Date of Evaluation: April 15, 1997

Name of Evaluator: Ron McKnight

The director's name is Alejandro Gozmán. He is assisted by Mario Diaz and Donato Aviza. There are 111 students who attend the school. Average daily attendance is close to 98%; 108 students were in attendance on 4/15/97. The students come from Las Delicias and surrounding villages (including Canchias). Director Gozmán estimates the building could accommodate up to 200 students.

Students carry a full course load, i.e., they take the following classes at least two hours per week: mathematics, science, social studies, Spanish, penmanship, drawing, music, physical education, industrial arts. The teachers indicated that they thought the students should also be learn about the environment, and noted that the lack of teaching materials (basic student supplies, books, book shelves, etc.) was one of their biggest problems.

Other challenges facing the school include old and inadequate furniture and equipment, malnourished students and the open classroom building.

The open classroom is the school's largest classroom and was built with the help of the Mexican Embassy. The classroom was set up auditorium-style in preparation for our visit, so the typical arrangement of the classroom was not apparent. With the exception of some paper Honduran flags, the walls were bare. Director Gozmán indicated that the 2nd and 3rd graders shared one of the smaller classrooms, that the 4th and 5th graders were housed in the middle classroom, and that the 1st and 6th graders used the largest classroom. Ideally, each teacher would teach only one grade.

A group of about 12 parents (all male) were also at our meeting. The tension between the teachers and the parents, as well as the tension between the parents and the representatives from Heart to Honduras was apparent in the body language of the parents and the teachers.

BEST COPY AVAILABLE

School Profile

Grades Housed			1-6
Enrollment			
Grade	boys	girls	Total
1	8	13	21
2	14	13	27
3	7	10	17
4	9	12	21
5	7	7	14
6	6	5	11
TOTAL	51	60	111
Building Area			2,481 sq. ft.
Site Size			75,855 sq. ft.
Date of Construction			1981
Number of Classrooms			1 large, 2 small
Capacity			200
Type of Building Material			
Floor			concrete
Roof			wood truss, corrugated transite
Walls (exterior)			adobe with stucco
Walls (interior)			adobe with stucco
Ceiling			small: painted transite large: open

Las Delicias
1 (low) to 5 (high)

CHARACTERISTIC	Condition Rate 1-5	REMARKS
FACILITY - SITE:		
Condition	4	
Location	3	in boundary
Signage	2	painted on building
FACILITY - EXTERIOR:		
Walls	3	
Windows	3	wire mesh over openings, louvres on N and W; no windows
Roof	3	
Doors	4	
FACILITY - INTERIOR:		
Floors	3	exposed concrete
Walls	3	stucco
Ceilings	3	
Artificial Lighting	1	no artificial lighting
Doors	4	between classrooms
Storage	1	2 small cupboards, small kitchen bldg
Restrooms	4	outside
FACILITY - SYSTEMS:		
Electrical System	1	no electricity
Lighting - Natural	3	
Lighting - Artificial	1	
Plumbing System	2	outdoors only
FACILITY - FURNITURE:		
Furniture	3	in poor condition and crowded
Equipment	2	painted on walls
TOTAL	53	Possibility of 100

Recommendations

check one

<input type="checkbox"/>	Building is adequate
<input checked="" type="checkbox"/>	Building needs renovation
<input type="checkbox"/>	Building needs to be expanded
<input type="checkbox"/>	Building should be replaced

Comments:

The building needs a general upgrade and the deferred maintenance issues need to be addressed.

Facility Comments:

Site:

- Site is limited.
- Site is adequate.

- Limited outdoor play area.
- The outdoor play area is adequate.

- The landscaping, playground equipment, and fencing have been recently updated.
- The landscaping, playground equipment, and fencing are satisfactory. Soccer posts could be used as play equipment.

- Grounds need new landscaping, and fencing.
- Landscaping and fencing are adequate. The facility could use flowers and shrubs.

- There is no exterior signage for the school buildings and grounds.
- Exterior signage is adequate.

Facility - Exterior:

- Exterior walls need repair.
- Exterior walls are in good condition.

- No windows
- Windows have been recently replaced.
- Windows are in good condition.

- Roof has leaking problems that are beginning to cause interior and exterior damage.
- Roof has been recently repaired.
- Roof is in good condition.

- Exterior doors are in poor condition.
- Exterior doors have been recently replaced.
- Exterior doors are in good condition.

Facility - General:

Walls

- ✓ Walls need to be repaired and repainted.
- Walls are in good condition.

Lighting

- Lighting needs to be replaced.
- Lighting is adequate.
- ✓ There is no artificial lighting

Signage

- ✓ There is no signage for the building.
- Signage is adequate.

Painting

- ✓ Entire building should be painted.
- The building has been recently painted.

Storage

- There are limited storage and work areas.
- ✓ There are no designated storage and work areas.
- There are adequate storage and work areas.

Restrooms

- Restrooms are indoors.
- ✓ Restrooms are outdoors.

Plumbing

- There is no running water.
- ✓ There is running water outdoors. Faucet near front door on way to restrooms.
- There is indoor plumbing.

Facility - Educational Areas:

Furniture and Equipment

- ✓ All furniture and equipment are outdated and need to be replaced.
- Most furniture and equipment have been recently replaced.
- Most furniture and equipment are adequate.

Electrical

- There is no electricity
- There is electricity. There are ____ outlets available for educational use.
- There is phone service. There are ____ telephones available for educational use.
- There is no phone service.

Kitchen

- There is a kitchen but appears to be unused.
- There is no kitchen

Las Delicias Primary School



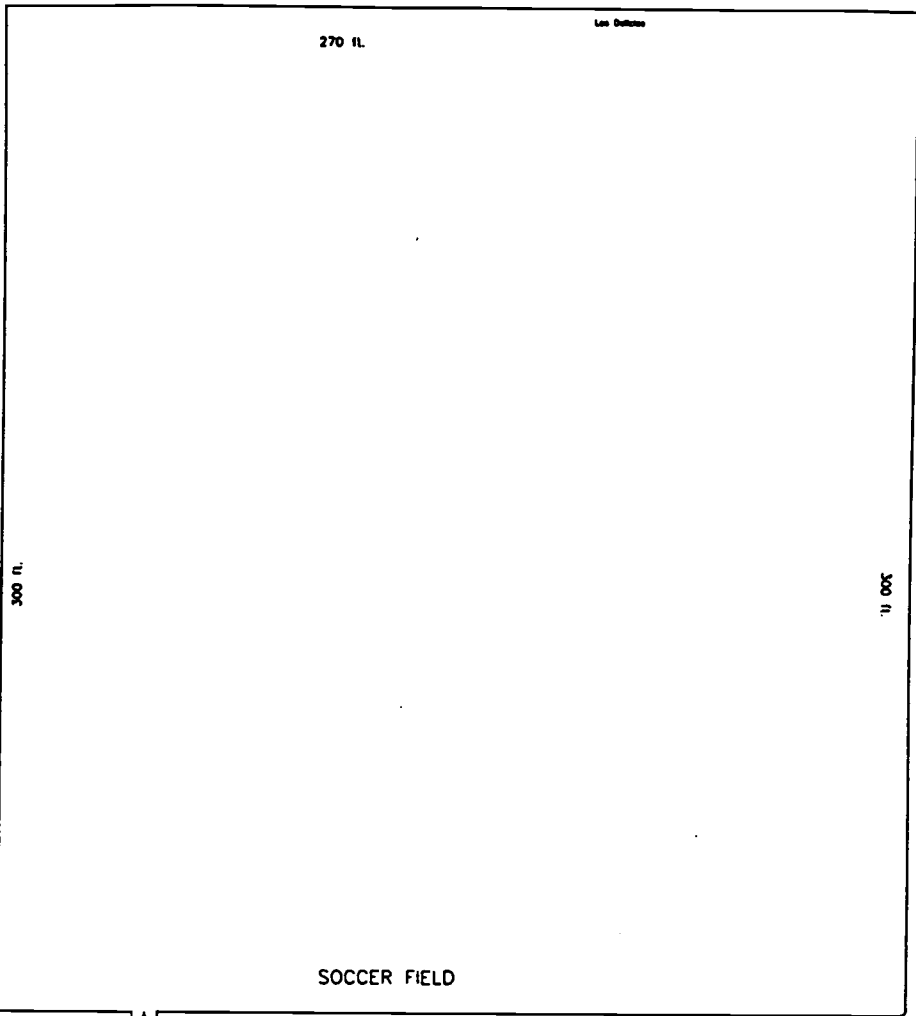

SOCCER FIELD

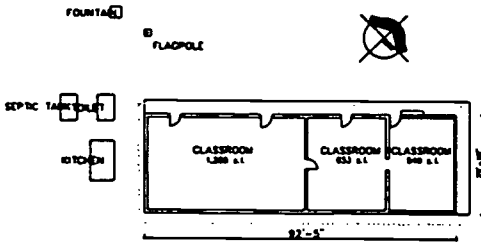
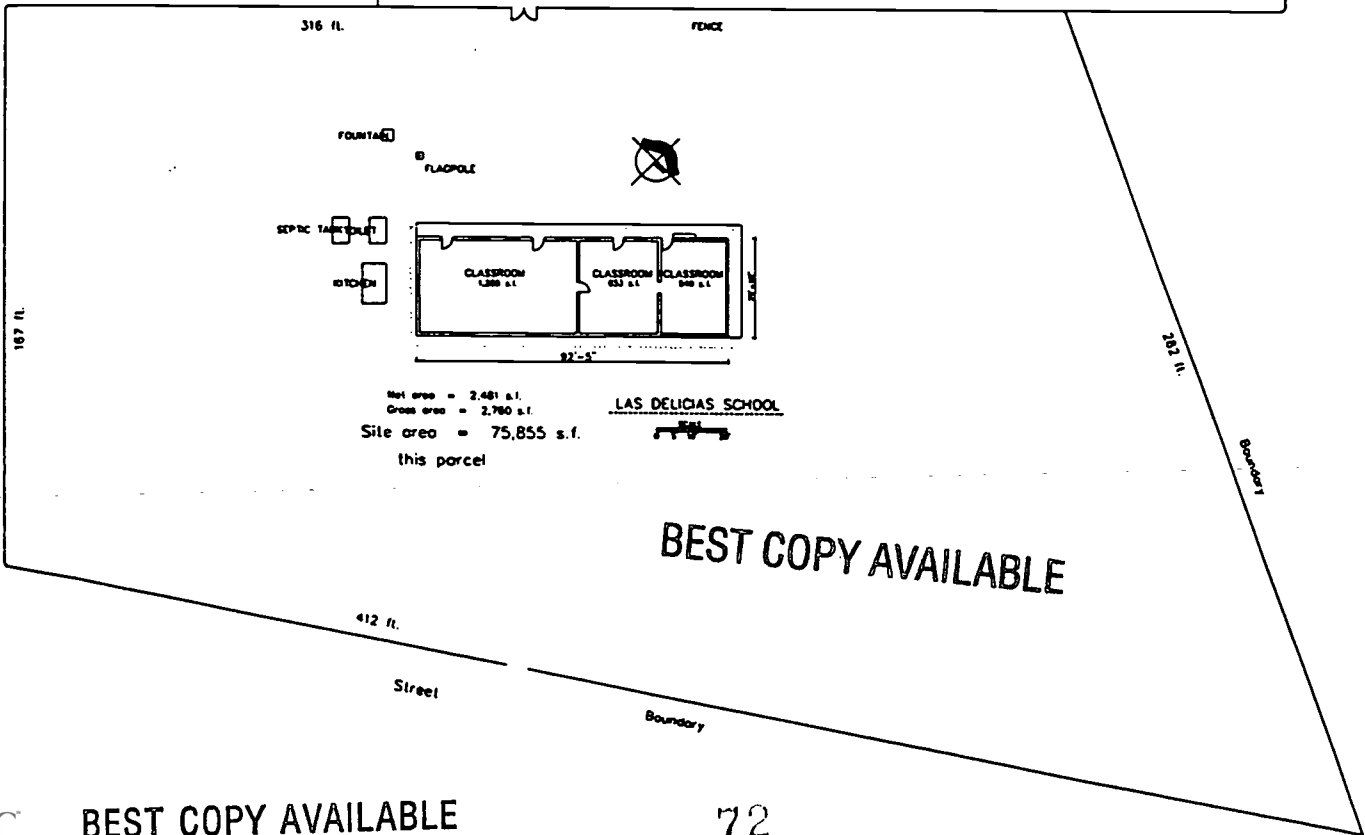

Net area = 2,481 s.f.
 Gross area = 2,760 s.f.
 Site area = 75,855 s.f.
 this parcel

LAS DELIGAS SCHOOL

BEST COPY AVAILABLE

316 ft.

FENCE

FOUNTAIN

FLAGPOLE

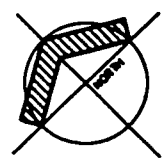

SEPTIC TANK TOILET

KITCHEN

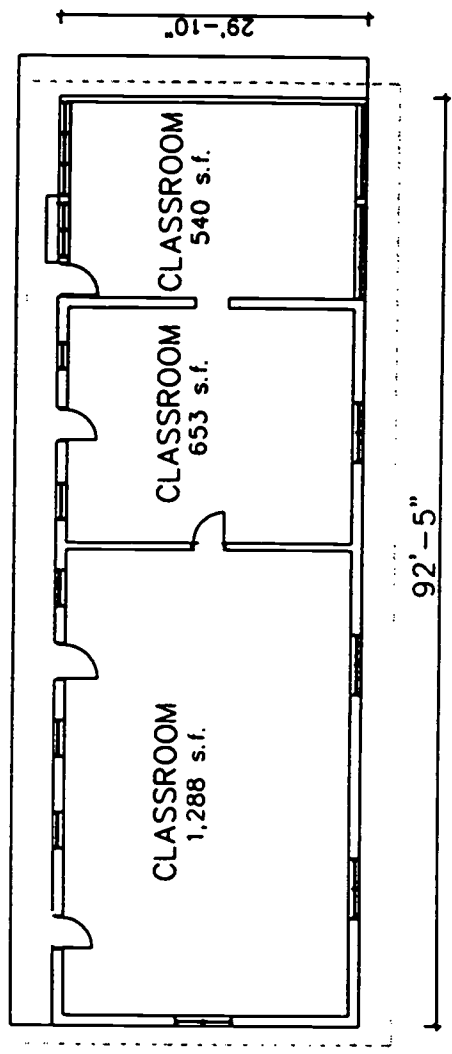

Net area = 2,481 s.f.

Gross area = 2,760 s.f.

Site area = 75,855 s.f.

LAS DELICIAS SCHOOL

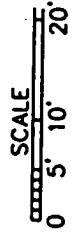

this parcel

La Victoria Primary School

La Victoria Primary School

Community: La Victoria

Date of Evaluation: April 16, 1997
Name of Evaluator: Ron McKnight

There were two teachers, one who started teaching last year and another who has been teaching for 18 years. Both seemed to be very well organized and to maintain a firm and positive relationship with their students.

103 students attend the school: 52 girls and 51 boys. Classes run from 8:00 a.m. to 11:30 a.m. and from 2:00 p.m. - 4:30 p.m. The school is more or less in the center of the attendance zone. The school has no electricity or running water. The teachers attribute the lack of running water to the lack of a fence; because there is no fence, they are concerned that animals and villagers would use and, in the case of the animals, pollute the water and area.

The school is set off approximately 100 yards from the main road. The school was built in 1992 after a hurricane tore off the roof of the old school. The building has three classrooms; one sits vacant for lack of a teacher. There is a very small (200 sq. ft.) Catholic Church annex on the site, which the teachers said was still used as the Catholic Church for the village.

The biggest challenges faced by the teachers are the poor nutrition of the students, insufficient classroom space and the lack of teaching materials, e.g., notebooks, pens, pencils, maps, text books, etc.

The Pentecostal Church runs a kindergarten nearby (16 students).

BEST COPY AVAILABLE

School Profile

Grades Housed		1-6	
Enrollment			
Grade	boys	girls	total
K	4	7	11
1	17	15	32
2	3	6	9
3	4	2	6
4	7	6	13
5	11	9	20
6	6	6	12
TOTAL	52	51	103
Building Area		1,395 sq. ft.	
Site Size		95,000 sq. ft.	
Date of Construction/Renovation		1992	
Number of Classrooms		3 (1 unused)	
Capacity		120	
Type of Building Material			
Floor		exposed concrete	
Roof		corrugated transite	
Walls (exterior)		adobe stucco	
Walls (interior)		painted adobe stucco	
Ceiling		open	

La Victoria Primary School

1 (low) to 5 (high)

CHARACTERISTIC	Condition Rate 1-5	REMARKS
FACILITY - SITE:		
Condition	3	large, grassy area but severe slopes and erosion
Location	5	in center of attendance area
Signage	1	no signage
FACILITY - EXTERIOR:		
Walls	4	front face: concrete block 2 way, open opening above back face: concrete block to 4' below eaves, opening above
Windows/Frames	3	horizontal bars and 1" mesh; no windows
Roof	4	steel channels and transite
Doors	3	
FACILITY - INTERIOR:		
Floors	3	exposed concrete
Walls	3	stucco
Ceilings	1	exposed deck
Artificial Lighting	1	no artificial lighting
Doors	2	
Storage	2	small cabinet
Restrooms	3	outside
FACILITY - SYSTEMS:		
Electrical System	1	no electricity
Lighting - Natural	4	
Lighting - Artificial	1	no artificial lighting
Plumbing System	1	no plumbing for lack of fence (unwanted use by animals and people)
FACILITY - FURNITURE:		
Furniture	3	
Equipment	2	chalkboards in poor condition
TOTAL	50	Possibility of 100

Recommendations	
<i>check one</i>	
<input type="checkbox"/>	Building is adequate
<input checked="" type="checkbox"/>	Building needs renovation
<input type="checkbox"/>	Building needs to be expanded
<input type="checkbox"/>	Building should be replaced
<p>Comments:</p> <p>Even though the building is quite new and in relatively good condition, it is rated quite low as a result of a lack of electricity, lighting, and running water.</p>	

Facility Comments:

Site:

- Site is limited by slope; the size is adequate.
- Site is adequate.

- Limited outdoor play area due to severe slope.
- The outdoor play area is adequate.

- The landscaping, playground equipment, and fencing have been recently updated.
- The landscaping, playground equipment, and fencing are satisfactory.

- Grounds need new landscaping, and fencing.
- Landscaping and fencing are adequate.

- There is no exterior signage for the school buildings and grounds.
- Exterior signage is adequate.

Facility - Exterior:

- Exterior walls need repair.
- Exterior walls are in good condition.

- No windows
- Windows have been recently replaced.
- Windows are in good condition.

- Roof has leaking problems that are beginning to cause interior and exterior damage.
- Roof has been recently repaired.
- Roof is in good condition.

- Exterior doors are in fair condition.
- Exterior doors have been recently replaced.
- Exterior doors are in poor condition.

Facility - General:

Walls

- ✓ Walls need to be repaired and repainted.
- Walls are in good condition.

Lighting

- Lighting needs to be replaced.
- Lighting is adequate.
- ✓ Lighting is inadequate.

Signage

- ✓ There is no signage for the building.
- Signage is adequate.

Painting

- ✓ Entire building should be painted.
- The building has been recently painted.

Storage

- There are limited storage and work areas.
- ✓ There are no storage and work areas.
- There are adequate storage and work areas.

Restrooms

- Restrooms are indoors.
- ✓ Restrooms are outdoors.

Plumbing

- ✓ There is no running water.
- There is running water outdoors.
- There is indoor plumbing.

Facility - Educational Areas:

Furniture and Equipment

- Most furniture and equipment are outdated and need to be replaced.
- Most furniture and equipment have been recently replaced.
- Most furniture and equipment are adequate.

Electrical

- There is no electricity
- There is electricity. There are ____ outlets available for educational use.
- There is phone service. There are ____ telephones available for educational use.
- There is no phone service.

Kitchen

- There is a kitchen
- There is no kitchen

Additional Comments:

The site is shared by a small Catholic Church annex. The play field consists of a large soccer field on a fairly steep grade.

La Victoria Primary School



Street

approx. 150 ft.

approx. 50 ft.

approx. 90 ft.

approx. 120 ft.

approx. 200 ft.

approx. 210 ft.

approx. 250 ft.

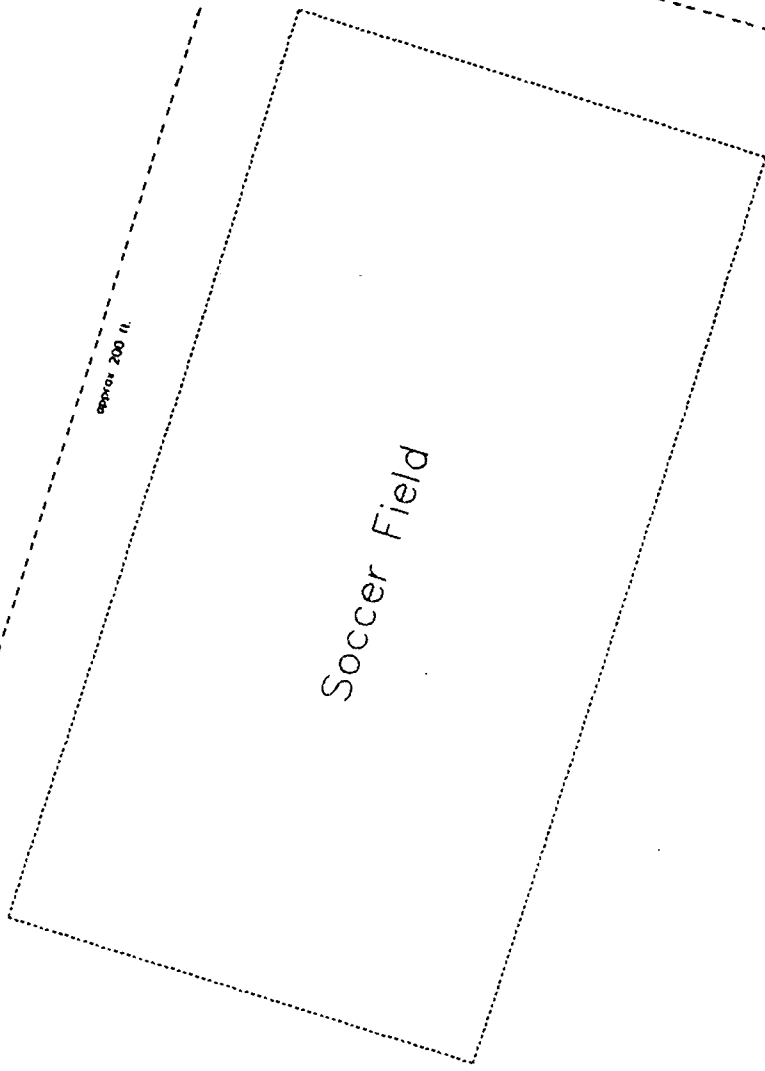

Soccer Field

BEST COPY AVAILABLE

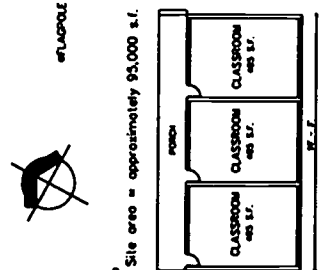

Site area = approximately 95,000 s.f.

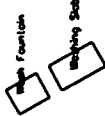

WINDMILL

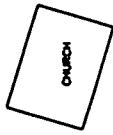

CHURCH

Lo Victoria School



TOILET

LA VICTORIA SCHOOL

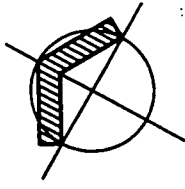
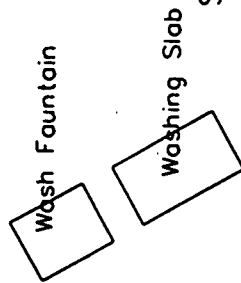

Site area = approximately 95,000 s.f.

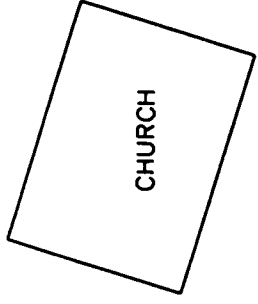
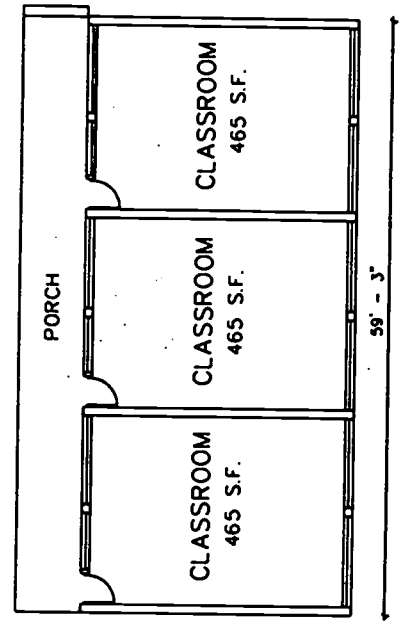

La Victoria School

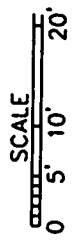

approx 250 ft.

Los Globos Primary School

Los Globos Primary School

Community: Los Globos

Date of Evaluation: April 15, 1997
Name of Evaluator: Jim Jennings

The following are some general notes regarding the school:

- ◆ The teacher was very well organized. His name is Gilberto Punchelo Nunez. He has been a teacher for 32 years and at this school for the past six years.
- ◆ There are 50 students enrolled. 49 were in attendance on the day of the visitation. 21 girls and 28 boys.
- ◆ When asked what should be in or at a school the following items were identified:
 - Restrooms/shower
 - Improved furniture
 - Pila
 - Audio visual materials
 - Decorative fencing
 - Cabinets
 - More teachers
 - Electricity
 - Garden Area
 - Need additional classroom space
- ◆ According to the teacher/students there were 12 students enrolled in the first grade and there were 10 additional children in the community that should be in the first grade that were not in school.
- ◆ The teacher indicated that he spent about 4 hours a day teaching the first and second grade students and the rest of the day is spent working with the remainder of the students.
- ◆ The school day runs from 8:00-11:30 am and 1:30-4:30 pm.
- ◆ Only three students expressed an interest in attending school after 6th grade.
- ◆ This building was one of the best maintained facilities visited. Obviously the teacher is very organized.
- ◆ Students expressed a great interest in having uniforms.
- ◆ The main reasons given for students not attending school were poverty, lack of clothing, not being able to afford notebooks, pencils, need to work, lack of food, etc.

School Profile

Grades Housed		1-6
Enrollment		
Grade	Number of Students Enrolled	
1	12	
2	12	
3	12	
4	6	
5	6	
6	5	
TOTAL	53	
Building Area		980 sq. ft.
Site Size		14,880 sq. ft.
Date of Construction/Renovation		1983 – newer classroom ???? – older building
Number of Classrooms		1
Capacity		40-50
Type of Building Material		
Floor	exposed concrete	
Roof	metal	
Walls (exterior)	brick	
Walls (interior)	plaster	
Ceiling	open - metal	

90

Los Globos Primary School

1 (low) to 5 (high)

CHARACTERISTIC	Condition Rate 1-5	REMARKS
FACILITY - SITE:		
Condition	4	limited size
Location	3	
Signage	1	
FACILITY - EXTERIOR:		
Walls	4	brick good
Windows/Frames	4	good - open bars not closed
Roof	4	metal
Doors	4	good
FACILITY - INTERIOR:		
Floors	3	exposed concrete
Walls	4	plaster
Ceilings	1	open ceiling
Lighting	1	natural lighting good, no electricity
Doors	3	1 wooden door
Storage	3	exterior building
Restrooms	2	exterior
FACILITY - SYSTEMS:		
Electrical System	1	no electricity
Lighting - Natural	4	good
Lighting - Artificial	1	no artificial light
Plumbing System	3	exterior but isolated
FACILITY - FURNITURE:		
Furniture	3	
Equipment	1	
TOTAL	54	Possibility of 100

Recommendations	
<i>check one</i>	
<input type="checkbox"/>	Building is adequate
<input type="checkbox"/>	Building needs renovation
<input checked="" type="checkbox"/>	Building needs to be expanded
<input type="checkbox"/>	Building should be replaced
<p><i>Comments:</i></p> <p>Very limited space for the number of students served.</p> <p>Note: Older building was not included in the evaluation. It is the old school and is currently used for storage. The school has one functional classroom.</p>	

Facility Comments:

Site:

- Site is limited.
- Site is adequate.

- Limited outdoor play area.
- The outdoor play area is adequate.

- The landscaping, playground equipment, and fencing have been recently updated.
- The landscaping, playground equipment, and fencing are satisfactory.
- Well-maintained yard; no play equipment or area.

- Grounds need new landscaping, and fencing.
- Landscaping and fencing are adequate.

- There is no exterior signage for the school buildings and grounds.
- Exterior signage is adequate.

Facility - Exterior:

- Exterior walls need repair.
- ✓ Exterior walls are in good condition.

- ✓ No windows; open
- Windows have been recently replaced.
- Windows are in good condition.

- Roof has leaking problems that are beginning to cause interior and exterior damage.
- Roof has been recently repaired.
- ✓ Roof is in good condition.

- Exterior doors are in poor condition.
- Exterior doors have been recently replaced.
- ✓ Exterior doors are in good condition.

Facility - General:

Walls

- Walls need to be repaired and repainted.
- ✓ Walls are in good condition.

Lighting

- Lighting needs to be replaced.
- Lighting is adequate.
- Lighting is inadequate.
- ✓ Good natural light.

Signage

- ✓ There is some signage painted on building.
- Signage is adequate.

Painting

- Entire building should be painted.
- ✓ The building has been recently painted.

Storage

- ✓ There are limited storage and work areas within the classroom.
- There are no storage and work areas.
- There are adequate storage and work areas.

Restrooms

- Restrooms are indoors.
- Restrooms are outdoors.

Plumbing

- There is no running water.
- There is running water outdoors.
- There is indoor plumbing.

Facility - Educational Areas:

Furniture and Equipment

- Most furniture and equipment are outdated and need to be replaced.
- Most furniture and equipment have been recently replaced.
- Most furniture and equipment are adequate.

Electrical

- There is no electricity
- There is electricity. There are ____ outlets available for educational use.
- There is phone service. There are ____ telephones available for educational use.
- There is no phone service.

Kitchen

- There is a kitchen
- There is no kitchen

Additional Comments:

The building is the same design as Montañuela and El Aguaje.

15' built-in bookcase
10' bookcase
26 2-student desks with bench
writing board across front

Condition average but needs space. Outside learning area is great.

Outdoor instructional area
Has old school building on site; now used for storage and teacher housing.

Los Globos Primary School



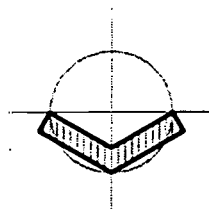
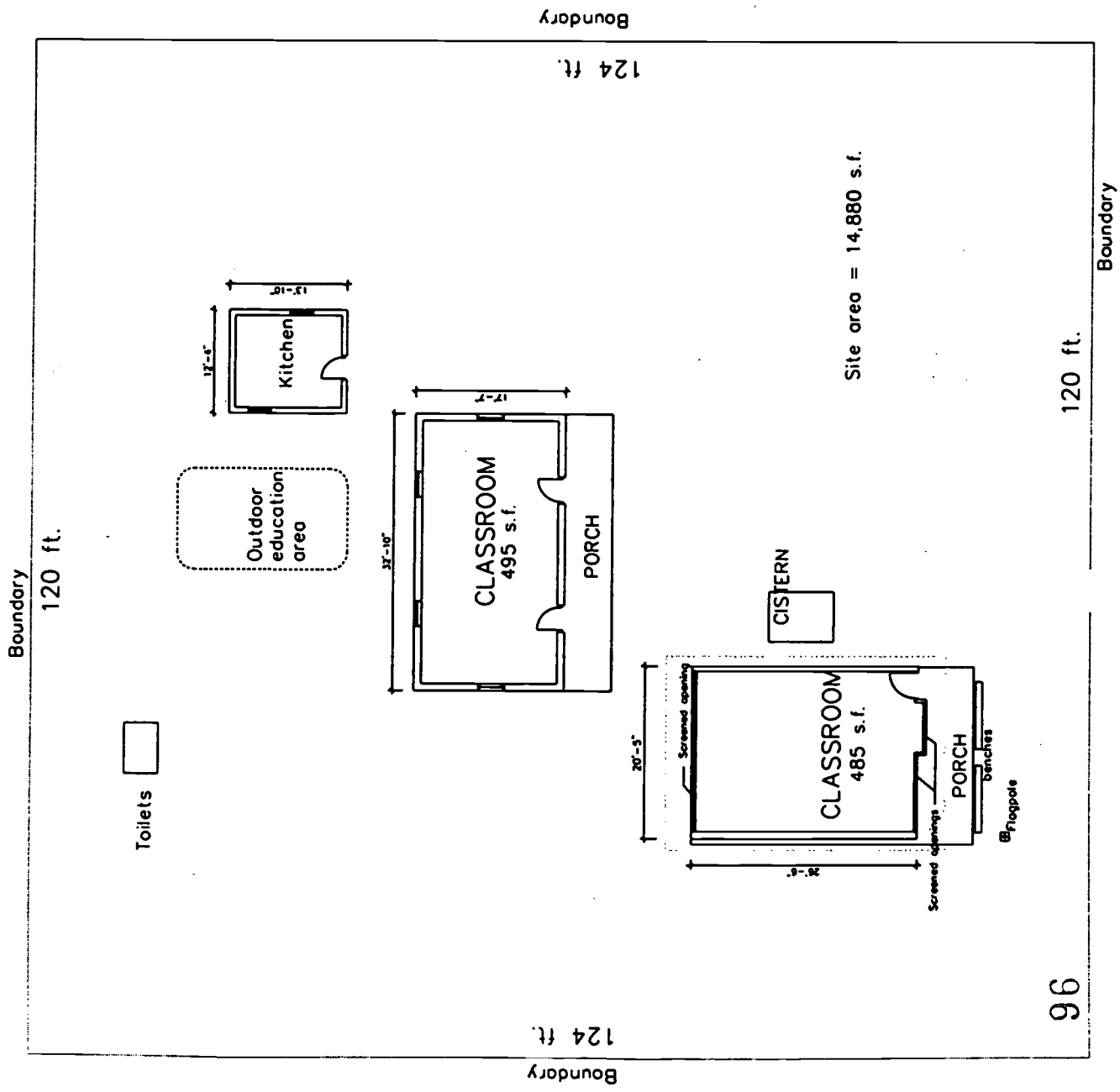

Los Globos School



Montañuela Primary School

Community: Montañuela

Date of Evaluation: April 15, 1997

Name of Evaluator: Jim Jennings

The following are some general notes regarding the school.

- ◆ The teacher has been at the school for four years. This was his first teaching assignment. Like most of the teachers, he had completed about three years of college at a teacher's college.
- ◆ This was also a very poor community. Only one student had indicated that they had ever been to San Pedro Sula..
- ◆ There are 33 students enrolled and 31 students were present. There were no 5th and 6th graders in the school.
- ◆ When asked why there were no 5th and 6th graders the teacher indicated that parents needed the kids to work, lack of clothing, not being able to afford the school supplies [notebook, pencils, pens]. Cost of a notebook is about 28 lempiras. Parents often send the younger children and once they get a little older, the older children need to help care for the younger children and work.
- ◆ The school receives classroom materials once per year from Meamber. The government gives the teacher material based on the number of children enrolled.
- ◆ Many of the kids want uniforms. The cost of uniforms is about 100 lempiras or \$8-9.
- ◆ The teacher indicated the supervisor visits about twice per year. The last time was in July and is expected to come some time in April.
- ◆ The teacher is paid 1,600 lempiras per month. I believe he indicated the maximum is 2,200 lempiras. He is given two days off each month to travel to one of the cities to pick up his pay check.
- ◆ The teacher indicated a need for teaching materials, [i.e. maps, books], also for another teacher because it was difficult teaching multiple grades.

School Profile

Grades Housed		1-6
Enrollment		
Grade	# enrolled	
1	19	
2	7	
3	4	
4	3	
5	0	
6	0	
TOTAL	33	
Building Area		485 sq. ft.
Site Size		24,025 sq. ft.
Date of Construction/Renovation		1983
Number of Classrooms		1
Capacity		40-50
Type of Building Material		
Floor	exposed concrete	
Roof	metal	
Walls (exterior)	painted brick	
Walls (interior)	plaster	
Ceiling	open - metal	

100

Montañuela Primary School

1 (low) to 5 (high)

CHARACTERISTIC	Condition Rate 1-5	REMARKS
FACILITY - SITE:		
Condition	3	
Location	3	
Signage	1	no signage
FACILITY - EXTERIOR:		
Walls	4	painted front
Windows/Frames	3	
Roof	3	
Doors	3	
FACILITY - INTERIOR:		
Floors	3	exposed concrete
Walls	2	need painting
Ceilings	1	open ceiling
Lighting	1	natural lighting only
Doors	2	poor condition
Storage	4	extra building w/ doors and bookshelves
Restrooms	3	outdoor
FACILITY - SYSTEMS:		
Electrical System	1	no electricity
Lighting - Natural	4	good
Lighting - Artificial	1	no artificial lighting
Plumbing System	1	
FACILITY - FURNITURE:		
Furniture	3	painted
Equipment	2	globe, scale, flip chart
TOTAL	48	Possibility of 100

Recommendations	
<i>check one</i>	
	Building is adequate
✓	Building needs renovation
✓	Building needs to be expanded
	Building should be replaced
<p><i>Comments:</i></p> <p>Even though this one room classroom was built in the early 1980s, it lacks adequate space and support facilities. The entire building consists of one 485 s.f. room.</p>	

Facility Comments:

Site:

- ✓ Site is limited.
- Site is adequate.

- ✓ Limited outdoor play area.
- The outdoor play area is adequate.

- The landscaping, playground equipment, and fencing have been recently updated.
- The landscaping, playground equipment, and fencing are satisfactory.
- ✓ There is limited play area and no play equipment

- ✓ Grounds need new landscaping.
- Landscaping and fencing are adequate.

- ✓ There is no exterior signage for the school buildings and grounds.
- Exterior signage is adequate.

102

Facility - Exterior:

- Exterior walls need painting.
- Exterior walls are in good condition.

- No windows
- Windows have been recently replaced.
- Windows are in good condition.

- Roof has leaking problems that are beginning to cause interior and exterior damage.
- Roof has been recently repaired.
- Roof is in good condition.

- Exterior doors are in poor condition and need painting.
- Exterior doors have been recently replaced.
- Exterior doors are in good condition.

Facility - General:

Walls

- Walls need to be repaired and repainted.
- Walls are in good condition.

Lighting

- Lighting needs to be replaced.
- Lighting is adequate.
- Lighting is inadequate.
- Good natural light.

Signage

- There is some signage for the building.
- Signage is adequate.

Painting

- Entire building should be painted.
- The building has been recently painted.

Storage

- ✓ There are limited storage and work areas.
- There are no storage and work areas.
- There are adequate storage and work areas.

Restrooms

- Restrooms are indoors.
- ✓ Restrooms are outdoors.

Plumbing

- There is no running water.
- ✓ There is running water outdoors.
- There is indoor plumbing.

Facility - Educational Areas:

Furniture and Equipment

- ✓ Most furniture and equipment are outdated.
- Most furniture and equipment have been recently replaced.
- Most furniture and equipment are adequate.

Electrical

- ✓ There is no electricity
- There is electricity. There are ____ outlets available for educational use.
- ✓ There is phone service. There are ____ telephones available for educational use.
- There is no phone service.

Kitchen

- There is a kitchen.
- ✓ There is no kitchen.

Additional Comments:

This school building has the same design as the school buildings in Los Globos and El Aguaje.

The building needs some interior painting and additional space. There are currently 232-student tables and 4 in storage. In the front of the room, there is an 8' section of writing board. There is also a table with supplies.

Montañuela Primary School



Boundary

170'-5"

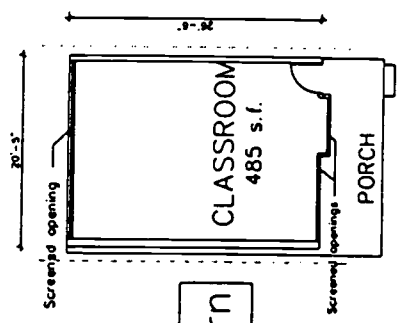
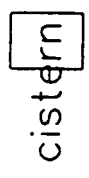

Hydrant

Floppage

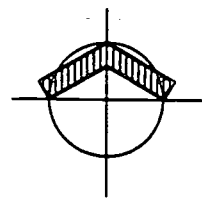

Boundary
150 ft.

Site area = 24,025 s.f.

MONTANUELA SCHOOL



150'-0"

Boundary

San Isidro Primary Christian School

San Isidro Primary Christian School

Community: San Isidro

Date of Evaluation: April 16, 1997

Name of Evaluator: Jim Jennings

There are two buildings on the site; one is a house which was converted into a classroom in 1993, the other is a typical classroom building which was constructed in 1991.

There are 37 students in the first grade, 18 in the second grade, and 21 in the third grade.

The school operates on a split shift: the entire first and second grades go to school in the morning; in the afternoon, the 2nd grade teacher teaches the entire 3rd grade and the 1st grade teacher offers remedial classes to 10 students from her morning classes. The morning classes run from 7:00 a.m. to 12:30 p.m. The afternoon classes run from 1:00 p.m. to 5:30 p.m.

BEST COPY AVAILABLE

School Profile

Grades Housed		1-3
Enrollment		
Grade	# attending	Comments
1st grade	37	a.m. only, 10 students in p.m. remedial program
2nd grade	18	a.m. only
3rd grade	21	p.m. only
TOTAL	76	
Building Area		838 sq. ft.
Site Size		15,866 sq. ft.
Date of Construction/ Renovation		A: 1993; B: 1991
Number of Classrooms		2
Capacity		A: 30; B: 35
Type of Building Material		
Floor	A, B: concrete	
Roof	A: tile; B: corrugated tin	
Walls (exterior)	A: wood, batton; B: stucco, brick	
Walls (interior)	A: wood; B: stucco	
Ceiling	open	

110

San Isidro Primary Christian School

1 (low) to 5 (high)

CHARACTERISTIC	Condition Rate 1-5	REMARKS
FACILITY - SITE:		
Condition	2	very small
Location	2	very close to road
Signage	1	
FACILITY - EXTERIOR:		
Walls	A: 2; B: 3	A: vertical wood siding; B: stucco
Windows/Frames	A: 2; B: 3	A: Two 2x2 wooden framed windows B: permanent opening w/ mesh on N mesh on open block on S
Roof	3	A: tile; B: tin
Doors	A: 2; B: 3	A: unsecured concrete blocks as steps B: pile of loose rocks at top of stairs leading to class room
FACILITY - INTERIOR:		
Floors	3	A, B: exposed concrete
Walls	A: 2; B: 3	A: painted wood; B: white plaster
Ceilings	1	open
Lighting	A: 1; B:3	A: one incandescent, 1 tube florescent B: 2 florescent, good natural light
Doors	3	A: 2 doors; B: 1door
Storage	2	A: using beams to store some maintenance items, B: none
Restrooms	3	2 flush toilets
FACILITY - SYSTEMS:		
Electrical System	4	A: electric panel, 2 duplex outlets
Lighting - Natural	A: 1; B:4	A: 2 small windows, 2 doors B: large open space at top of N, S walls
Lighting - Artificial	A: 2; B:3	A: one incandescent, one florescent B: Two, 2-tube florescent
Plumbing System	3	2 flush toilets
FACILITY - FURNITURE:		
Furniture	3	
Equipment	3	B: refrigerator to store supplemental food for students (i.e., bananas)
TOTAL	A: 43; B:53	Possibility of 100

Recommendations	
<i>check one</i>	
<input type="checkbox"/>	Building is adequate
<input type="checkbox"/>	Building needs renovation
<input checked="" type="checkbox"/>	Building needs to be expanded
<input checked="" type="checkbox"/>	Building should be replaced
<p><i>Comments:</i></p> <p>Building A should be replaced. The entire school should be expanded to eliminate the split shift and to accommodate students in grades 4-6.</p>	

Facility Comments:

Site:

- Site is limited.
- Site is adequate.

- Limited outdoor play area.
- The outdoor play area is adequate.
- There is no play area on school site (children travel down the street for physical education at a community field)

- The landscaping, playground equipment, and fencing have been recently updated.
- The landscaping, playground equipment, and fencing are satisfactory.
- There is no landscaping.

- Grounds need new landscaping, and fencing.
- Landscaping and fencing are adequate.
- New fencing and a new gate are being installed.

- There is no exterior signage for the school buildings and grounds.
- Exterior signage is adequate.

Facility - Exterior:

- Exterior walls need paint.
- Exterior walls are in good condition.

- No windows
- Windows have been recently replaced.
- Windows are in good condition, but are too small in Building A.

- Roof has leaking problems that are beginning to cause interior and exterior damage.
- Roof has been recently repaired.
- Roof is in adequate condition.

- Exterior doors are in poor condition.
- Exterior doors have been recently replaced.
- Exterior doors are in satisfactory condition.

Facility - General:

Walls

- Walls need to be repainted.
- Walls are in good condition.

Lighting

- Lighting needs to be replaced.
- Lighting is adequate.
- Lighting is inadequate.

Signage

- There is no signage for the building.
- Signage is adequate.

Painting

- Entire building should be painted.
- The building has been recently painted.

Storage

- There are limited storage and work areas.
- There are no storage and work areas.
- There are adequate storage and work areas.

Restrooms

- Restrooms are indoors.
- Restrooms are outdoors.
- Restrooms are attached to Building B with exterior access

Plumbing

- There is no running water.
- There is running water outdoors.
- There is indoor plumbing.

Facility - Educational Areas:

Furniture and Equipment

- Most furniture and equipment are outdated.
- Most furniture and equipment have been recently replaced.
- Most furniture and equipment are adequate.

Electrical

- There is no electricity
- There is electricity. There are 2 outlets available for educational use.

- There is phone service. There are ____ telephones available for educational use.
- There is no phone service.

Kitchen

- There is a kitchen
- There is no kitchen

Additional Comments:

Building A is a former house that was on the site; it was renovated in 1993 and now serves as the 2nd and 3rd grade classroom. Building B is a typical classroom building.

Access to Building B is down some concrete stairs, at the top of which is a pile of rocks which seem to have been placed there intentionally. Access is hindered by the pile.

San Isidro Primary Christian School

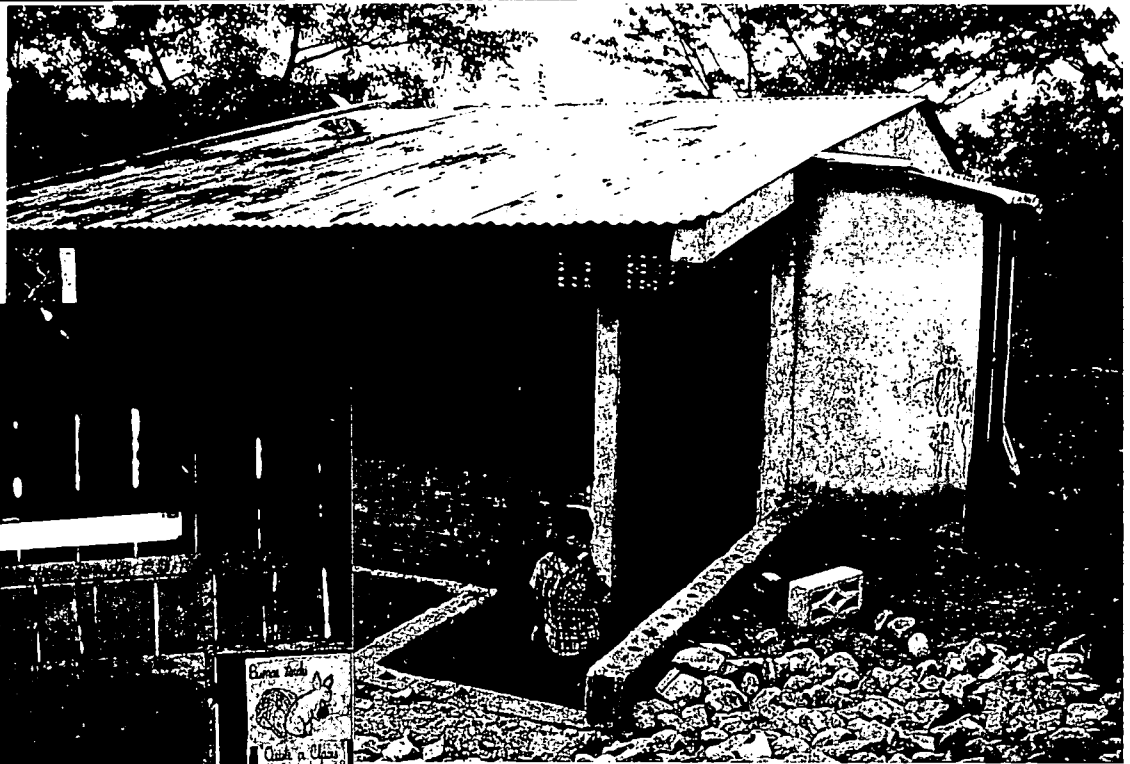

GARDEN

51 ft.

SAN ISIDRO CHRISTIAN SCHOOL

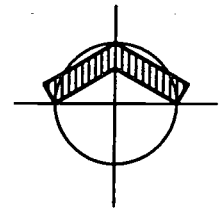
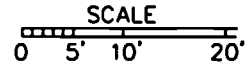

Boundary

180 ft.

195 ft.

Boundary



Site area = 15,866 s.f.

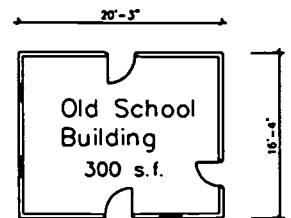
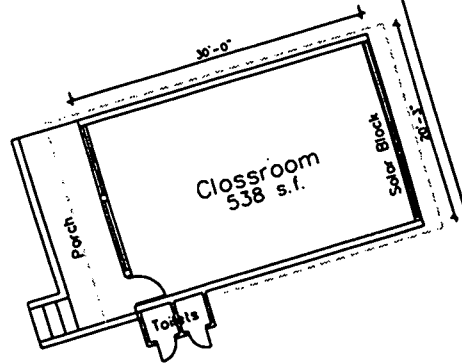

103 ft.

Boundary

Street 117

San Isidro Primary School

Community: San Isidro

Date of Evaluation: April 16, 1997

Name of Evaluator: Ron McKnight

The biggest challenges facing the school are students' lack of nutrition and children not coming to school. Poverty here is comparable to poverty in villages, but some villages fare better because of support from outside agencies.

School Profile

Grades Housed			1-6	
Enrollment				
Grade	boys	girls	total	
K	?	?	30	pm only
1	15	15	30	
2	22	10	32	
3	9	19	28	
4	14	15	29	
5	7	15	22	
6	10	15	25	
total	77?	89?	196	
Building Area			sq. ft.	
Site Size			acres	
Date of Construction/Renovation			1957, multiple dates for renovation	
Number of Classrooms			6 (2 unused)	
Capacity			250 students	
Type of Building Material				
Floor			exposed concrete	
Roof			corrugated transite	
Walls (exterior)			adobe stucco, unpainted exposed concrete block	
Walls (interior)			"	
Ceiling			painted transite	

San Isidro Primary School

1 (low) to 5 (high)

CHARACTERISTIC	Condition Rate 1-5	REMARKS
FACILITY - SITE:		
Condition	4	paved basketball court
Location	4	centrally located in attendance area
Signage	4	
FACILITY - EXTERIOR:		
Walls	3	
Windows/Frames	3	1/4" mesh, exposed frames and horizontal bars
Roof	2	
Doors	3	
FACILITY - INTERIOR:		
Floors	2	exposed concrete floor chipped and dusting
Walls	3	stucco (dark green)
Ceilings	2	
Lighting	2	single, incandescent socket (no lamp)
Doors	3	
Storage	1	
Restrooms	4	
FACILITY - SYSTEMS:		
Electrical System	2	limited
Lighting - Natural	3	
Lighting - Artificial	2	
Plumbing System	4	
FACILITY - FURNITURE:		
Furniture	3	
Equipment	1	no cabinets in some classrooms
TOTAL	55	Possibility of 100

Recommendations

check one

<input type="checkbox"/>	Building is adequate
<input checked="" type="checkbox"/>	Building needs renovation
<input type="checkbox"/>	Building needs to be expanded
<input type="checkbox"/>	Building should be replaced

Comments:

Building is adequate. Since this school was built in various stages, it is in various conditions. Even though there is electricity, there are very few lights or outlets and no audiovisual equipment.

Facility Comments:

Site:

- Site is limited.
- Site is adequate.

- Limited outdoor play area.
- The outdoor play area is adequate.

- The landscaping, playground equipment, and fencing have been recently updated.
- The landscaping, playground equipment, and fencing are satisfactory.

- Grounds need new landscaping, and fencing.
- Landscaping and fencing are adequate.

- There is no exterior signage for the school buildings and grounds.
- Exterior signage is adequate.

Facility - Exterior:

- Exterior walls need repair.
- Exterior walls are in good condition.

- No windows
- Windows have been recently replaced.
- Windows are in good condition.

- Roof has leaking problems in places that are beginning to cause interior and exterior damage.
- Roof has been recently repaired.
- Roof is in good condition.

- Exterior doors are in poor condition.
- Exterior doors have been recently replaced.
- Exterior doors are in good condition.

Facility - General:

Walls

- Walls need to be repaired and repainted.
- Walls are in good condition.

Lighting

- Lighting needs to be replaced.
- Lighting is adequate.
- Lighting is inadequate.

Signage

- There is no signage for the building.
- Signage is adequate.

Painting

- Entire building should be painted.
- The building has been recently painted.

Storage

- There are limited storage and work areas.
- There are no storage and work areas.
- There are adequate storage and work areas.

Restrooms

- Restrooms are indoors.
- Restrooms are in a separate building. There are 3 waterclosets and 2 lavatories for boys and the same for girls

Plumbing

- There is no running water.
- There is running water outdoors.
- There is indoor plumbing.

Facility - Educational Areas:

Furniture and Equipment

- Most furniture and equipment are outdated and need to be replaced.
- Most furniture and equipment have been recently replaced.
- Most furniture and equipment are adequate.

Electrical

- There is no electricity
- There is electricity. There are no outlets available for educational use.

- There is phone service. There are ___ telephones available for educational use.
- There is no phone service.

Kitchen

- There is a kitchen
- There is no functional kitchen. Although there is space, it is unused and unequipped.

Additional Comments:

San Isidro Primary School



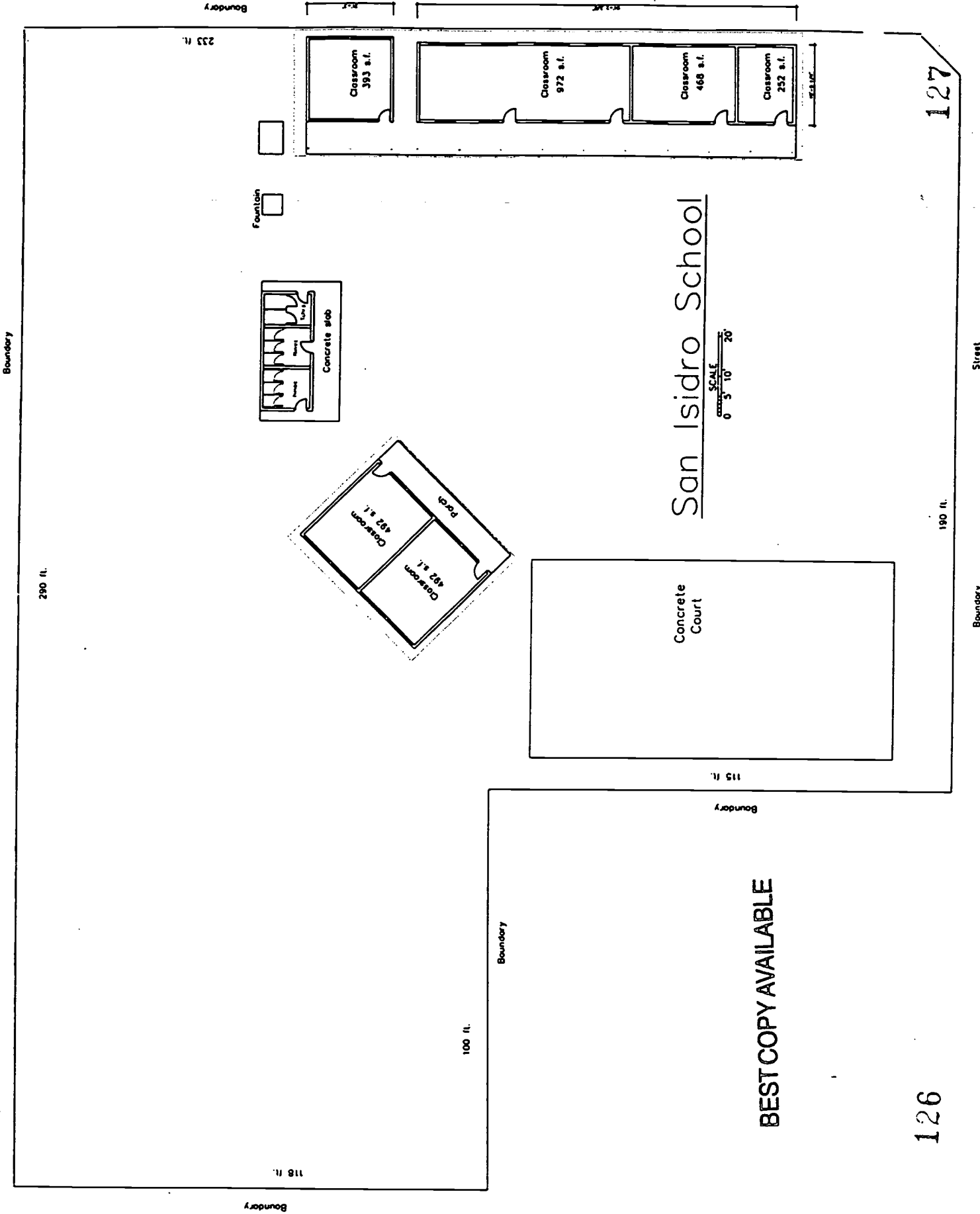

BEST COPY AVAILABLE

233 ft.

Boundary

Fountain

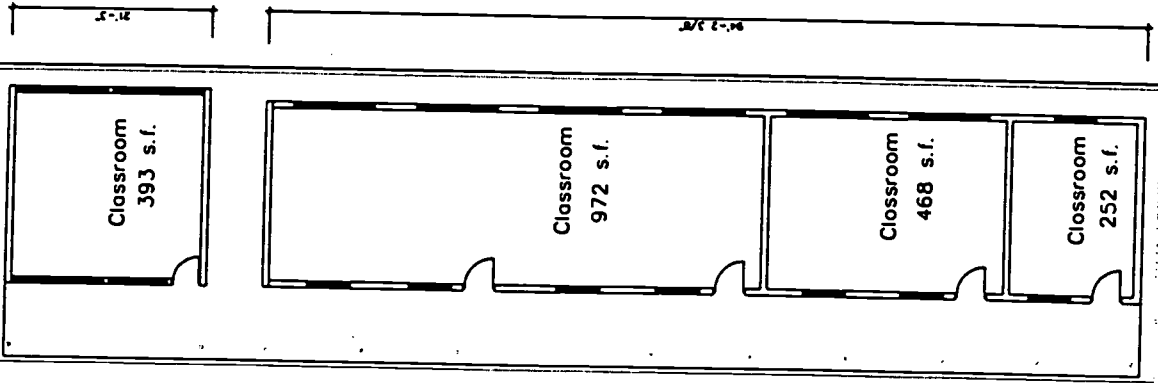
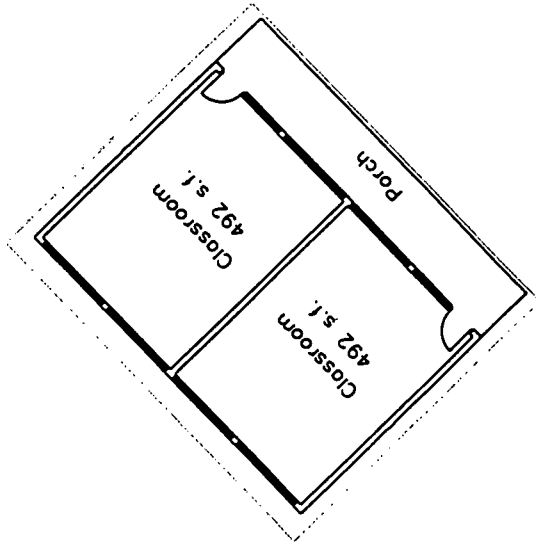
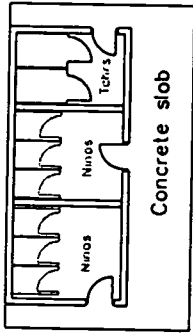

San Isidro School

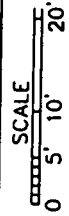

Concrete Court

Street

129

128



U.S. Department of Education
Office of Educational Research and Improvement (OERI)
National Library of Education (NLE)
Educational Resources Information Center (ERIC)



NOTICE

REPRODUCTION BASIS



This document is covered by a signed “Reproduction Release (Blanket) form (on file within the ERIC system), encompassing all or classes of documents from its source organization and, therefore, does not require a “Specific Document” Release form.



This document is Federally-funded, or carries its own permission to reproduce, or is otherwise in the public domain and, therefore, may be reproduced by ERIC without a signed Reproduction Release form (either “Specific Document” or “Blanket”).